



ENGINEERING
ARCHITECTURE
FIELD SERVICES

**TOWN OF ROWLESBURG
PRESTON COUNTY, WEST VIRGINIA**

CRITICAL NEEDS SANITARY SEWER SYSTEM UPGRADES

ADDENDUM #2

JUNE 24, 2022

THRASHER PROJECT #020-10136

TO WHOM IT MAY CONCERN:

A Non-Mandatory Pre-Bid Conference was held on Tuesday, June 14, 2022, at 2:00 P.M. on the above-referenced project. This Addendum addresses clarifications on pipe type and sizes.

Attention is directed to the fact that while information provided in this Addendum may reference specific locations in the plans and specifications, the information provided shall be applied to all applicable locations in the plans and specifications.

Please acknowledge receipt of all Addenda in the Bid Opening Requirements and in the Bid Form.

A. DRAWINGS

1. Detail Sheet: DET-5
2. Plan Sheet: Plan Sheet 3

B. CLARIFICATIONS

1. All piping in the Valve Vault shall be 4". See updated table on Sheet DET-5. The label on the reducer has been revised as "REDUCER (M.J.) AS NECESSARY". A reducer is not necessary for this project.
2. Gravity sewer pipe shall be 6" PVC SDR-35 on Coniff Street as shown on updated SHT-3

If you have any questions or comments, please feel free to contact me at your earliest convenience. As a reminder, bids will be received until 2:00 p.m. on Thursday, June 30, 2022, at 82 Poplar Street, Rowlesburg, Preston County, WV 26425. Thank you for your interest in the project.

Sincerely,

THE THRASHER GROUP, INC.

DANIEL E. FERRELL, P.E.
Principal

Enclosures: Plan Sheets

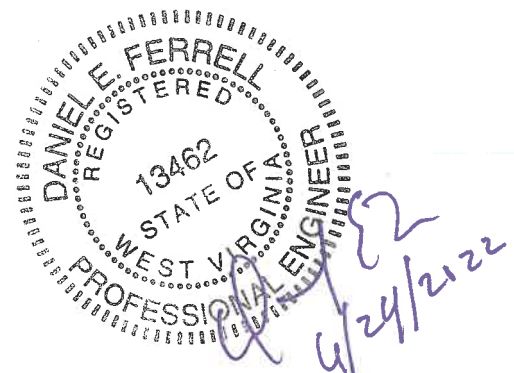

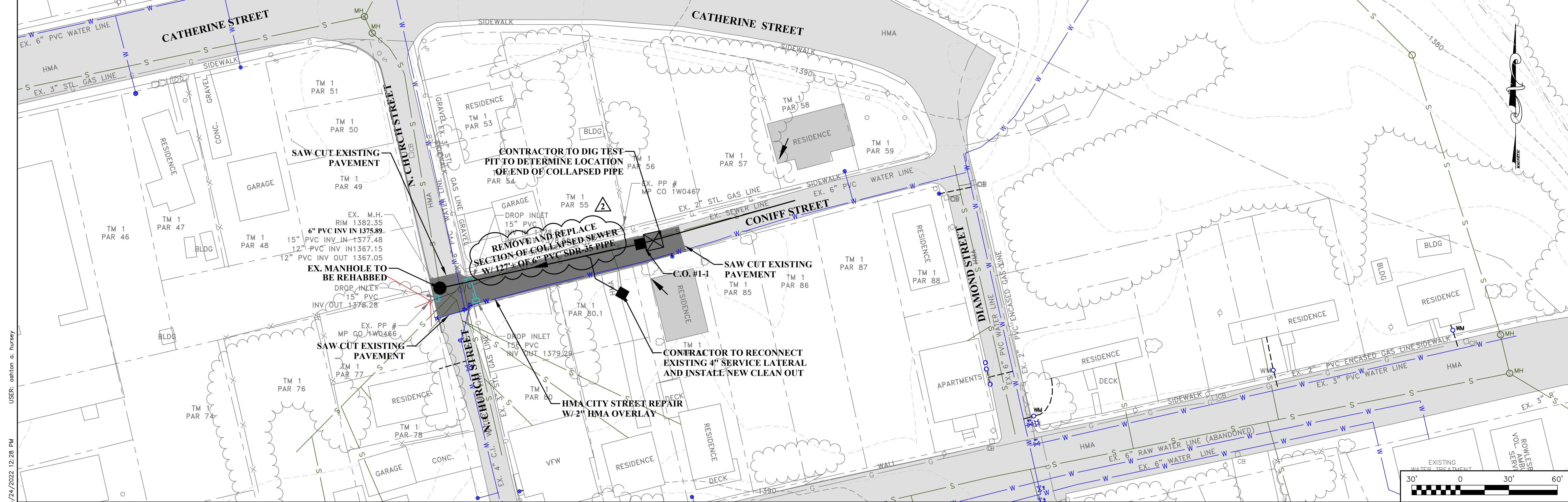

LAYOUT TAB: Layout1
 CAD FILE: R:\020\020-10136-00-Town Of Rowlesburg (WV) - Critical Needs-Town Of Rowlesburg-Drawing\003-sheet-03.dwg
 USER: ashton a. hursley
 PLOT DATE/TIME: 6/24/2022 12:28 PM

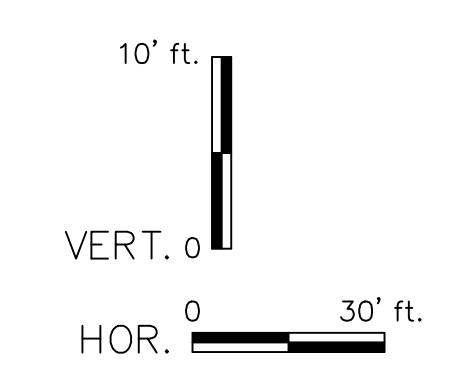
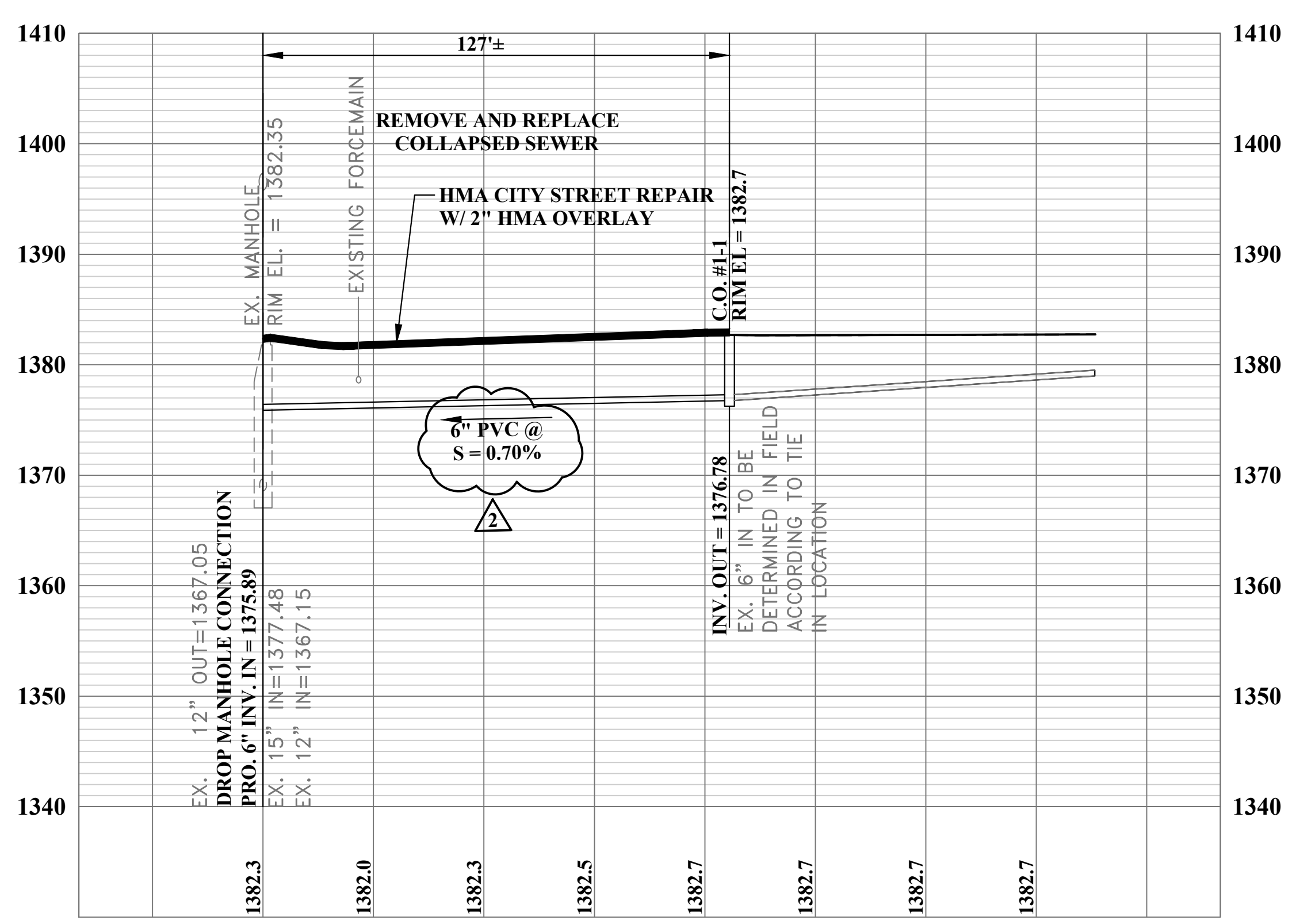

NO.	BY	DATE	DESCRIPTION
2	CT	6/24	UPDATED PIPE TYPE



SCALE: AS NOTED	
DRAWN: P. LANTZ	DATE: 12-21
CHECKED:	DATE:
APPROVED:	DATE:
SURVEY DATE:	
SURVEY BY:	
FIELD BOOK No.:	

THRASHER

600 WHITE OAKS BLVD. P.O. BOX 940
BRIDGEPORT WV, 26330
www.thrashereng.com

PHONE (304) 624-4108 FAX (304) 624-7831

PHASE No.	
CONTRACT No.	
PROJECT No.	020-10136

TOWN OF ROWLESBURG
CRITICAL NEEDS SANITARY
SEWER UPGRADES
PRESTON COUNTY, WEST VIRGINIA
PLAN AND PROFILE

SHEET No.
3

LAYOUT TAB: 05
 CAD FILE: R:\020\020-10136-00-Town Of Rowlesburg (WV) - Critical Needs-Town Of Rowlesburg - Drawing Not Used\006-TYP SEWER DETAILS 2.dwg
 PLOT DATE/TIME: 6/24/2022 12:20 PM
 USER: ashlon a. hursley

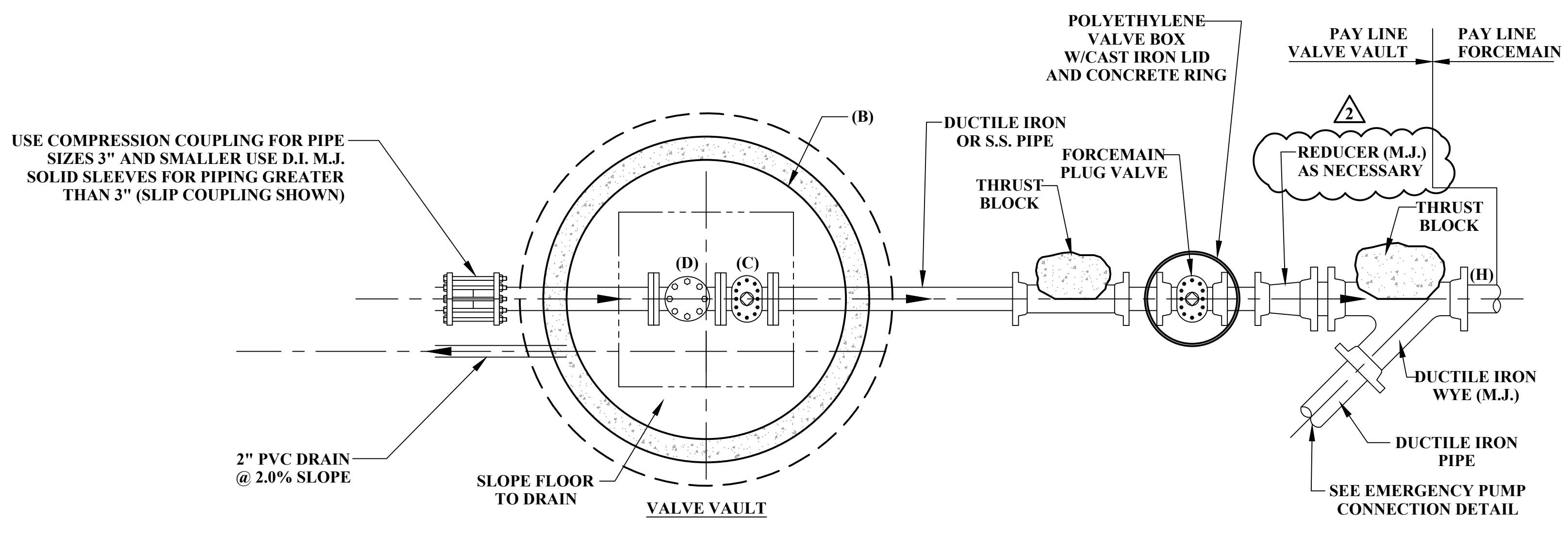

(A) DIMENSION	1'-0"
(B) VALVE VAULT DIAMETER	5'-0"
(D) DIMENSION	18"
(C) PLUG OR BALL VALVE	4"
(D) CHECK VALVE	4"
(E) 45° BEND	4"
(F) DIMENSION	4"
(G) LATERAL WYE	4"
(H) DISCHARGE PIPING	4"
(I) DIMENSION	30" X 48"
(J) DIMENSION	1'-6"
(K) DIMENSION	3'-6"
FORCE MAIN PLUG VALVE	4"

NOTE: CONTRACTOR TO INSTALL THRUST BLOCKS AT ALL BENDS SHOWN OR ANY BENDS OR FITTINGS OTHERWISE CONSTRUCTED SEE SITE PLANS AND FORCE MAIN DRAWINGS WHERE APPLICABLE.

PLAN VIEW

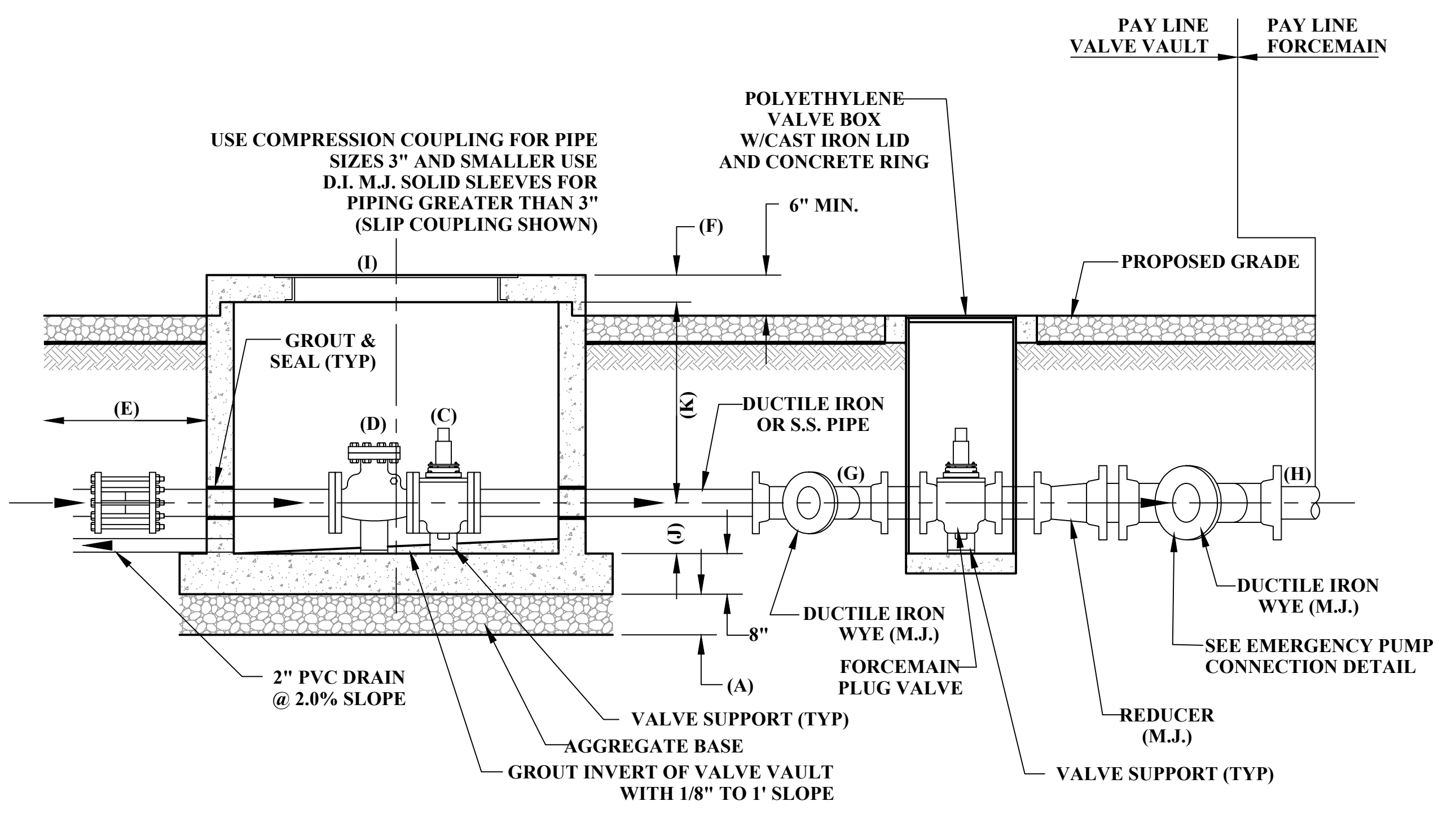

NOTE:
 1. CONTRACTOR SHALL PROVIDE MATCHED PAD LOCKS FOR WET WELL ACCESS. ALL PIPING TO BE DUCTILE IRON OR STAINLESS STEEL
 2. ALL PRECAST AND MONOLITHIC CONCRETE CASTINGS SHALL CONFORM TO C478/AASHTO M199 SPECIFICATION FOR REINFORCEMENT.

SECTION VIEW

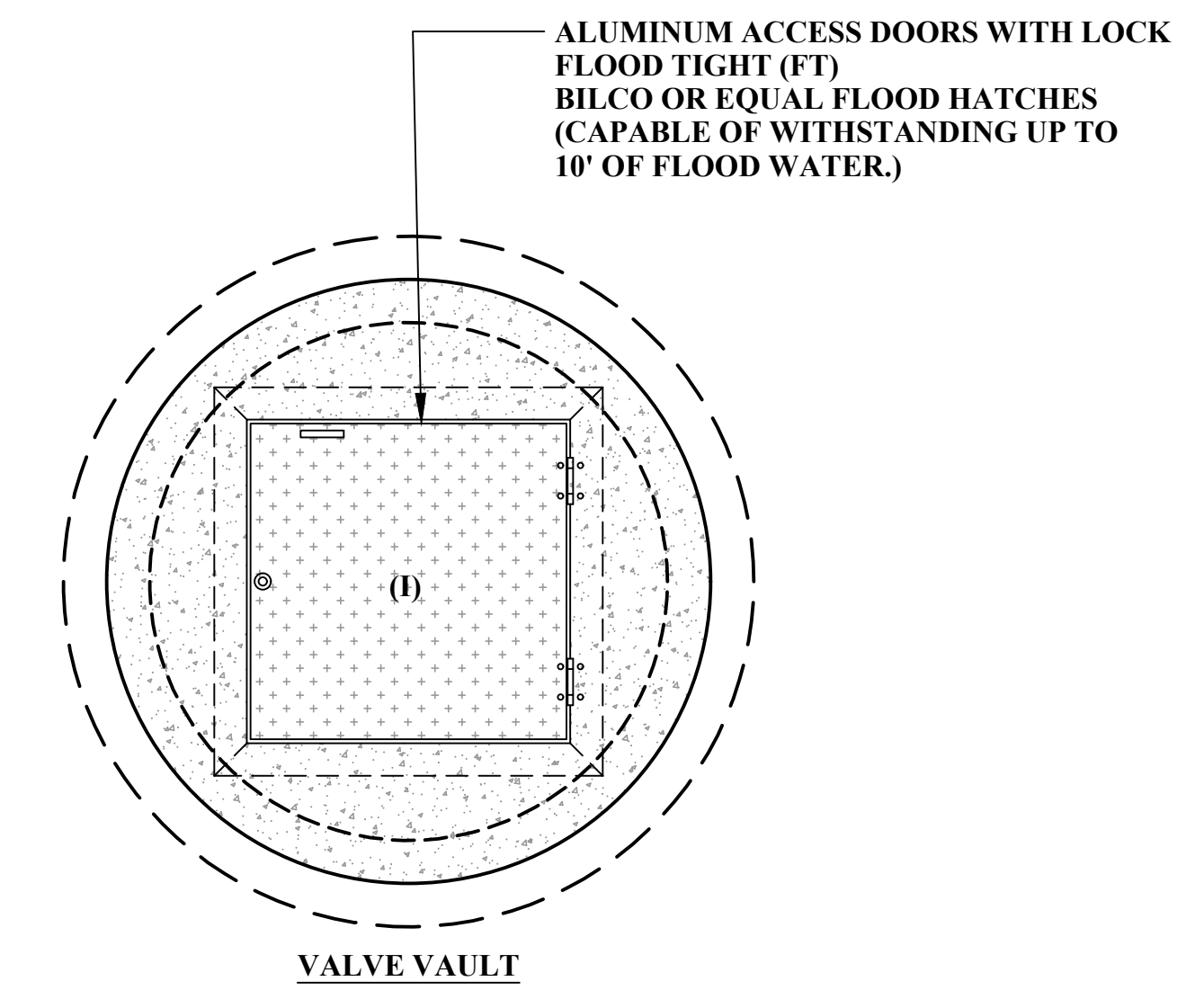

PLAN VIEW



SCALE: AS NOTED
DRAWN: P. LANTZ DATE: 12-21
CHECKED: DATE:
APPROVED: DATE:
SURVEY DATE:
SURVEY BY:
FIELD BOOK No.:

THRASHER
 600 WHITE OAKS BLVD. P.O. BOX 940
 BRIDGEPORT WV 26330
 www.thrashereng.com
 PHONE (304) 624-4108 FAX (304) 624-7831

PHASE No.
CONTRACT No.
PROJECT No.
020-10136

TOWN OF ROWLESBURG
 CRITICAL NEEDS SANITARY
 SEWER UPGRADES
 PRESTON COUNTY, WEST VIRGINIA
 TYPICAL DETAILS

SHEET No.
DET-5

NO.	BY	DATE	DESCRIPTION
2	CT	6/24	UPDATED TABLE

THE INFORMATION CONTAINED HEREIN IS THE SOLE PROPERTY OF THE THRASHER GROUP INC. REPRODUCTION OF THESE DOCUMENTS IN WHOLE OR IN PART, FOR ANY REASON WITHOUT PRIOR WRITTEN PERMISSION, IS STRICTLY PROHIBITED.