

**ROANE COUNTY BOARD OF EDUCATION
ROANE COUNTY, WEST VIRGINIA**

**GEARY ELEMENTARY / MIDDLE SCHOOL
PAVEMENT REPAIR AND IMPROVEMENTS**

ADDENDUM #2

JUNE 2, 2021

THRASHER PROJECT #060-0989

TO WHOM IT MAY CONCERN:

The following are clarifications and responses to questions posed by contractors for the above reference project.

A. GENERAL

1. Summer school will be held at the schools on June 21st – July 16th, Monday through Thursday. Contractor is to coordinate the Work with the Owner so as not to interfere with operations.

B. SPECIFICATIONS - None

C. DRAWINGS

1. C1.01R1
2. C2.02R1
3. C2.03R1

D. QUESTIONS AND RESPONSES

1. **Comment:** On the Asphalt Paved Walkway section it shows 5' from the edge of the walkway to the edge of the existing light fixture. Most of the lights are only 2'-3' from the edge of walkway. Will we need to move the light fixture bases?

Response: The existing light fixtures shall remain in place. The french drain sections shall be adjusted as necessary to satisfy field conditions, maintaining 2:1 slopes and 1' wide base for the french drain. Everywhere else, the french drain

shall be designed in accordance with the Asphalt Paved Walkway Section Detail provided on Sheet C2.01 of the plan set.

2. **Comment:** Will the Trash Enclosure need to include a new concrete pad or be placed on the existing asphalt.

Response: The proposed Trash Enclosure Detail has been revised to include a proposed concrete slab and apron. Detail for the proposed concrete slab and apron sections have been added to Sheet C2.02 of the plan set.

3. **Comment:** Will the Trash Enclosure need to have concrete footers.

Response: The proposed trash enclosure will need concrete footers. Instead, the enclosure shall be placed on a concrete slab per the revised detail provided on Sheet C2.03 of the plan set.

E. CLARIFICATIONS - None

If you have any questions or comments, please feel free to contact me at your earliest convenience. As a reminder, bids will be received until 2:00 p.m. on Wednesday, June 9, 2021, at the office of The Thrasher Group, Inc. Thank you for your interest in the project.

Sincerely,

THE THRASHER GROUP, INC.



Amanda Cheuvront
Project Manager

LAYOUT TAB: Layout CAD FILE: R:\060\060-0990-PAVEMENT REPAIR AND IMPROVEMENTS-ROANE COUNTY SCHOOLS-Drawing\Geary Elementary And Middle School\Drawings\0990 - OVERALL LAYOUT AND DETAILS.dwg PLOT DATE/TIME: 6/1/2021 1:25 PM

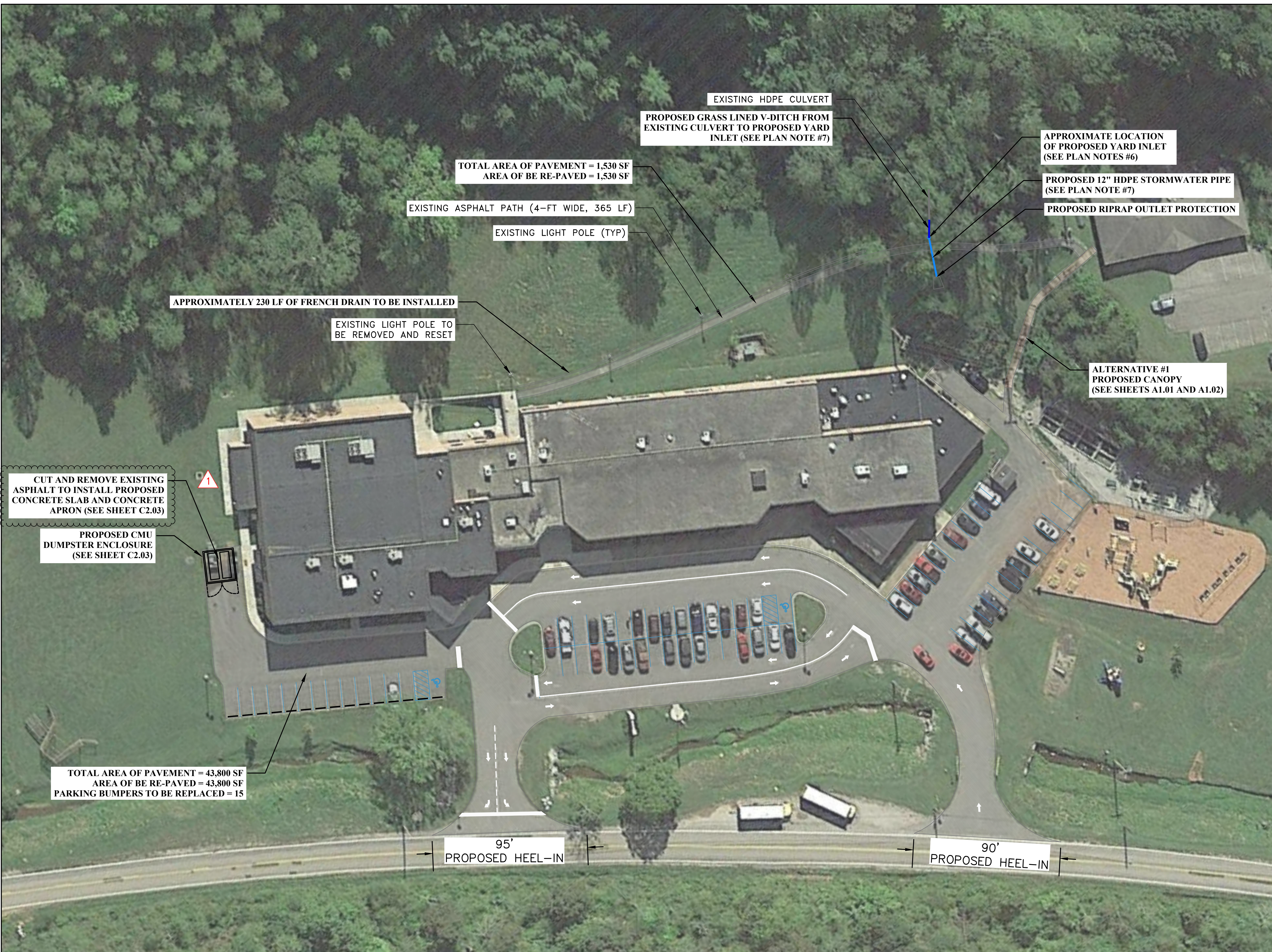

PLAN LEGEND

- PROPOSED RE-PAVING
- PROPOSED CONCRETE CURB

PLAN NOTES

1. MILL AND OVERLAY 2-INCHES OF EXISTING PARKING LOT AND ASPHALT WALKWAY.
2. PATCH SURFACE DEPRESSIONS DEEPER THAN 1 INCH AFTER MILLING. FOR AREAS DEEPER THAN 1 INCH EXCAVATE EXISTING PAVEMENT SECTION TO A SOUND BASE LAYER, AND EXTEND A MINIMUM 12 INCHES INTO PERIMETER OF ADJACENT SOUND PAVEMENT.
3. EXISTING CONCRETE PARKING BUMPERS TO BE RE-MOVED BEFORE MILLING, STORED, AND RE-INSTALLED AFTER PAVING ACTIVITIES HAVE CEASED.
4. PROPOSED PAVEMENT MARKING LOCATION AND ORIENTATION TO RESEMBLE EXISTING PAVEMENT MARKING.
5. EXISTING PARKING SPACES = 70
ADA-ACCESSIBLE PARKING SPACES = 2
NON-ADA-ACCESSIBLE PARKING SPACES = 68
6. EXACT LOCATION OF PROPOSED YARD INLET LOCATION TO BE COORDINATED WITH OWNER.
7. PROPOSED STORMWATER PIPE AND DITCH SHALL BE INSTALLED AT A MINIMUM SLOPE OF 1% UNTIL DAYLIGHTING.

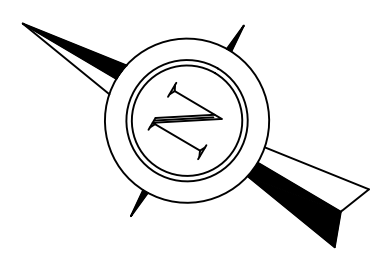

THE INFORMATION CONTAINED HEREIN IS THE SOLE PROPERTY OF THE THRASHER GROUP, INC. REPRODUCTION OF THESE DOCUMENTS IN WHOLE OR IN PART, FOR ANY REASON WITHOUT PRIOR WRITTEN PERMISSION, IS STRICTLY PROHIBITED. COPYRIGHT © 2020 THE THRASHER GROUP, INC.

NO.	BY	DATE	DESCRIPTION
1	CLM	06/01/21	ADDED NOTE REGARDING PROPOSED CONCRETE SLAB AND APRON.

SCALE: AS SHOWN	
DRAWN:	DATE:
CHECKED:	DATE:
APPROVED:	DATE:
SURVEY DATE:	
SURVEY BY:	
FIELD BOOK No.:	

THRASHER
THE THRASHER GROUP, INC.
300 ASSOCIATION DRIVE
CHARLESTON, WV 25311
PHONE (304) 343-7601

PHASE No.	
CONTRACT No.	
PROJECT No.	060-0990

**PAVEMENT REPAIR & IMPROVEMENTS
GEARY ELEMENTARY/MIDDLE SCHOOL
LEFT HAND, WEST VIRGINIA
OVERALL LAYOUT**

SHEET No.
C1.01R1

LAYOUT TAB: DET-2
 CAD FILE: R:\000\060-0990-PAVEMENT REPAIR AND IMPROVEMENTS-ROANE COUNTY SCHOOLS-Drawing\Geary Elementary And Middle School\Drawings\0990 - OVERALL LAYOUT AND DETAILS.dwg
 PLOT DATE/TIME: 6/1/2021 1:15 PM

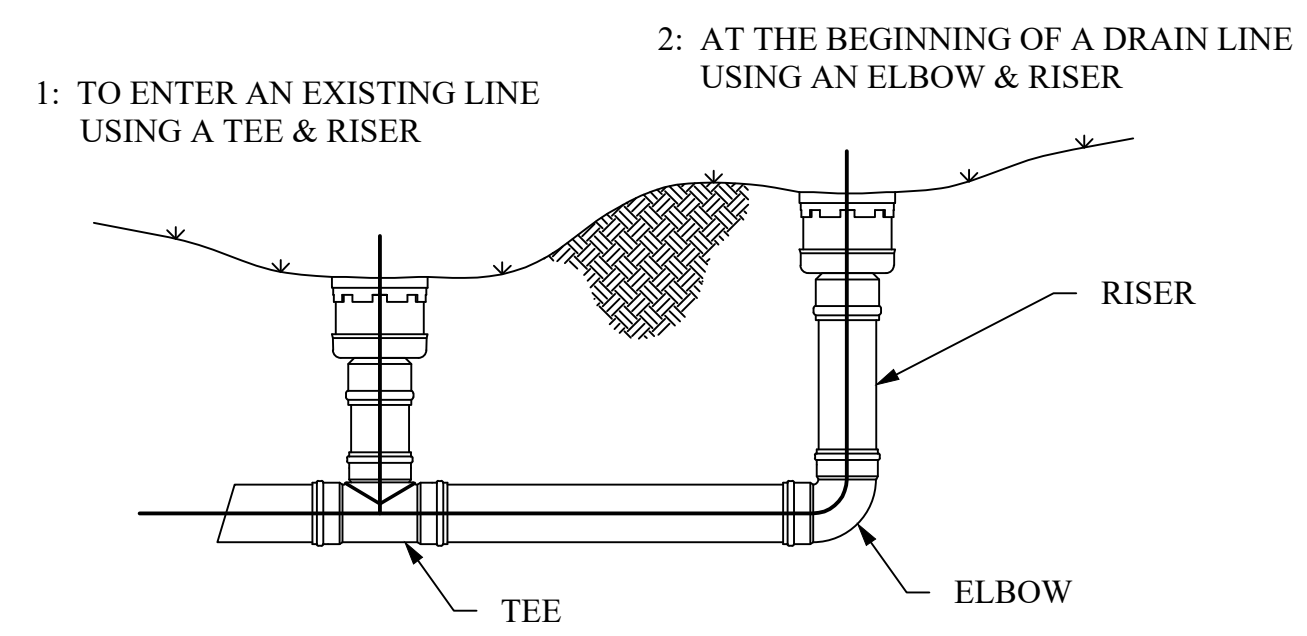

TYPICAL INSTALLATIONS

TYPICAL INSTALLATION OF NYLOPLAST DRAIN BASIN AND INLINE DRAIN

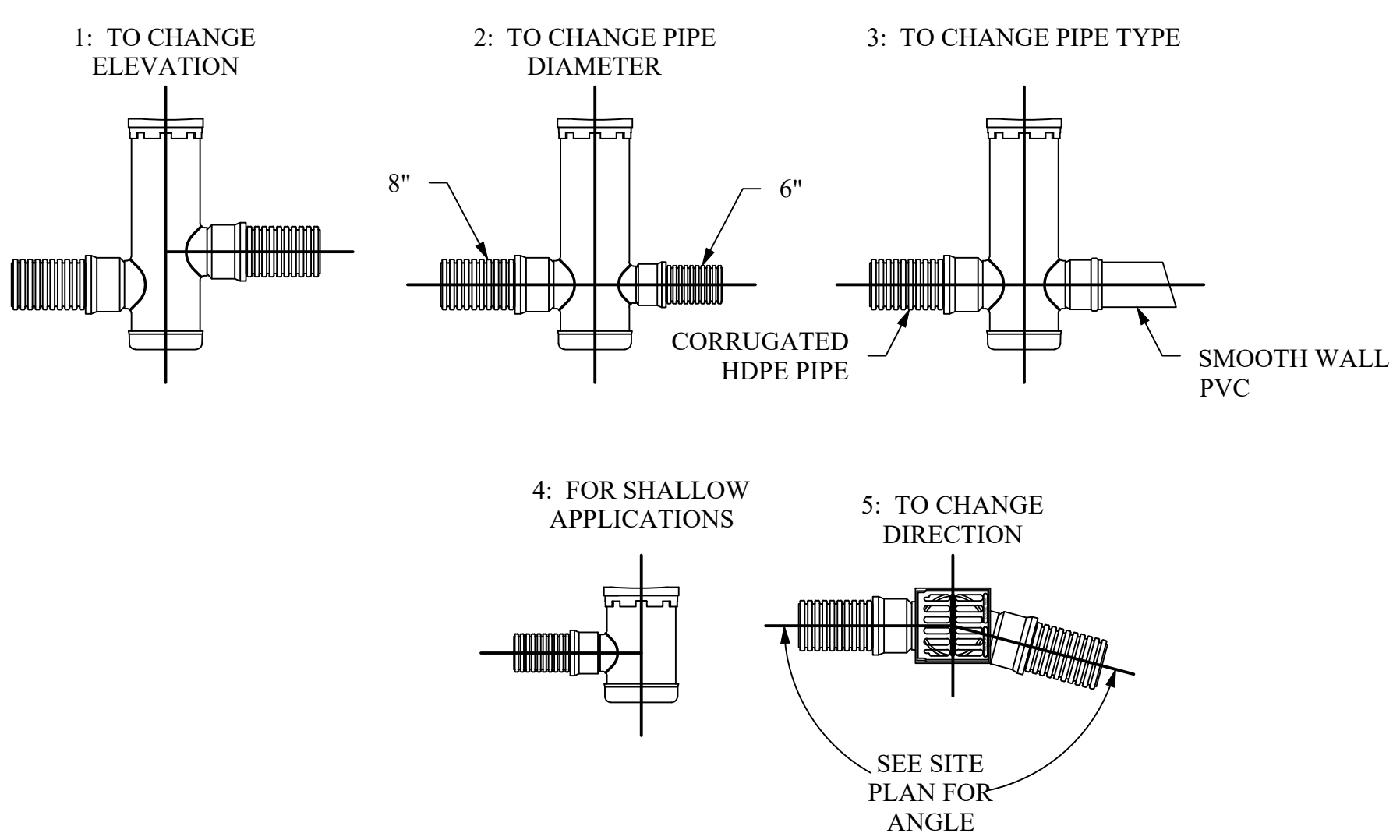
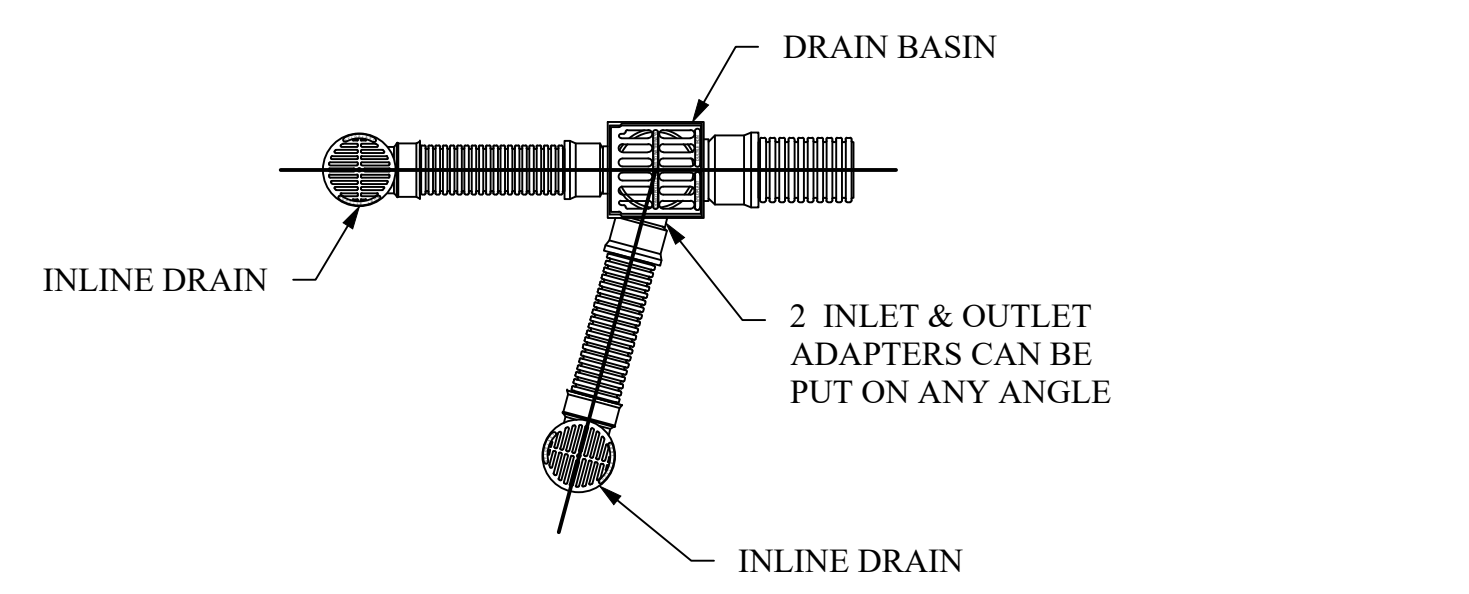
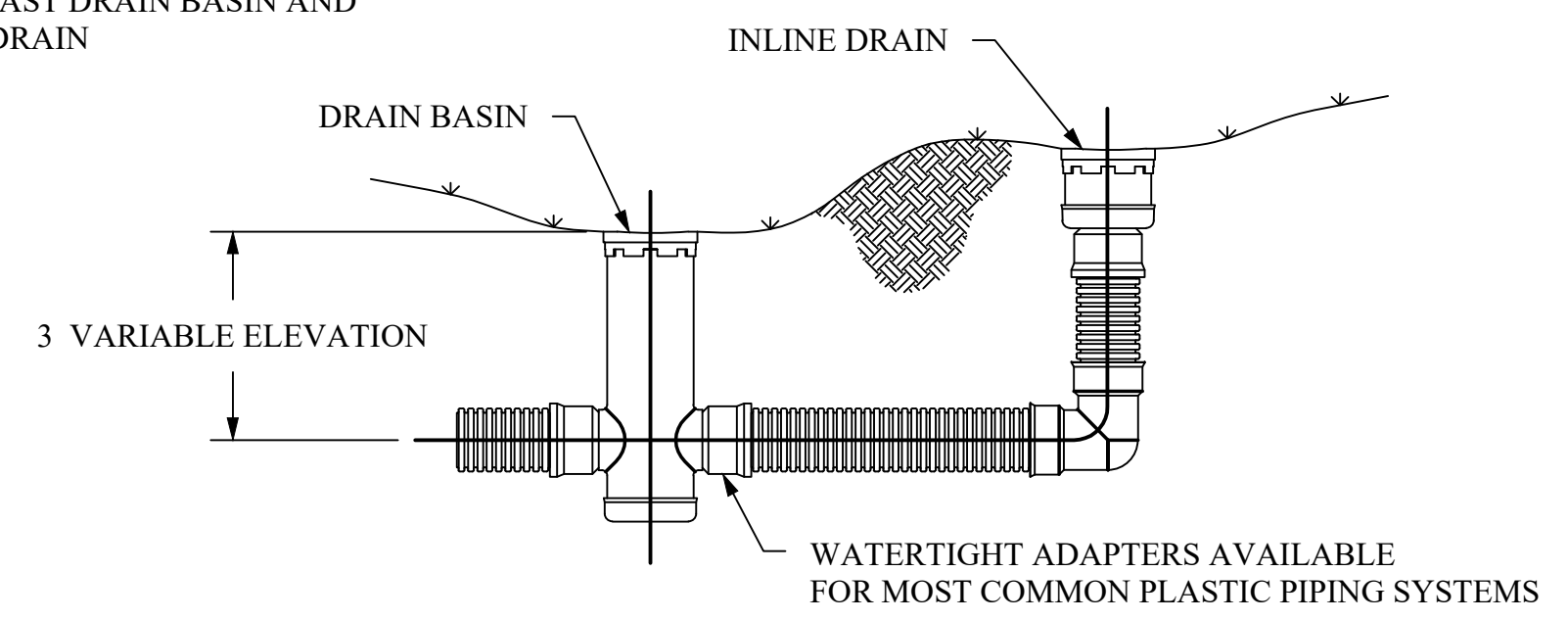

NYLOPLAST DRAIN BASIN DETAIL
 NTS

RED	ELECTRIC
YELLOW	GAS - OIL
ORANGE	TELEPHONE
BLUE	WATER
GREEN	SEWER

COLOR CODES FOR UTILITY LOCATING
MAGNETIC WARNING TAPE

- NOTES:
1. PROVIDE NYLON PULL STRINGS AND CAPS IN EACH CONDUIT.
 2. INSTALL PER INDIVIDUAL UTILITY SPECIFICATIONS.
 3. MAINTAIN MINIMUM SEPARATION AS REQUIRED BY EACH UTILITY AND BY CODE.
 4. PIPE SHALL NOT BE INSTALLED DIRECTLY ON BEDROCK.

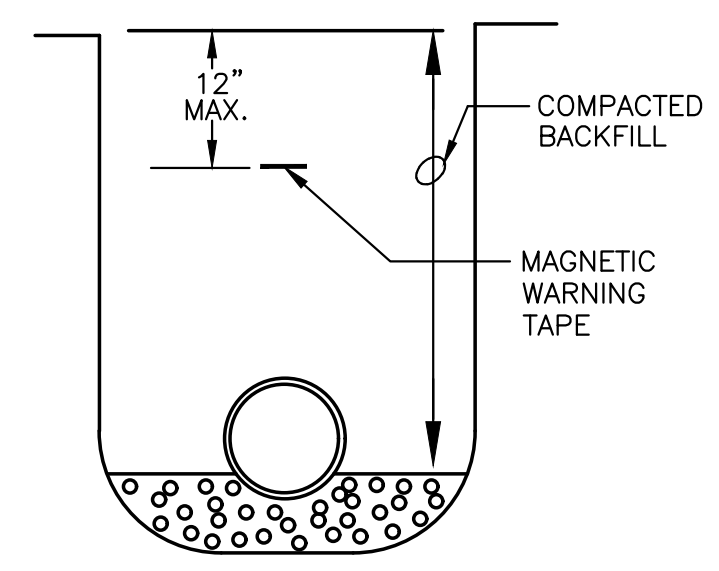

UTILITY MAGNETIC WARNING TAPE

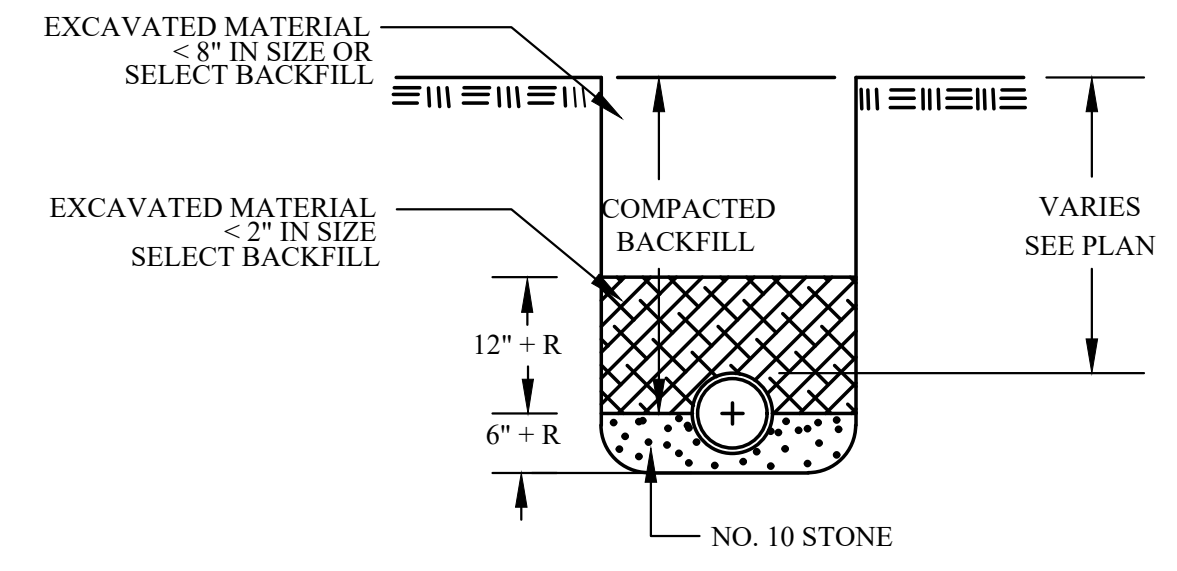

BEDDING FOR STORM SEWER PIPE

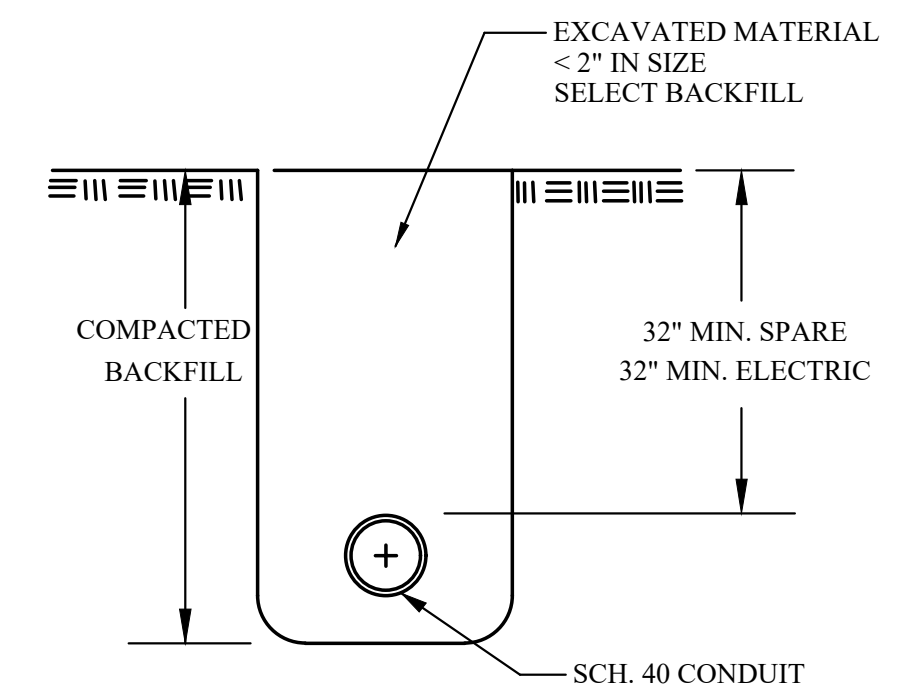

BEDDING FOR CONDUIT FOR ELECTRIC

TYPICAL CROSS SECTIONS OF TRENCHES
 NOT TO SCALE

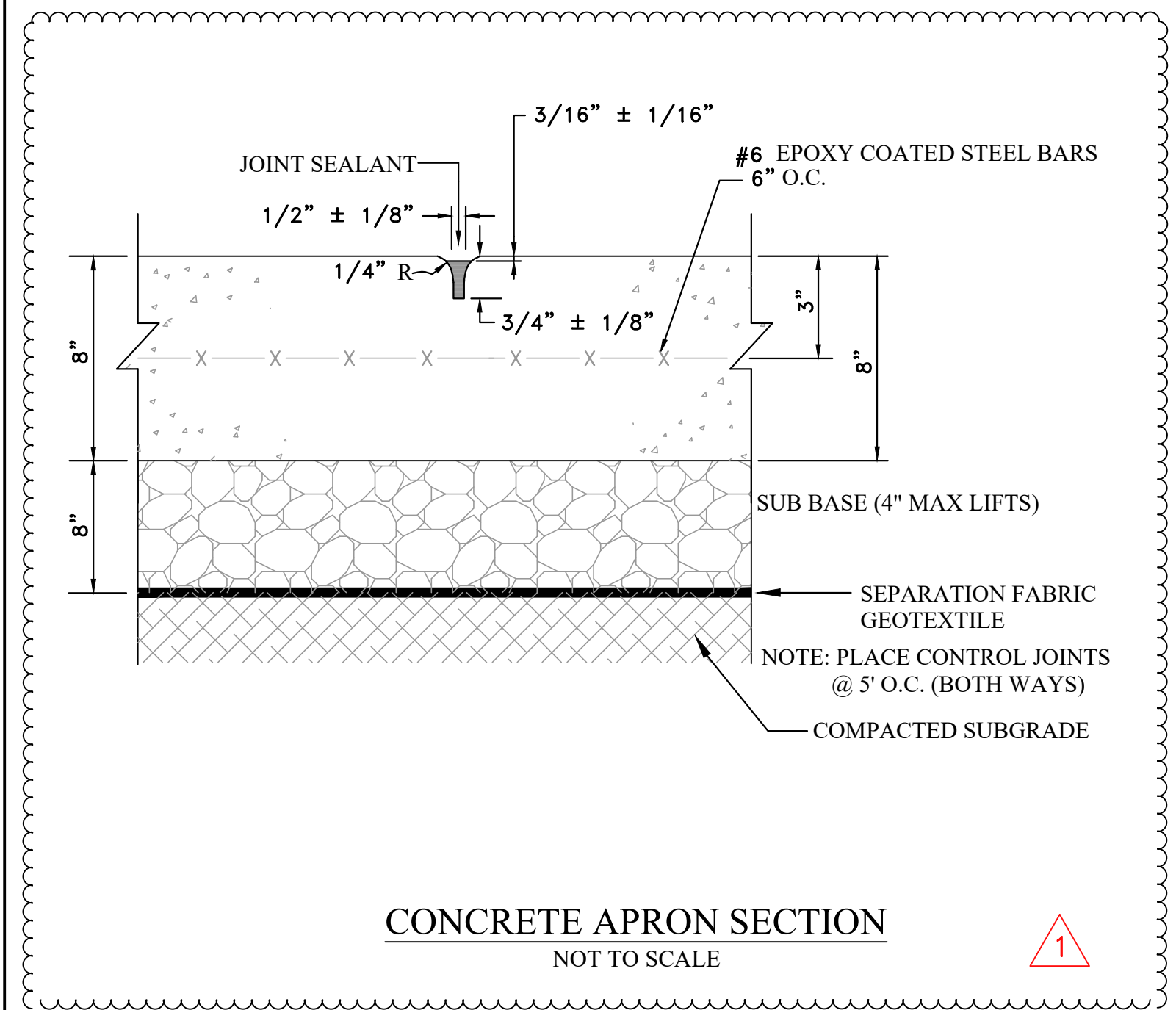

CONCRETE APRON SECTION
 NOT TO SCALE

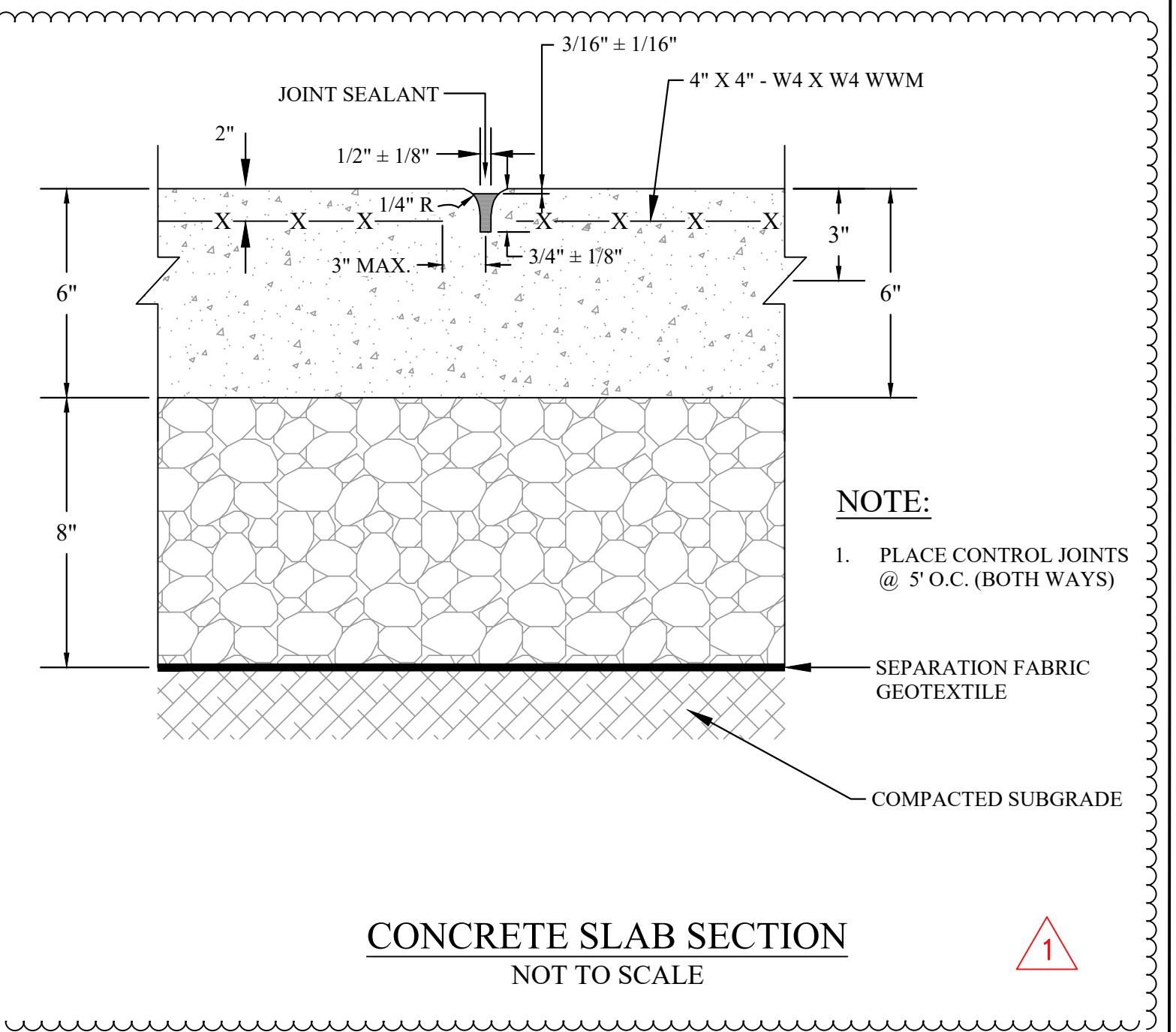

CONCRETE SLAB SECTION
 NOT TO SCALE

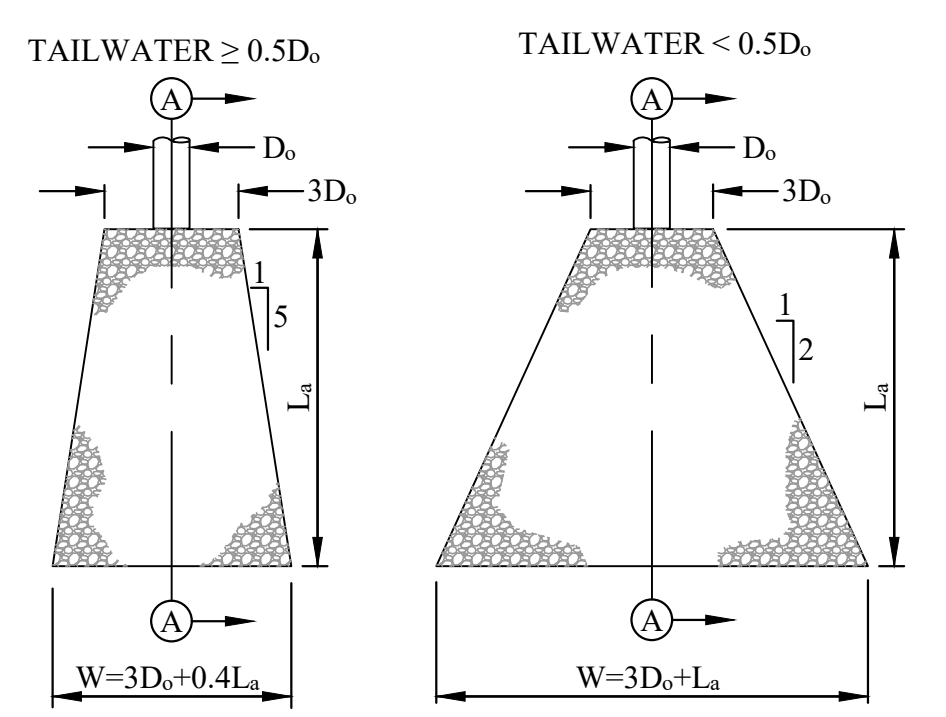

PLAN VIEW

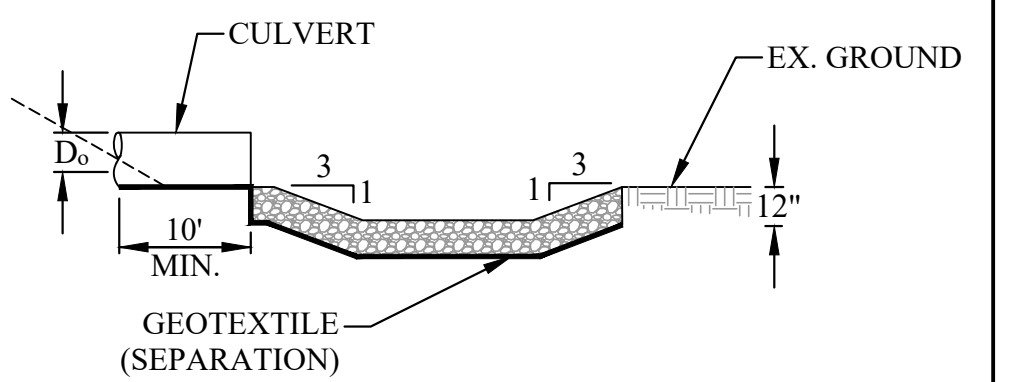

SECTION A-A VIEW

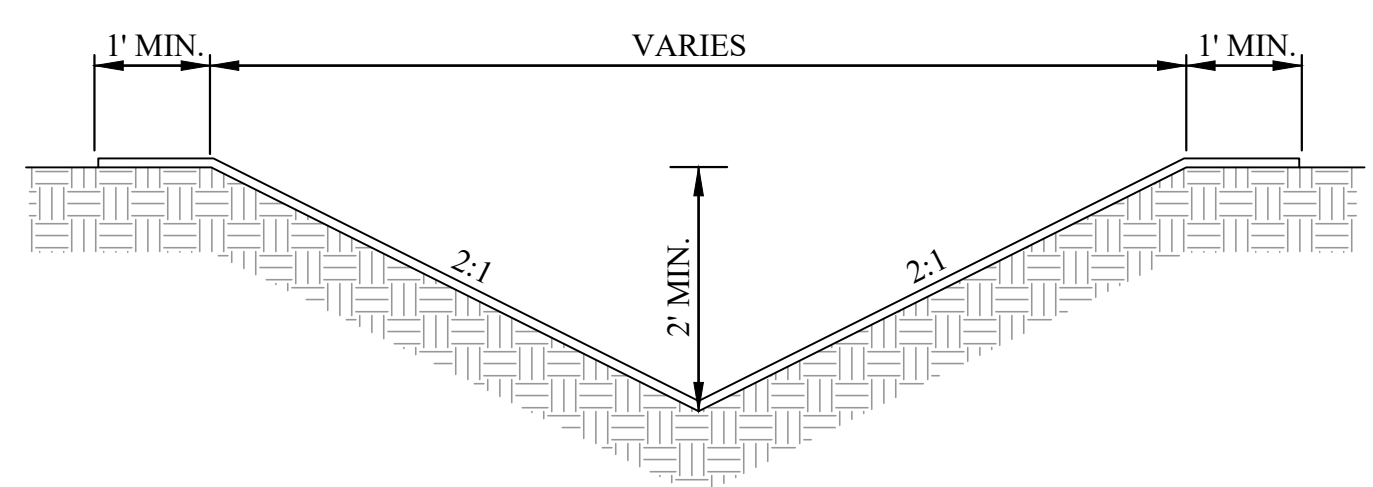

GRASS LINED DITCH
 NOT TO SCALE

NOTES:

1. CONTRACTOR SHALL USE TAILWATER < 0.5D UNLESS OTHERWISE SPECIFIED ON PLANS.
2. GEOTEXTILE (SEPARATION) SHALL BE BURIED BENEATH THE PROPOSED CULVERT A MINIMUM ON TEN (10) FEET MEASURED FROM WHERE THE CULVERT DAYLIGHTS.
3. CULVERT SLOPE SHALL BE FIELD ADJUSTED AS NEEDED TO MINIMIZE THE WATER OUTFALL HEIGHT. (SLOPE SHALL NOT BE LESS THAN THE MINIMUM SLOPE SHOWN IN PROPOSED CULVERT DETAIL OR NOTED ON PLANS.)
4. THE WATER OUTFALL HEIGHT SHALL NOT EXCEED TWO (2) FEET.
5. THE MAXIMUM AGGREGATE SIZE SHALL BE TWELVE (12) INCH.
6. LENGTH OF OUTLET PROTECTION SHALL EXTEND BEYOND THE TOE OF ANY FILL SLOPE SO AS TO DISCHARGE ONTO UNDISTURBED GROUND.

OUTLET PROTECTION
 NOT TO SCALE

NO.	BY	DATE	DESCRIPTION
1	CLM	06/01/21	ADDED CONCRETE APRON AND SLAB SECTION DETAILS.

SCALE: AS SHOWN
DRAWN: DATE:
CHECKED: DATE:
APPROVED: DATE:
SURVEY DATE:
SURVEY BY:
FIELD BOOK No.:

THRASHER
 THE THRASHER GROUP, INC.
 300 ASSOCIATION DRIVE
 CHARLESTON, WV 25311
 PHONE (304) 343-7601

PHASE No.
CONTRACT No.
PROJECT No.
060-0990

PAVEMENT REPAIR & IMPROVEMENTS
GEARY ELEMENTARY/MIDDLE SCHOOL
LEFT HAND, WEST VIRGINIA
DETAILS

SHEET No.
C2.02R1

LAYOUT TAB: DET-2 (2) 06/01/21 1:15 PM
 CAD FILE: R:\060-0990-PAVEMENT REPAIR AND IMPROVEMENTS-ROANE COUNTY SCHOOLS-Drawing\Geary Elementary And Middle School\Drawings\0990 - OVERALL LAYOUT AND DETAILS.dwg

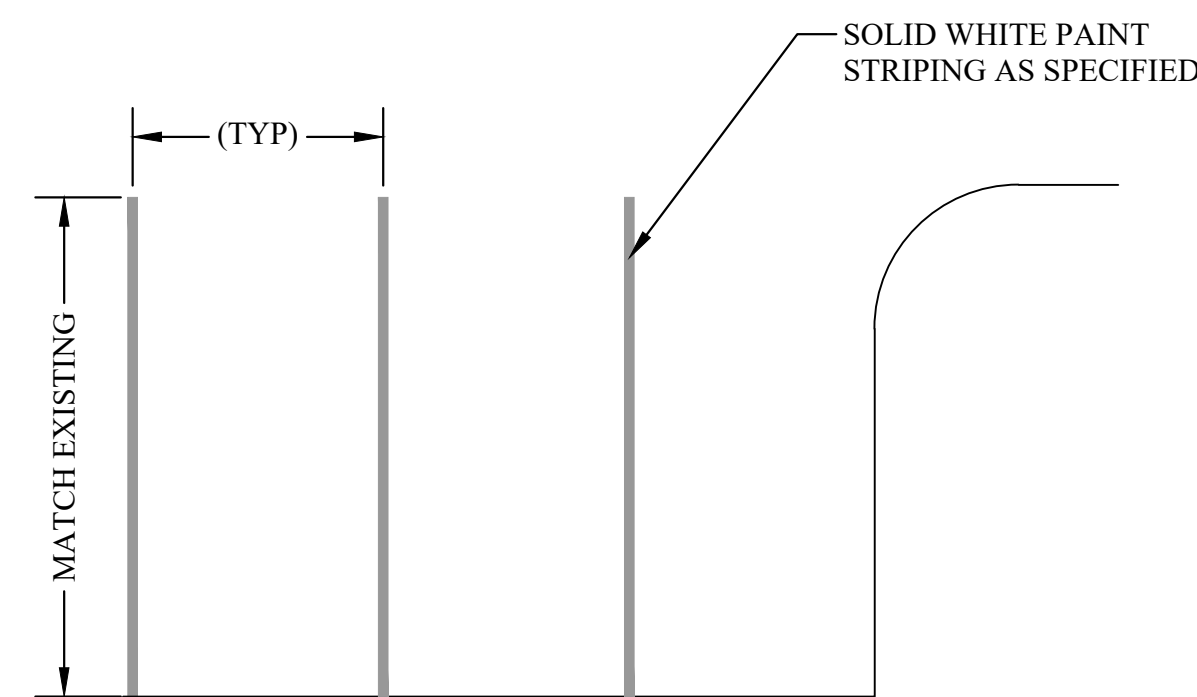
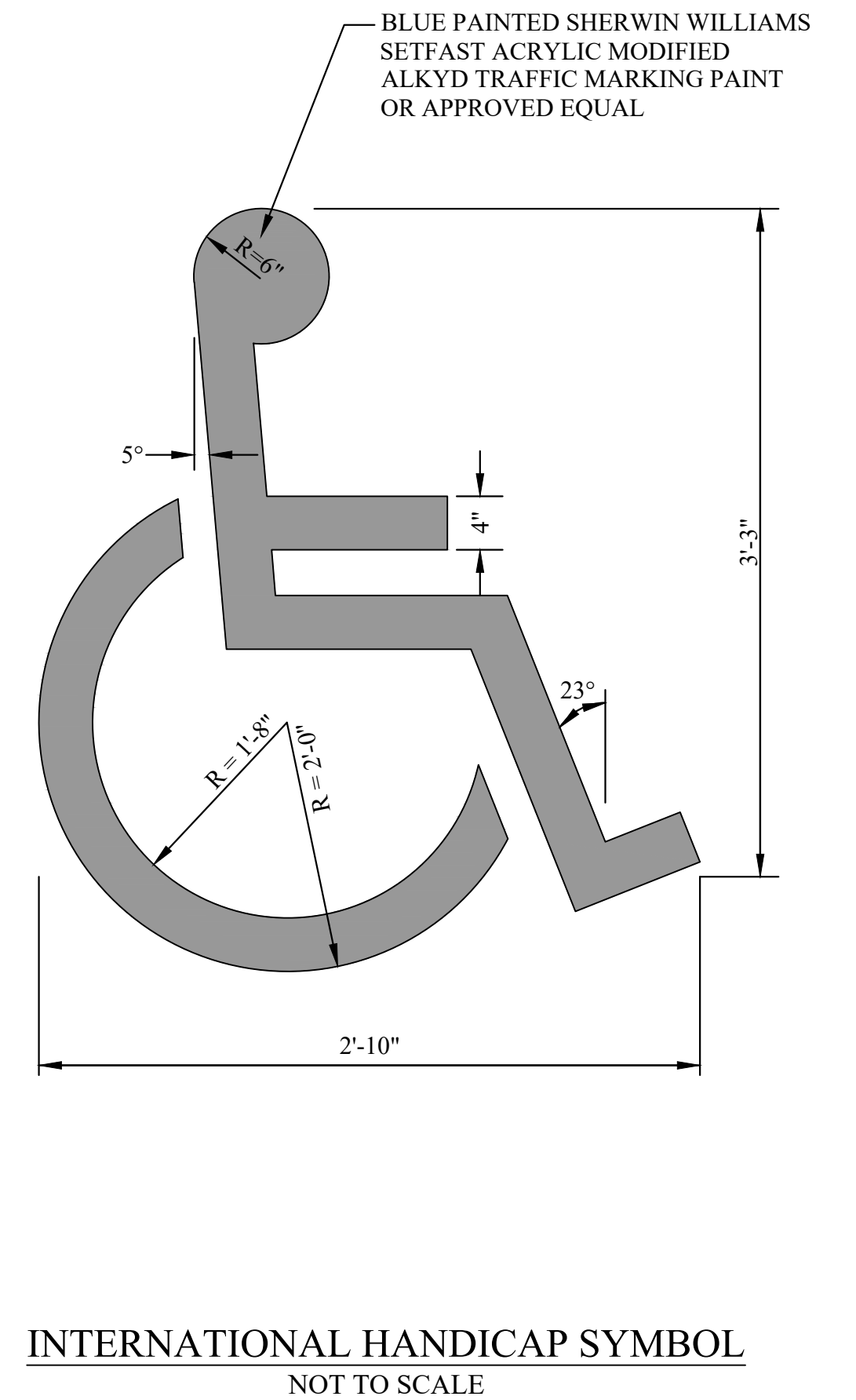
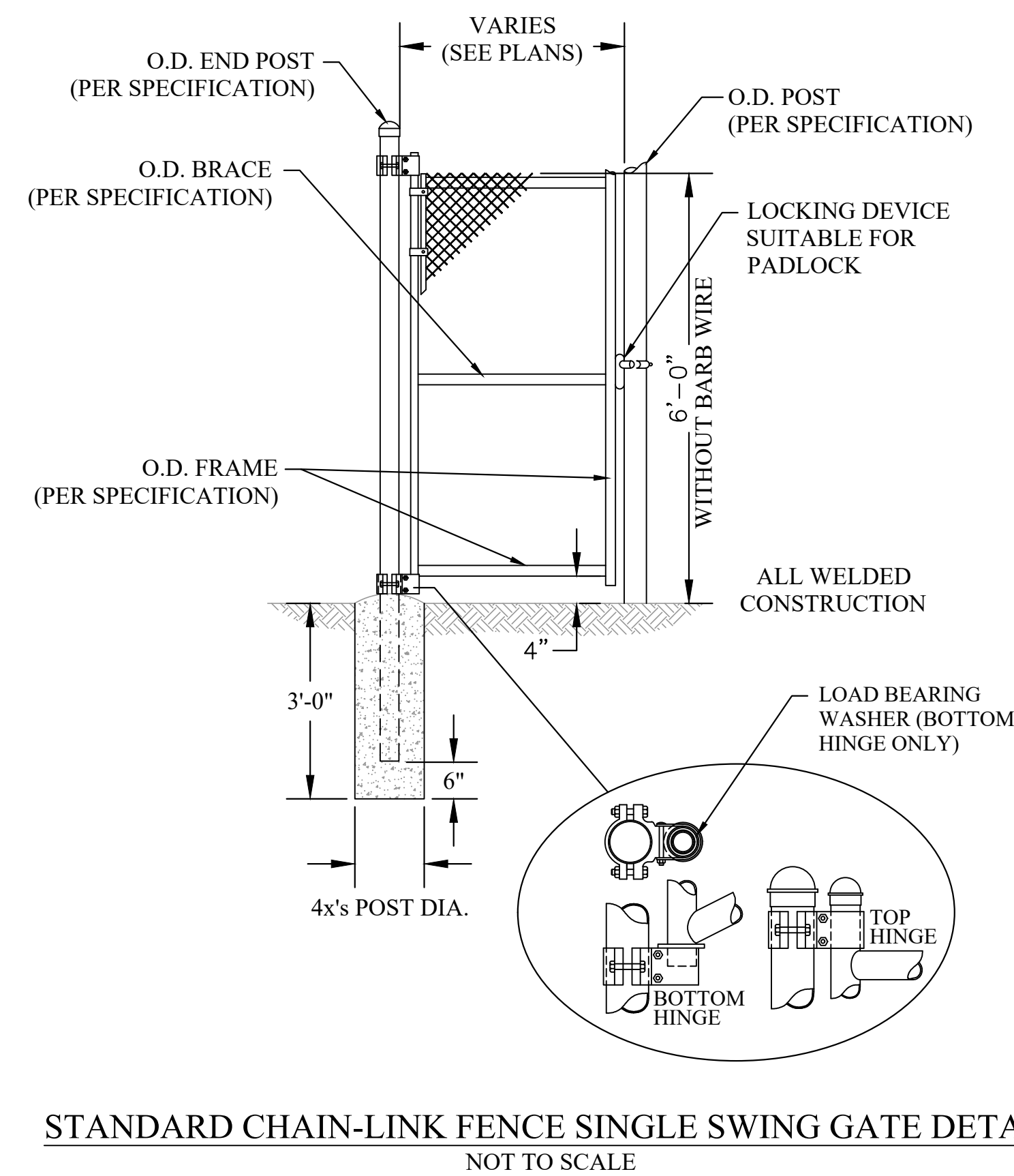
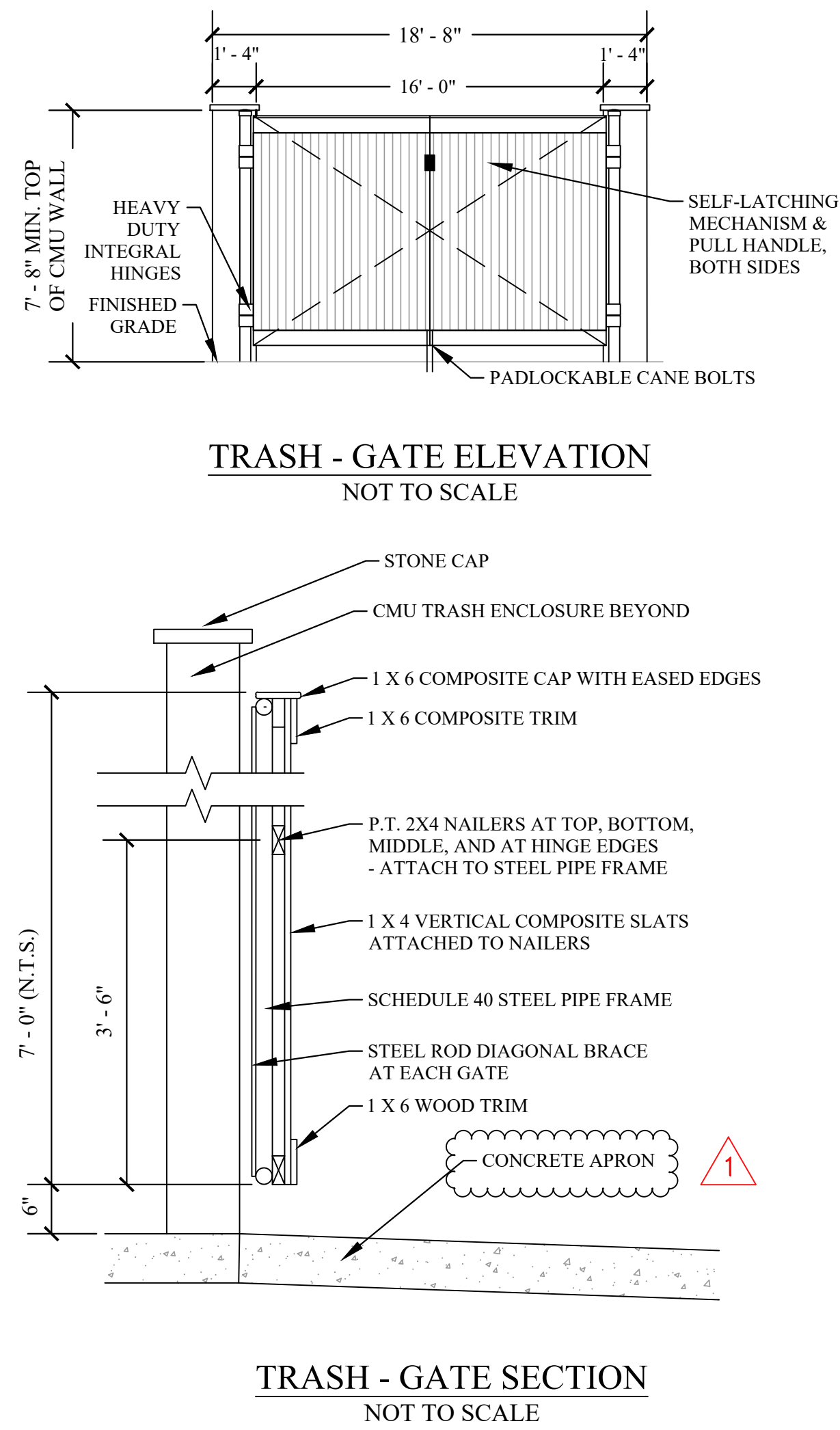
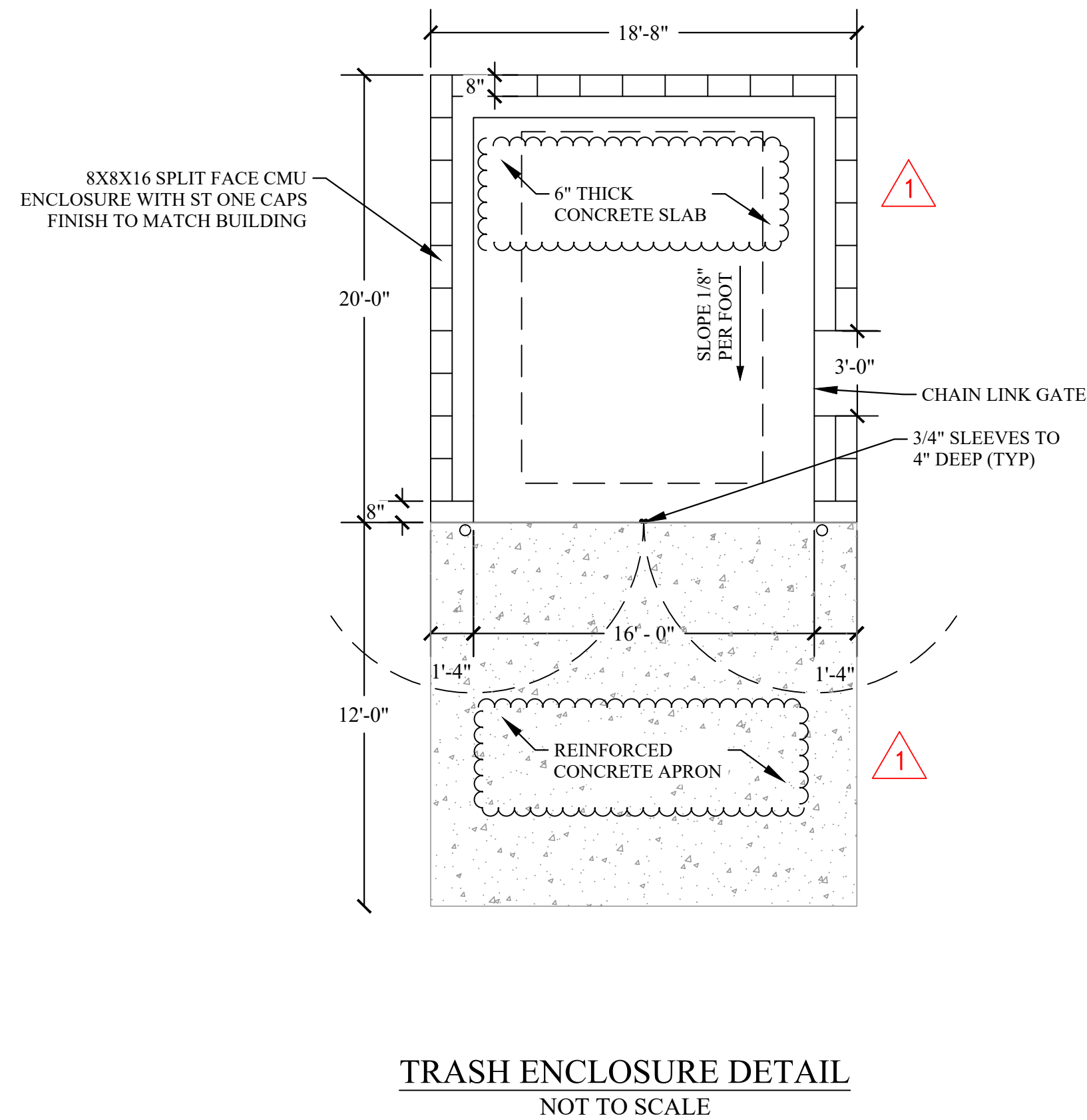

NOTES:

1. PLACE EXPANSION JOINT WHERE DIFFERENT SIDEWALKS ABUT, AND AGAINST ANY STRUCTURE.
2. PLACE EXPANSION JOINTS 20' O.C.
3. PLACE CONTRACTION JOINTS 5' O.C.
4. FINISH SURFACE WITH A NON-SLIP BROOM SWEEP FINISH.

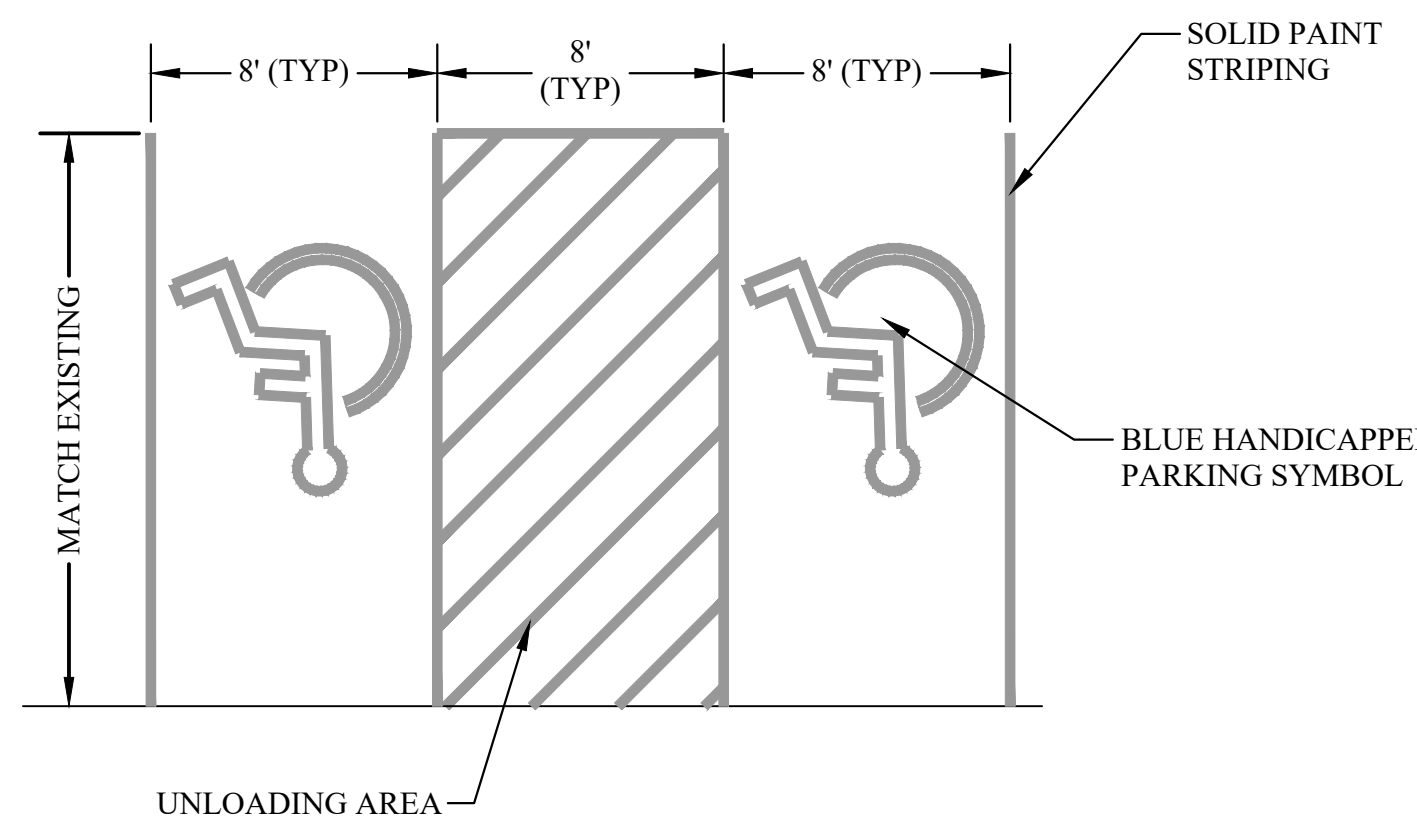

NOTES:

1. SEE PLAN FOR CONFIGURATION OF AREA SHOWN.
2. PARKING LOT GRADE WITHIN ADA PARKING SPACES AND LOADING ZONES SHALL NOT EXCEED 2% IN ANY DIRECTION.

PARKING STRIPING PAINT

RAE LOW VOC ACETONE ACRYLIC TRAFFIC MARKING PAINT.

SKU NO.	COLOR.	SKU NO.	COLOR.
5371	WHITE	5374	BLUE
5372	YELLOW	5375	RED
5373	BLACK		

PROCEED WITH PAVEMENT MARKING ONLY ON CLEAN, DRY SURFACES AT A MINIMUM AMBIENT SURFACE TEMPERATURE OF 50 DEGREES F NOT EXCEEDING 90 DEGREES F AND RELATIVE HUMIDITY AT A MAXIMUM OF 85%. APPLY PAINT MATERIAL AT MANUFACTURER'S RECOMMENDED RATES TO PROVIDE A MINIMUM WE FILM THICKNESS OF 15 MILS AND DRY FILM THICKNESS OF 10 MILS PER COAT. MATERIAL SHALL HAVE A UNIFORM THICKNESS AND SMOOTH SURFACED CROSS-SECTION THROUGHOUT ITS ENTIRE LENGTH. PAINT TO BE APPLIED IN SINGLE COAT WHEN RESTRIPIING EXISTING ASPHALT OR CONCRETE AND IN TWO COATS WHEN RESTRIPIING NEW ASPHALT, NEWLY SEALED COATED AREAS, OR CONCRETE USING A TEMPLATE OR STRIPIING MACHINE. STRIPES SHALL BE A MINIMUM WIDTH OF 4 INCHES UNLESS OTHERWISE NOTED ON DRAWINGS. ALL FINISHED LINES SHALL BE NEAT AND EVEN WITH WELL-DEFINED EDGES AND STRAIGHT OR OF UNIFORM CURVATURE AND SHALL CONFORM WITH TANGENTS, CURVES AND TRANSITIONS AS SPECIFIED ON THE PLANS. ALL PAVEMENT MARKING TEXT, ARROWS, AND SYMBOLS SHALL BE APPLIED WITH STANDARD STENCILS.

THE INFORMATION CONTAINED HEREIN IS THE SOLE PROPERTY OF THE THRASHER GROUP, INC. REPRODUCTION OF THESE DOCUMENTS IN WHOLE OR IN PART, FOR ANY REASON WITHOUT PRIOR WRITTEN PERMISSION, IS STRICTLY PROHIBITED. COPYRIGHT © 2020 THE THRASHER GROUP, INC.

NO.	BY	DATE	DESCRIPTION
1	CLM	06/01/21	ADDED CONCRETE SLAB AND APRON TO TRASH ENCLOSURE.

SCALE: AS SHOWN	
DRAWN:	DATE:
CHECKED:	DATE:
APPROVED:	DATE:
SURVEY DATE:	
SURVEY BY:	
FIELD BOOK No.:	

THRASHER
THE THRASHER GROUP, INC.

PHONE (304) 343-7601

300 ASSOCIATION DRIVE
CHARLESTON, WV 25311

PHASE No.
CONTRACT No.
PROJECT No.
060-0990

PAVEMENT REPAIR & IMPROVEMENTS
GEARY ELEMENTARY/MIDDLE SCHOOL
LEFT HAND, WEST VIRGINIA
DETAILS

SHEET No.

C2.03R1