

**TOWN OF ELIZABETH
WIRT COUNTY, WEST VIRGINIA****CONTRACT NO. 1 – SANITARY SEWER SYSTEM IMPROVEMENTS****NOVEMBER 1, 2019****ADDENDUM NO. 2**

To whom it may concern:

A. BOILER PLATE

1. The Bid Form has been revised to modify the quantities. The revised Bid Form is included with this Addendum No. 2. **YOU MUST USE THE ATTACHED BID FORM INCLUDED WITH THIS ADDENDUM No. 2 WHEN PREPARING YOUR BID PACKAGE.**
2. Updated Wage Rates are included with this Addendum No. 2. **YOU MUST USE THE ATTACHED WAGE RATES INCLUDED WITH THIS ADDENDUM No. 2 WHEN PREPARING YOUR BID PACKAGE.**
3. Bid Opening will be held on November 7, 2019 at 2:00 p.m. at the Elizabeth Wirt Volunteer Fire Department, 91 Schoolview Street, Elizabeth, WV.

B. SPECIFICATIONS

1. **REPLACE** “SECTION 012000 – PRICE AND PAYMENT PROCEDURES” included with this Addendum No. 2.

C. DRAWINGS

1. Sheet No. 1: **REMOVE** the note “TYPE “C” TRENCH REPAIR (TYP.)” shown near MH 1-1 on the plan view.
2. **REPLACE** Sheet 2, included with this Addendum No. 2.
3. Sheet No. 5: **CHANGE** the note on the profile for LINE – 4 from “WVDOH TYPE “B” TRENCH REPAIR, FULL WIDTH” to read “WVDOH TYPE “C” TRENCH REPAIR, FULL WIDTH”.
4. Sheet No. 5: **CHANGE** the note on the LEGEND from “WVDOH TYPE “B” TRENCH REPAIR, FULL WIDTH” to read “WVDOH TYPE “C” TRENCH REPAIR, FULL WIDTH”.
5. **REPLACE** Sheet LS-1, included with this Addendum No. 2.
6. **REPLACE** Sheet LS-2, included with this Addendum No. 2.
7. **ADD** “Supplemental Detail Sheet”, included with this Addendum No. 2.

D. QUESTIONS AND CLARIFICATIONS

The following are clarifications and responses to questions posed by Contractors and suppliers regarding the above referenced project.

1. Generac shall be considered an equal candidate manufacturer for the emergency power generator.

2. **QUESTION:**

There is no bid item for connection to existing customer lateral or 4" PVC lateral pipe from the wye to the customer connection. Will you add bid items for the customer lateral connection and the 4" PVC lateral pipe? Are we to tie the customer lateral in the immediate area of where the main is to be replaced? Please clarify the connection and the PVC lateral.

RESPONSE:

Refer to the revised Bid Form and Section 012000 – PRICE AND PAYMENT PROCEDURES included in this Addendum No. 2.

3. **QUESTION:**

Please provide a detail for concrete and HMA driveway repair? I cannot find in the plans.

RESPONSE:

Refer to the Attached "Supplemental Detail Sheet 1" included with this Addendum No. 2.

4. **QUESTION:**

Are the manholes that are to be installed at the pump station sites paid for in the manhole bid item?

RESPONSE:

No. All work shown and required on the lift station improvements sheets shall be included in the lump sum bid items for lift station improvements.

5. **QUESTION:**

Please provide a detail of the rip rap channel/ditch.

RESPONSE:

Refer to the Attached "Supplemental Detail Sheet 2" included with this Addendum No. 2.

6. QUESTION:

Please provide flow requirements for the various line replacements for the bypass pumping.

RESPONSE:

Bypass pumping systems required for the line replacements shall have a pumping capacity of 160 gpm.

7. QUESTION:

Are we to match the pump flow capacities for the bypass pumping at the pump stations or will you provide flow rates for bypass pumping?

RESPONSE:

Bypass pumping flow rates shall match the pumping rate for the lift stations.

8. QUESTION:

Does the owner have a waste area that can be used?

RESPONSE:

Yes, the Owner has identified a waste area for the project. Please contact Dale Clark with the Town of Elizabeth. Office phone - 304-275-3200; Cell phone - 304-481-3520.

9. QUESTION:

Are the customer service lateral connections to be done while the line is to be replaced?

RESPONSE:

Yes.

10. QUESTION:

Will you change the overlay bid item from LF to SY? Will you add a bid item for milling of existing street by the SY?

RESPONSE:

No.

11. QUESTION:

Is the bypass pumping for pump station in the bypass pumping bid item or in the pump station bid items?

RESPONSE:

All work shown and required to successfully to complete the work on the lift station improvements sheets shall be included in the lump sum bid items for lift station improvements.

12. QUESTION:

Please provide top elevations for the manholes at the pump stations.

RESPONSE:

Manhole rim elevations are provided on revised plan sheets LS-1 and L2-1 included with this Addendum No. 2.

13. QUESTION:

Is Type A pavement replacement required on the House Laterals? The 3600LF quantity is only enough for the main line.

RESPONSE:

Yes. Refer to the revised Bid Form and Section 012000 – PRICE AND PAYMENT PROCEDURES included in this Addendum No. 2.

14. QUESTION:

Regarding Bid Item 13, 8"x4" PVC WYE, am I correct to include in this lump sum item, the wye, all fittings (including the customers cleanout), lateral trench paving, side walks and pipe to the connection point of the property line?

RESPONSE:

Refer to the revised Bid Form and Section 012000 – PRICE AND PAYMENT PROCEDURES included in this Addendum No. 2.

15. QUESTION:

What is expected of us to test the sanitary sewer line installation?

RESPONSE:

Testing requirements are specified in Section 330130.13 – SEWER AND MANHOLE TESTING.

16. QUESTION:

The plan view of the sanitary sewer on drawings 1 & 2 indicate Type “C” Trench Repair. The same drawing on the profile view indicate Type “A” trench Repair. We will get paid for Type “A” Trench Repair with Bid Item 21. How do we get paid for Type “C” Trench repair?

RESPONSE:

Refer to Revised Sheet No. 1 & 2 included with this Addendum No. 2.

17. QUESTION:

There is not enough elevation data on a certain rehab manhole to determine the vertical footage of the manhole. This information is needed to determine the regrouting for said manhole and the actual vertical footage of other manholes to cost the excavation and replacement cost of the new manholes. Can the top and bottom elevation of those manholes be provided?

RESPONSE:

Due to field conditions during design existing elevations were not able to be obtained, as indicated on the drawings. The Contractor will be required to field verify the elevations of the manholes during construction. All costs for exploratory excavation “pot holing” shall be included in the unit price bid items.

18. QUESTION:

There are no rehab details for bid item #51, MH #117.

RESPONSE:

There is no MH #117 included in the Contract. Refer to the revised Bid Form included in this Addendum No. 2.

19. QUESTION:

Are all customer reconnects to be done from under the street? Plan drawing on sheet 3 shows connections in the street. Detail drawing on D1 shows capping and marking with a board, says customer is responsible for the connection. If the contractor is to make the connection, will testing be required? If so, how will this be done with the customer reconnects?

RESPONSE: The Contractor is required to reconnect all existing customers and install a new customer cleanout on the edge of each customers yard. Testing requirements are specified in Section – 330130.13 – SEWER AND MANHOLE TESTING.

E. GENERAL

1. Bidders are hereby notified to acknowledge receipt of all addenda in space provided on the Bid Form.

If you have any questions or need any other information please do not hesitate to contact me.

Sincerely,

THE THRASHER GROUP, INC.



JESSE ALDEN, P.E.
Project Manager

Enclosures



10-31-2019

TOWN OF ELIZABETH
WIRT COUNTY, WEST VIRGINIA
PROPOSED
CONTRACT #1- SANITARY SEWER SYSTEM IMPROVEMENTS
THRASHER PROJECT #101-020-1550

BID FORM

ARTICLE 1 – BID RECIPIENT

1.01 This Bid is submitted to:

Town of Elizabeth
200 Beverly Street
Elizabeth, WV 26143

1.02 The undersigned Bidder proposes and agrees, if this Bid is accepted, to enter into an Agreement with Owner in the form included in the Bidding Documents to perform all Work as specified or indicated in the Bidding Documents for the prices and within the times indicated in this Bid and in accordance with the other terms and conditions of the Bidding Documents.

ARTICLE 2 – BIDDER’S ACKNOWLEDGEMENTS

2.01 Bidder accepts all of the terms and conditions of the Instructions to Bidders, including without limitation those dealing with the disposition of Bid security. This Bid will remain subject to acceptance for 90 days after the Bid opening, or for such longer period of time that Bidder may agree to in writing upon request of Owner.

ARTICLE 3 – BIDDER’S REPRESENTATIONS

3.01 In submitting this Bid, Bidder represents that:

A. Bidder has examined and carefully studied the Bidding Documents, and any data and reference items identified in the Bidding Documents, and hereby acknowledges receipt of the following Addenda:

Addendum No.

Addendum Date

B. Bidder has visited the Site, conducted a thorough, alert visual examination of the Site and adjacent areas, and become familiar with and satisfied itself as to the general, local, and Site conditions that may affect cost, progress, and performance of the Work.

C. Bidder is familiar with and has satisfied itself as to all Laws and Regulations that may affect cost, progress, and performance of the Work.

D. Bidder has carefully studied all: (1) reports of explorations and tests of subsurface conditions at or adjacent to the Site and all drawings of physical conditions relating to existing surface or subsurface structures at the Site that have been identified in the Supplementary Conditions, especially with respect to Technical Data in such reports and drawings, and (2) reports and drawings relating to Hazardous

ADDENDUM NO. 2

Environmental Conditions, if any, at or adjacent to the Site that have been identified in the Supplementary Conditions, especially with respect to Technical Data in such reports and drawings.

- E. Bidder has considered the information known to Bidder itself; information commonly known to contractors doing business in the locality of the Site; information and observations obtained from visits to the Site; the Bidding Documents; and any Site-related reports and drawings identified in the Bidding Documents, with respect to the effect of such information, observations, and documents on (1) the cost, progress, and performance of the Work; (2) the means, methods, techniques, sequences, and procedures of construction to be employed by Bidder; and (3) Bidder's safety precautions and programs.
- F. Bidder agrees, based on the information and observations referred to in the preceding paragraph, that no further examinations, investigations, explorations, tests, studies, or data are necessary for the determination of this Bid for performance of the Work at the price bid and within the times required, and in accordance with the other terms and conditions of the Bidding Documents.
- G. Bidder is aware of the general nature of work to be performed by Owner and others at the Site that relates to the Work as indicated in the Bidding Documents.
- H. Bidder has given Engineer written notice of all conflicts, errors, ambiguities, or discrepancies that Bidder has discovered in the Bidding Documents, and confirms that the written resolution thereof by Engineer is acceptable to Bidder.
- I. The Bidding Documents are generally sufficient to indicate and convey understanding of all terms and conditions for the performance and furnishing of the Work.
- J. The submission of this Bid constitutes an incontrovertible representation by Bidder that Bidder has complied with every requirement of this Article, and that without exception the Bid and all prices in the Bid are premised upon performing and furnishing the Work required by the Bidding Documents.

ARTICLE 4 – BIDDER'S CERTIFICATION

4.01 Bidder certifies that:

- A. This Bid is genuine and not made in the interest of or on behalf of any undisclosed individual or entity and is not submitted in conformity with any collusive agreement or rules of any group, association, organization, or corporation;
- B. Bidder has not directly or indirectly induced or solicited any other Bidder to submit a false or sham Bid;
- C. Bidder has not solicited or induced any individual or entity to refrain from bidding; and
- D. Bidder has not engaged in corrupt, fraudulent, collusive, or coercive practices in competing for the Contract. For the purposes of this Paragraph 4.01.D:
 - 1. "corrupt practice" means the offering, giving, receiving, or soliciting of any thing of value likely to influence the action of a public official in the bidding process;
 - 2. "fraudulent practice" means an intentional misrepresentation of facts made (a) to influence the bidding process to the detriment of Owner, (b) to establish bid prices at artificial non-competitive levels, or (c) to deprive Owner of the benefits of free and open competition;
 - 3. "collusive practice" means a scheme or arrangement between two or more Bidders, with or without the knowledge of Owner, a purpose of which is to establish bid prices at artificial, non-competitive levels; and
 - 4. "coercive practice" means harming or threatening to harm, directly or indirectly, persons or their property to influence their participation in the bidding process or affect the execution of the Contract.

ARTICLE 5 – BASIS OF BID

GENERAL

The Bidder shall take notice of and shall be responsible for any local or state taxes levied and applicable, and the cost for the same shall be included as part of the submitted Bid.

The total Bid cost stated includes a complete operating installation including furnishing and installation of any and all changes or additions in plans, piping, mechanical work, additional electrical work, accessories, controls, etc. necessary to accommodate alternative equipment systems or materials used in construction.

BID PROPOSAL

The Bidder agrees to perform all required Work described in the detailed Specifications and as shown on the Plans for the complete construction and placing in satisfactory operation the Sanitary Sewer System Improvements. The Project "Sequence of Construction" has been detailed in the Drawings and Specification Division 1, Project Summary, Section 1010, Part-2 Execution. The Bidder agrees to perform all the Work proposed for the total of the following Bid prices.

5.01 Bidder will complete the Work in accordance with the Contract Documents for the following price(s):

**PROPOSED
CONTRACT #1- SANITARY SEWER SYSTEM IMPROVEMENTS
FOR THE
TOWN OF ELIZABETH
WIRT COUNTY, WEST VIRGINIA**

BID SCHEDULE

NOTE: Bid Unit PRICE amounts are to be shown in both words and figures. In case of discrepancy, the amount shown in words will govern. Bids shall include sales tax and all other applicable taxes and fees.

Item #	Qty.	UNIT	DESCRIPTION	UNIT PRICE	UNIT PRICE WRITTEN IN WORDS	TOTAL PRICE
1	1	LS	Mobilization/Demobilization			
2	1	LS	Erosion & Sediment Control			
3	1	LS	Videotaping of Project Area			

ADDENDUM NO. 2

Item #	Qty.	UNIT	DESCRIPTION	UNIT PRICE	UNIT PRICE WRITTEN IN WORDS	TOTAL PRICE
4	1	LS	Temporary Bypass Pumping			
5	550	LF	8" PVC SDR-35 Gravity Sewer Line Remove & Replace (0'-6')			
6	925	LF	8" PVC SDR-35 Gravity Sewer Line Remove & Replace (6'-9')			
7	1,150	LF	8" PVC SDR-35 Gravity Sewer Line Remove & Replace (9'-12')			
8	585	LF	8" PVC SDR-35 Gravity Sewer Line Remove & Replace (12'+)			
9	1,500	LF	4" PVC SDR-35 Service Lateral Pipe			
10	75	EA	Reconnect Existing Sewer Customer			
11	495	LF	18" HDPE Storm Drain (0'-6')			
12	290	LF	18" HDPE Storm Drain (6'-9')			
13	18	EA	48" Dia. Manhole Base, Cone Top, Regular Casting Remove and Replace			
14	70	VF	48" Diameter Manhole Riser Pipe			

ADDENDUM NO. 2

Item #	Qty.	UNIT	DESCRIPTION	UNIT PRICE	UNIT PRICE WRITTEN IN WORDS	TOTAL PRICE
15	75	EA	8" x 4" PVC Wye Connection			
16	2	EA	4' x 4' Precast D.I. Drop Inlet			
17	80	LF	Concrete Driveway Repair			
18	150	LF	Gravel Driveway Repair			
19	20	LF	HMA Driveway Repair			
20	1	EA	Reinforced Concrete Headwall			
21	70	LF	Rip-Rap Lined Channel			
22	6	EA	Reconnect Existing Sewer Line to Proposed Manhole			
23	5,160	LF	WVDOH Type "A" Trench Repair			
24	475	LF	WVDOH Type "C" Trench Repair			
25	3,660	LF	2" HMA Overlay			

ADDENDUM NO. 2

Item #	Qty.	UNIT	DESCRIPTION	UNIT PRICE	UNIT PRICE WRITTEN IN WORDS	TOTAL PRICE
26	1	EA	MH #3 Rehabilitation			
27	1	EA	MH #4 Rehabilitation			
28	1	EA	MH #A Rehabilitation			
29	1	EA	MH #15 Rehabilitation			
30	1	EA	MH #11 Rehabilitation			
31	1	EA	MH #10A Rehabilitation			
32	1	EA	MH #16 Rehabilitation			
33	1	EA	MH #106 Rehabilitation			
34	1	EA	MH #96 Rehabilitation			
35	1	EA	MH #50 Rehabilitation			
36	1	EA	MH #DOH Rehabilitation			

ADDENDUM NO. 2

Item #	Qty.	UNIT	DESCRIPTION	UNIT PRICE	UNIT PRICE WRITTEN IN WORDS	TOTAL PRICE
37	1	EA	MH #88 Rehabilitation			
38	1	EA	MH #B Rehabilitation			
39	1	EA	MH #72 Rehabilitation			
40	1	EA	MH #C Rehabilitation			
41	1	EA	MH #D Rehabilitation			
42	1	EA	MH #32 Rehabilitation			
43	1	EA	MH #110 Rehabilitation			
44	1	EA	MH #109 Rehabilitation			
45	1	EA	MH #89 Rehabilitation			
46	1	EA	MH #E Rehabilitation			
47	1	EA	MH #F Rehabilitation			

ADDENDUM NO. 2

Item #	Qty.	UNIT	DESCRIPTION	UNIT PRICE	UNIT PRICE WRITTEN IN WORDS	TOTAL PRICE
48	1	EA	MH #G Rehabilitation			
49	1	EA	MH #133 Rehabilitation			
50	1	EA	MH #125 Rehabilitation			
51	1	EA	MH #124 Rehabilitation			
52	1	EA	MH #112 Rehabilitation			
53	1	EA	MH #17 Rehabilitation			
54	1	EA	MH #28 Rehabilitation			
55	1	EA	MH #119 Rehabilitation			
56	1	LS	Franklin Street Lift Station Improvements			
57	1	LS	Little Kanawha Lift Station Improvements			
58	5,110	LF	WVDOH Inspection Fees	\$3.37	Three Dollars Thirty Seven Cents	\$17,220.70

ADDENDUM NO. 2

Item #	Qty.	UNIT	DESCRIPTION	UNIT PRICE	UNIT PRICE WRITTEN IN WORDS	TOTAL PRICE
59	Allow		To provide all labor, equipment, materials, and services to provide capital improvements required by the electric company to provide adequate electrical service to the project site including additional power poles, transformers, meters, cable and/or conduit and other electrical accessories for the allowance amount of:	\$15,000.00	Fifteen Thousand Dollars and Zero Cents	\$15,000.00

TOTAL BASE BID: _____
 _____ (\$ _____)

(Amounts are to be shown in both words and figures. In case of discrepancy, the amount shown in words will govern.)

NOTE: THE CONTRACTOR'S UNIT PRICES SHALL INCLUDE PURCHASE AND INSTALLATION, COMPLETE IN PLACE, PER BID ITEM IN ACCORDANCE WITH THE DETAILED SPECIFICATIONS.

Bidder acknowledges that (1) each Bid Unit Price includes an amount considered by Bidder to be adequate to cover Contractor's overhead and profit for each separately identified item, and (2) estimated quantities are not guaranteed, and are solely for the purpose of comparison of Bids, and final payment for all unit price Bid items will be based on actual quantities, determined as provided in the Contract Documents.

METHOD OF AWARD

If at the time this contract is to be awarded, the lowest total base bid submitted by a qualified, responsible Bidder does not exceed the amount of funds then estimated by the Owner, as available to finance the contract, the construction contract will be awarded. If such bids exceed such amount, the Owner may reject all bids.

The owner may award the contract on the Total Bid submitted by a qualified responsible Bidder less the amount(s) of the Deductive Alternate(s) subtracted in numerical order, as listed in the contract to produce the lowest bid within the funds available for financing.

- A. Unit prices have been computed in accordance with paragraph 13.03.A of the General Conditions.

ADDENDUM NO. 2

- B. Bidder acknowledges that estimated quantities are not guaranteed, and are solely for the purpose of comparison of Bids, and final payment for all Unit Price Bid items will be based on actual quantities, determined as provided in the Contract Documents.

ARTICLE 6 – TIME OF COMPLETION

- 6.01 Bidder agrees that the Work will be substantially complete and will be completed and ready for final payment in accordance with Paragraph 15.06 of the General Conditions on or before the dates or within the number of calendar days indicated in the Agreement.
- 6.02 Bidder accepts the provisions of the Agreement as to liquidated damages.

ARTICLE 7 – ATTACHMENTS TO THIS BID

- 7.01 The following documents are submitted with and made a condition of this Bid:
 - A. Bid Opening Requirements

ARTICLE 8 – DEFINED TERMS

- 8.01 The terms used in this Bid with initial capital letters have the meanings stated in the Instructions to Bidders, the General Conditions, and the Supplementary Conditions.

ARTICLE 9 – BID SUBMITTAL

BIDDER: *[Indicate correct name of bidding entity]*

By:
[Signature] _____

[Printed name] _____
(If Bidder is a corporation, a limited liability company, a partnership, or a joint venture, attach evidence of authority to sign.)

Attest:
[Signature] _____

[Printed name] _____

Title: _____

Submittal Date: _____

Address for giving notices:

Telephone Number: _____

Fax Number: _____

Contact Name and e-mail address: _____

Bidder's License No.: _____
(where applicable)

NOTE TO USER: *Use in those states or other jurisdictions where applicable or required.*

SECTION 012000 - PRICE AND PAYMENT PROCEDURES

PART 1 - GENERAL

1.1 RELATED DOCUMENTS

- A. Drawings and general provisions of the Contract Documents, including General and Supplementary Conditions, Division 01, and all related Specification Sections, apply to this Section.

1.2 SECTION INCLUDES

- A. Schedule of Values.
- B. Application for Payment.
- C. Change procedures.
- D. Defect assessment.
- E. Measurement and Payment.
- F. Alternates.

1.3 SCHEDULE OF VALUES

- A. Submit printed schedule on Progress Estimate schedule on EJCDC C-620.
- B. Submit Schedule of Values in duplicate within twenty (20) days after date established in Notice to Proceed.
- C. Format: Identify each line item with number and title of major Specification Section. Contractor shall submit a balanced Schedule of Values. The total value of activities shall equal the identifiable Contract Price. The Schedule of Values shall be accompanied by a proposed cash flow for the duration of the Project. Line items shall be broken down as appropriate and listed as units. Overhead and profit shall be prorated to all the activities.
 - 1. Unless otherwise specified, the Schedule of Values shall include the following percentages for each of the listed activities:
 - a. Mobilization, Bonds, Insurance, and Demobilization: no greater than 5 percent
 - b. As-Built Drawings: no less than 1 percent
 - c. Punchlist: no less than 2 percent
 - d. Final Bound O&M Manuals: no less than 1 percent
 - e. All Spare Parts Values not specifically assigned elsewhere: no less than 0.5 percent
 - f. Testing: no less than 1 percent

2. Schedules whose non-equipment related cash flow exceeds 10 percent of the total Contract amount (exclusive of equipment) in any one (1) month, or 45 percent of the total Contract amount (exclusive of equipment) in any three (3) consecutive months shall be deemed unacceptable and require revision. Exceptions may be granted at the discretion of the Engineer for unusual circumstances or non-routine construction.
3. If, in the opinion of Engineer or Owner, the Schedule of Values is unbalanced, Contractor shall submit documentation substantiating the cost allocations of those activities believed to be unbalanced. No pay requests will be accepted until the Schedule of Values submittals has been marked "No Exceptions Taken" or "Make Corrections Noted" by Engineer.

- D. Include within each line item, direct proportional amount of Contractor's overhead and profit.
- E. Revise schedule to list approved Change Orders with each Application for Payment.

1.4 APPLICATION FOR PAYMENT

- A. Submit five (5) copies of each Application for Payment on EJCDC C-620 – Contractor's Application for Payment.
- B. Content and Format: Use Schedule of Values for listing items in Application for Payment.
- C. Submit updated construction schedule and payment schedule with each Application for Payment.
- D. Payment Period: Submit at intervals stipulated in the Agreement.
- E. Submit submittals with transmittal letter as specified in Section 013300 - Submittal Procedures.
- F. Substantiating Data: When Engineer requires substantiating information, submit data justifying dollar amounts in question. Include the following with Application for Payment:
 1. Current construction photographs
 2. Partial release of Liens from major Subcontractors and vendors.
 3. Record Documents as specified in Section 017000 - Execution and Closeout Requirements, for review by Owner, which will be returned to Contractor.
 4. Affidavits attesting to off-Site stored products.
 5. Construction Progress Schedule, revised and current as specified in Section 013300 - Submittal Procedures.

1.5 CHANGE PROCEDURES

- A. Submittals: Submit name of individual who is authorized to receive change documents and is responsible for informing others in Contractor's employ or Subcontractors of changes to the Work.

- B. Carefully study and compare Contract Documents before proceeding with fabrication and installation of Work. Promptly advise Engineer of any error, inconsistency, omission, or apparent discrepancy.
- C. Requests for Interpretation (RFI) and Clarifications: Allot time in construction scheduling for liaison with Engineer; establish procedures for handling queries and clarifications.
 - 1. Use Request for Information Form for requesting interpretations (provided by Engineer upon request).
 - 2. Engineer may respond with a direct answer on the Request for Information form, separate Engineer Response, EJCDC C-942 - Field Order, or EJCDC C-940 - Work Change Directive Form.
- D. Engineer will advise of minor changes in the Work not involving adjustment to Contract Sum/Price or Contract Time by issuing supplemental instructions on EJCDC C-942.
- E. Engineer may issue Notice of Change including a detailed description of proposed change with supplementary or revised Drawings and Specifications, a change in Contract Time for executing the change with stipulation of overtime Work required and with the period of time during which the requested price will be considered valid. Contractor will prepare and submit estimate within ten (10) days.
- F. Contractor may propose changes by submitting a request for change to Engineer, describing proposed change and its full effect on the Work. Include a statement describing reason for the change and the effect on Contract Sum/Price and Contract Time with full documentation and a statement describing effect on the Work by separate or other Contractors.
- G. Stipulated Sum/Price Change Order: Based on Proposal Request or Work Change Directive and Contractor's maximum price quotation or Contractor's request for Change Order as approved by Engineer.
- H. Unit Price Change Order: For Contract unit prices and quantities, the Change Order will be executed on a fixed unit price basis. For unit costs or quantities of units of that which are not predetermined, execute Work under Work Directive Change. Changes in Contract Sum/Price or Contract Time will be computed as specified for Time and Material Change Order.
- I. Work Change Directive: Engineer may issue directive, on EJCDC C-940 - Work Change Directive, instructing Contractor to proceed with change in the Work, for subsequent inclusion in a Change Order. Document will describe changes in the Work and designate method of determining any change in Contract Sum/Price or Contract Time. Promptly execute change.
- J. Time and Material Change Order: Submit itemized account and supporting data after completion of change, within time limits indicated in Conditions of the Contract. Engineer will determine change allowable in Contract Sum/Price and Contract Time as provided in Contract Documents.
- K. Maintain detailed records of Work done on time and material basis. Provide full information required for evaluation of proposed changes and to substantiate costs for changes in the Work.

- L. Document each quotation for change in Project Cost or Time with sufficient data to allow evaluation of quotation.
- M. Change Order Forms: EJCDC C-941 - Change Order.
- N. Execution of Change Orders: Engineer will issue Change Orders for signatures of parties as provided in Conditions of the Contract.
- O. Correlation of Contractor Submittals:
 - 1. Promptly revise Schedule of Values and Application for Payment forms to record each authorized Change Order as separate line item and adjust Contract Sum/Price.
 - 2. Promptly revise Progress Schedules to reflect change in Contract Time, revise sub-schedules to adjust times for other items of Work affected by the change, and resubmit.
 - 3. Promptly enter changes in Record Documents.

1.6 DEFECT ASSESSMENT

- A. Replace the Work, or portions of the Work, not conforming to specified requirements.
- B. If, in the opinion of Engineer or Owner, it is not practical to remove and replace the Work, Engineer or Owner will direct appropriate remedy or adjust payment.
- C. The defective Work may remain, but unit sum/price will be adjusted to new sum/price at discretion of Owner.
- D. Defective Work will be partially repaired according to instructions of Engineer, and unit sum/price will be adjusted to new sum/price at discretion of Owner.
- E. Individual Specification Sections may modify these options or may identify specific formula or percentage sum/price reduction.
- F. Authority of Owner to assess defects and identify payment adjustments is final.
- G. Nonpayment for Rejected Products: Payment will not be made for rejected products for any of the following reasons:
 - 1. Products wasted or disposed of in a manner that is not acceptable.
 - 2. Products determined as unacceptable before or after placement.
 - 3. Products not completely unloaded from transporting vehicle.
 - 4. Products placed beyond lines and levels of the required Work.
 - 5. Products remaining on hand after completion of the Work.
 - 6. Loading, hauling, and disposing of rejected products.

1.7 MEASUREMENT AND PAYMENT

A. General Requirements

1. Contractor shall take measurements and compute quantities. Resident Project Representative and Engineer will verify measurements and quantities.
2. Unit Quantities: Quantities and measurements indicated on Bid Form are for Contract purposes only. Actual quantities provided shall determine payment.
 - a. When actual Work requires more or fewer quantities than those quantities indicated, provide required quantities at Contracted unit sum/prices.
 - b. When actual Work requires 25 percent or greater change in quantity than those quantities indicated, Owner or Contractor may claim a Contract Price adjustment.
3. Payment Includes: Full compensation for required labor, products, tools, equipment, plant and facilities, transportation, services and incidentals; erection, application, or installation of item of the Work; overhead and profit.
4. Final payment for Work governed by unit prices will be made on basis of actual measurements and quantities accepted by Engineer multiplied by unit sum/price for Work incorporated in or made necessary by the Work.

B. Measurement of Quantities

1. Weigh Scales: Inspected, tested, and certified by applicable West Virginia weights and measures department within past year.
2. Platform Scales: Of sufficient size and capacity to accommodate conveying vehicle.
3. Metering Devices: Inspected, tested, and certified by applicable West Virginia department within past year.
4. Measurement by Weight: Concrete reinforcing steel, rolled or formed steel, or other metal shapes will be measured by handbook weights. Welded assemblies will be measured by handbook or scale weight.
5. Measurement by Volume: Measured by cubic dimension using mean length, width, and height or thickness.
6. Measurement by Area: Measured by square dimension using mean length and width or radius.
7. Linear Measurement: Measured by linear dimension, at item centerline or mean chord.
8. Stipulated Sum/Price Measurement: Items measured by weight, volume, area, or linear means or combination, as appropriate, as completed item or unit of the Work.

C. Unit Price Schedule:

1. Bid Item 1 – Mobilization/Demobilization
 - a. This Bid item shall include all costs associated with the performance of construction preparatory operations including, but not limited to, the movement of equipment and personnel to and from the Project Site; establishing and decommissioning the Field Office, storage buildings, and other facilities necessary to conduct Work under this Contract; payment of all bonding costs incurred by the

Contractor; all materials and equipment required for unloading and reloading; and all costs associated with demobilization.

- b. This Bid Item shall also include all costs associated with installing, maintaining, and removing the Project Sign.
 - c. This Bid Item shall also include any and all costs associated with the following Specification Sections:
 - 1) Section 012600 – Contract Modification Procedures
 - 2) Section 013000 – Administrative Requirements
 - 3) Section 013216 – Construction Progress Schedule
 - 4) Section 013300 – Submittal Procedures
 - 5) Section 015000 – Temporary Facilities and Controls
 - 6) Section 017000 – Execution and Closeout Requirements
 - 7) Section 017839 – Project Record Documents
 - d. Payment shall be made at the lump sum (LS) price Bid for Mobilization/Demobilization, but in no case shall the total lump sum Bid Price exceed 5% of the total Bid.
 - e. Partial Payments of the lump sum Bid amount for mobilization/demobilization shall be as follows:
 - 1) One-fourth of the amount Bid for Mobilization/Demobilization can be paid to the Contractor at the first estimate payable.
 - 2) The second one-fourth of the amount Bid for Mobilization/Demobilization can be paid with the second estimate payable.
 - 3) The third one-fourth of the amount Bid for Mobilization/Demobilization can be paid with the third estimate payable.
 - 4) The final one-fourth of the amount Bid for Mobilization/Demobilization shall be paid with the final payment.
 - 5) No reduction, nor increase, will be made in the lump sum amount regardless of decreases or increases in the final total Contract amount or for any other cause.
2. Bid Item 2 – Erosion and Sedimentation Controls – Section 312500
- a. The cost for this Work shall be a lump sum.
 - b. This Bid item shall include all costs associated with erosion and sedimentation controls including all materials and labor for installation, maintenance, and removal.
 - c. The cost of this Work shall be paid for at the lump sum Bid price for all erosion and sedimentation controls at all locations directly and/or indirectly disturbed by the Work.
3. Bid Item 3 –Videotaping of Project Area
- a. This Bid Item shall include any and all costs associated with following Specification Section 020100 – Video Recording

- b. The cost of this work shall be included in a lump sum bid item. Such payment shall constitute full compensation for labor, materials, equipment and other cost associated to provide a complete documentation.
 - c. Videotaping shall include the entire construction area affected, including any Contractor secured waste site and material storage or staging areas. The measurement for this bid items shall be based on a complete video recording on a DVD of the entire project area.
4. Bid Item 4 – Temporary Bypass Pumping – Section 330600
 - a. The cost for this Work shall be a lump sum.
 - b. This Bid item shall include all costs associated with temporarily bypassing sewer flows around sections of the Work including, but not limited to, pumps, piping, plugs, and all other appurtenances, as well as installing, operating, maintaining, relocating, and removing the temporary bypass pump system.
5. Bid Item 5 - 8" PVC SDR-35 Gravity Sewer Line Remove and Replace (0'-6')
 - a. This Bid Item shall include all required labor, materials, equipment and all other costs associated with the complete installation of 8-inch PVC SDR-35 Gravity Sewer Line including, but not limited to, excavation, bedding, backfill, materials, fittings, pipe joints, pipe, tools, supplies, testing, and incidentals. All fittings used shall be included in the linear foot price of the pipe.
 - b. The sewers installed under this item shall be measured and paid for at the unit price Bid per linear foot of pipe of each type and size as specified on Drawings or as directed by the Engineer, and installed complete in place. The measurement under this item shall be the length of pipe and fittings as installed in place and accepted and shall be measured in the horizontal plane along the centerline of each pipe installed, measured from the face of manhole to face of manhole.
 - c. Depths of excavation required to install the pipe shall be measured from existing ground elevation to the invert of the proposed pipe and shall be paid for at the unit price Bid Item per linear foot of pipe.
6. Bid Item 6 - 8" PVC SDR-35 Gravity Sewer Line Remove and Replace (6'-9')
 - a. This Bid Item shall include all required labor, materials, equipment and all other costs associated with the complete installation of 8-inch PVC SDR-35 Gravity Sewer Line including, but not limited to, excavation, bedding, backfill, materials, fittings, pipe joints, pipe, tools, supplies, testing, and incidentals. All fittings used shall be included in the linear foot price of the pipe.
 - b. The sewers installed under this item shall be measured and paid for at the unit price Bid per linear foot of pipe of each type and size as specified on Drawings or as directed by the Engineer, and installed complete in place. The measurement under this item shall be the length of pipe and fittings as installed in place and accepted and shall be measured in the horizontal plane along the centerline of each pipe installed, measured from the face of manhole to face of manhole.
 - c. Depths of excavation required to install the pipe shall be measured from existing ground elevation to the invert of the proposed pipe and shall be paid for at the unit price Bid Item per linear foot of pipe.

7. Bid Item 7 - 8" PVC SDR-35 Gravity Sewer Line Remove and Replace (9'-12')
 - a. This Bid Item shall include all required labor, materials, equipment and all other costs associated with the complete installation of 8-inch PVC SDR-35 Gravity Sewer Line including, but not limited to, excavation, bedding, backfill, materials, fittings, pipe joints, pipe, tools, supplies, testing, and incidentals. All fittings used shall be included in the linear foot price of the pipe.
 - b. The sewers installed under this item shall be measured and paid for at the unit price Bid per linear foot of pipe of each type and size as specified on Drawings or as directed by the Engineer, and installed complete in place. The measurement under this item shall be the length of pipe and fittings as installed in place and accepted and shall be measured in the horizontal plane along the centerline of each pipe installed, measured from the face of manhole to face of manhole.
 - c. Depths of excavation required to install the pipe shall be measured from existing ground elevation to the invert of the proposed pipe and shall be paid for at the unit price Bid Item per linear foot of pipe.

8. Bid Item 8 - 8" PVC SDR-35 Gravity Sewer Line Remove and Replace (12+')

 - a. This Bid Item shall include all required labor, materials, equipment and all other costs associated with the complete installation of 8-inch PVC SDR-35 Gravity Sewer Line including, but not limited to, excavation, bedding, backfill, materials, fittings, pipe joints, pipe, tools, supplies, testing, and incidentals. All fittings used shall be included in the linear foot price of the pipe.
 - b. The sewers installed under this item shall be measured and paid for at the unit price Bid per linear foot of pipe of each type and size as specified on Drawings or as directed by the Engineer, and installed complete in place. The measurement under this item shall be the length of pipe and fittings as installed in place and accepted and shall be measured in the horizontal plane along the centerline of each pipe installed, measured from the face of manhole to face of manhole.
 - c. Depths of excavation required to install the pipe shall be measured from existing ground elevation to the invert of the proposed pipe and shall be paid for at the unit price Bid Item per linear foot of pipe.

9. Bid Item 9 - 4" PVC SDR-35 Service Lateral Pipe (Remove and Replace)
 - a. The pipe installed under this item shall be measured and paid for by the linear feet of pipe installed complete in place. The measurements under this item shall be the length of pipe and fittings installed in place and accepted and shall be measured in the horizontal plane along the centerline of pipe installed, measured centerline of tie-in to centerline of cleanout.
 - b. The quantities determined as provided above will be paid for at the unit price Bid, which shall be full compensation for excavation, bedding, backfilling, pavement restoration, gravel restoration, concrete sidewalk repair, curb and gutter repair, misc. landscape restoration and all other necessary appurtenances to complete the connection. Furnishing all materials and doing all the work herein prescribed in a workmanlike and acceptable manner, including all labor, tools, equipment, supplies, testing and incidentals necessary to complete the work.

- c. Fittings, whether used in ductile iron or PVC, will be paid for as part of linear foot of pipe.
10. Bid Item 10 – Reconnect Existing Sewer Customer
 - a. This Bid Item shall include all costs associated with reconnecting existing sewer customers to the new laterals as shown on the Drawings.
 - b. The Bid Item shall include, but not be limited to, costs such as labor and materials required, fittings, and incidental pipe to make the proper connection.
11. Bid Item 11 – 18” HDPE Storm Drain (0’-6’)
 - a. This Bid item shall include all required labor, materials, equipment and all other costs associated with the complete installation of 18-inch HDPE Storm Drain including excavation, bedding, backfill, materials, welds, pipe, tools, supplies, testing, and incidentals. All appurtenances used shall be included in the linear foot price of the pipe.
 - b. The pipe installed under this item shall be measured and paid for at the unit price Bid per linear feet of pipe of each type and size as specified on Drawings or as directed by the Engineer, and installed complete in place. The measurement under this item shall be the length of pipe as installed in place and accepted and shall be measured in the horizontal plane along the centerline of each pipe installed, measured from the face of drop inlet to drop inlet.
 - c. Depths of excavation required to install the pipe shall be measured from existing ground elevation to the invert of the proposed pipe and shall be paid for at the unit price Bid Item per linear foot of pipe.
12. Bid Item 12 – 18” HDPE Storm Drain (6’-9’)
 - a. This Bid item shall include all required labor, materials, equipment and all other costs associated with the complete installation of 18-inch HDPE Storm Drain including excavation, bedding, backfill, materials, welds, pipe, tools, supplies, testing, and incidentals. All appurtenances used shall be included in the linear foot price of the pipe.
 - b. The pipe installed under this item shall be measured and paid for at the unit price Bid per linear feet of pipe of each type and size as specified on Drawings or as directed by the Engineer, and installed complete in place. The measurement under this item shall be the length of pipe as installed in place and accepted and shall be measured in the horizontal plane along the centerline of each pipe installed, measured from the face of drop inlet to drop inlet.
 - c. Depths of excavation required to install the pipe shall be measured from the top of existing ground elevation to the invert of the pipe and shall be paid for at the unit price Bid Item per linear foot of pipe.
13. Bid Item 13 - 48” Diameter Manhole Base, Cone Top, Regular Casting Remove and Replace
 - a. This Bid item shall include all required labor, materials, equipment and all other costs associated with excavation and backfill, installation of 48-inch pre-cast manhole, and other appurtenances.

- b. Payment for manholes shall be as follows:
 - 1) Gravel sub-base, manhole base, steps, cone top, frame, and cover (water tight where indicated), up to 6-foot depth measured from invert out elevation to top of cover elevation, shall be paid at the Contract unit Bid price per each.
 - 2) Manhole riser piping of specified inside diameter required for additional depth over 6 feet shall be paid for at the unit Bid price per vertical foot for Precast Manhole Riser Pipe.
 - 3) Payment for internal drop connectors, as required, for manhole construction shall be included in the unit Bid price for each new manhole installed.

- 14. Bid Item 14 – 48” Diameter Manhole Riser Pipe
 - a. Riser section required for depths over 6 feet will be measured and paid for by the unit Bid price per vertical foot.
 - b. Manhole base, cone top, frame and cover, complete in place to a depth of 6 feet, shall be paid for by the unit Bid price per each for Manholes.

- 15. Bid Item 15 – 8” x 4” PVC Wye Connection
 - a. 8” x 4” PVC Wye Connections shall include the purchase and installation of all required material to construct the 8” x 4” Wye Connection and customer service lateral cleanout as detailed on the Drawings.
 - b. Payment for this Bid Item shall include the purchase and installation of all required material in order to perform the installation as shown. This Unit Bid Price shall include the location and excavation of utilities, all required piping, fittings, bedding, backfilling, etc.

- 16. Bid Item 16 – 4’ x 4’ Precast D.I. Drop Inlet
 - a. This Bid item shall include all required labor, materials, equipment and all other costs associated with excavation and backfill, installation of 4’ x 4’ D.I. pre-cast drop inlet, and other appurtenances.
 - b. Payment for drop inlets shall be as follows:
 - 1) Gravel sub-base, precast D.I. structure, inlet frame, and grate, shall be paid at the Contract unit Bid price per each.
 - 2) Payment for internal drop connectors, as required, for D.I. construction shall be included in the unit Bid price for each new D.I. installed.

- 17. Bid Item 17 – Concrete Driveway Repair
 - a. This Bid item shall include all required labor, materials, equipment and all other costs associated with concrete driveway restoration. All costs required for traffic control shall be included in the unit price. Driveway repairs shall be paid for by the linear foot, without regard to width, times the Bid price. No payment shall be made

for driveway repair outside the limits shown on the Contract Documents. No payment will be made for temporary paving required during construction. All driveway repair Work shall be included in this linear foot Bid Price.

- b. Payment shall be based on horizontal linear footage of driveway repair as determined by the Contractor and confirmed by the Engineer. The Engineer has final authority for measured quantity.

18. Bid Item 18 – Gravel Driveway Repair

- a. This Bid item shall include all required labor, materials, equipment and all other costs associated with gravel driveway restoration. All costs required for traffic control shall be included in the unit price. Driveway repairs shall be paid for by the linear foot, without regard to width, times the Bid price. No payment shall be made for driveway repair outside the limits shown on the Contract Documents. No payment will be made for temporary paving required during construction. All driveway repair Work shall be included in this linear foot Bid Price.

- b. Payment shall be based on horizontal linear footage of driveway repair as determined by the Contractor and confirmed by the Engineer. The Engineer has final authority for measured quantity.

19. Bid Item 19 – HMA Driveway Repair

- a. This Bid item shall include all required labor, materials, equipment and all other costs associated with HMA driveway restoration. All costs required for traffic control shall be included in the unit price. Driveway repairs shall be paid for by the linear foot, without regard to width, times the Bid price. No payment shall be made for driveway repair outside the limits shown on the Contract Documents. No payment will be made for temporary paving required during construction. All driveway repair Work shall be included in this linear foot Bid Price.

- b. Payment shall be based on horizontal linear footage of driveway repair as determined by the Contractor and confirmed by the Engineer. The Engineer has final authority for measured quantity.

20. Bid Item 20 – Reinforced Concrete Headwall

- a. This Bid item shall include all required labor, materials, equipment and all other costs associated with excavation and backfill, installation of reinforced concrete headwall and other appurtenances.

- b. Payment for reinforced concrete headwall shall be as follows:

- 1) Gravel sub-base and precast reinforced headwall structure shall be paid at the Contract unit Bid price per each.

21. Bid Item 21 – Rip-Rap Lined Channel

- a. This Bid item shall include all required labor, materials, equipment and all other costs associated with the installation of the Rip-Rap Lined Channel as shown on the drawings.

- b. Payment for this Bid item shall be based on the linear foot of material installed to the width and depth shown on the drawings.
22. Bid Item 22 – Reconnect Existing Sewer Line to Proposed Manhole
- a. This Bid Item shall include all costs associated with connecting the existing sewer to the proposed manholes as shown on the Drawings.
 - b. The Bid Item shall include, but not be limited to, costs such as labor and materials required, fittings and incidental pipe, to make the proper connection.
23. Bid Item 23 – WVDOH Type “A” Trench Repair
- a. This Bid item shall include all required labor, materials, equipment and all other costs associated with the type of trench repair within the WV Division of Highways Right-of-Way as shown on the Drawings or as directed by the Engineer, and installed complete in place. All costs associated with traffic control shall be included in the unit price. Trench repairs shall be paid for by the linear foot, without regard to width, times the Bid price. No payment shall be made for trench repair outside the limits shown on the Contract Documents.
 - b. Payment shall be based on horizontal linear footage of trench repair as determined by the Contractor and confirmed by the Engineer. The Engineer has final authority for measured quantity.
24. Bid Item 24 – WVDOH Type “C” Trench Repair
- a. This Bid item shall include all required labor, materials, equipment and all other costs associated with the type of trench repair within the WV Division of Highways Right-of-Way as shown on the Drawings or as directed by the Engineer, and installed complete in place. All costs associated with traffic control shall be included in the unit price. Trench repairs shall be paid for by the linear foot, without regard to width, times the Bid price. No payment shall be made for trench repair outside the limits shown on the Contract Documents.
 - b. Payment shall be based on horizontal linear footage of trench repair as determined by the Contractor and confirmed by the Engineer. The Engineer has final authority for measured quantity.
25. Bid Item 25 – 2” HMA Overlay
- a. This Bid Item shall be paid for on a linear foot basis measured along the center line of the pipe or length of paved area disturbed as shown on the plans or directed by the Engineer. All labor and material including purchase, delivery, surface preparation including milling of any and all asphalt and installation of asphalt shall be included in the price.
 - b. Width shall not be considered. The Contractor shall repair all pavement disturbed as determined by the Engineer or his representative. Pavement disturbed by the Contractor where pipe line was not installed shall be replaced at the Contractor’s expense.
 - c. All areas of pavement disturbed due to any of the Contractor’s operations which are not along the centerline of the pipe shall also be satisfactorily repaired, at no additional cost to the Owner.

- d. Straight, perpendicular saw cuts between the existing asphalt or concrete surfaces shall be included in this work.
 - e. Payment for footages that have less than the excavation width shall be prorated per linear foot.
 - f. Payment for overlay shall include all required stripes and painting.
26. Bid Item 26 – MH #3 Rehabilitation
- a. This Bid Item shall include all work associated with the rehabilitation of existing manhole structures as shown on the Drawings.
 - b. Measurement and payment for this Bid item shall be based on the Bid price per each for rehabilitation.
27. Bid Item 27 – MH #4 Rehabilitation
- a. This Bid Item shall include all work associated with the rehabilitation of existing manhole structures as shown on the Drawings.
 - b. Measurement and payment for this Bid item shall be based on the Bid price per each for rehabilitation.
28. Bid Item 28 – MH #A Rehabilitation
- a. This Bid Item shall include all work associated with the rehabilitation of existing manhole structures as shown on the Drawings.
 - b. Measurement and payment for this Bid item shall be based on the Bid price per each for rehabilitation.
29. Bid Item 29 – MH #15 Rehabilitation
- a. This Bid Item shall include all work associated with the rehabilitation of existing manhole structures as shown on the Drawings.
 - b. Measurement and payment for this Bid item shall be based on the Bid price per each for rehabilitation.
30. Bid Item 30 – MH #11 Rehabilitation
- a. This Bid Item shall include all work associated with the rehabilitation of existing manhole structures as shown on the Drawings.
 - b. Measurement and payment for this Bid item shall be based on the Bid price per each for rehabilitation.
31. Bid Item 31 – MH #10A Rehabilitation
- a. This Bid Item shall include all work associated with the rehabilitation of existing manhole structures as shown on the Drawings.
 - b. Measurement and payment for this Bid item shall be based on the Bid price per each for rehabilitation.

32. Bid Item 32 – MH #16 Rehabilitation
 - a. This Bid Item shall include all work associated with the rehabilitation of existing manhole structures as shown on the Drawings.
 - b. Measurement and payment for this Bid item shall be based on the Bid price per each for rehabilitation.

33. Bid Item 33 – MH #106 Rehabilitation
 - a. This Bid Item shall include all work associated with the rehabilitation of existing manhole structures as shown on the Drawings.
 - b. Measurement and payment for this Bid item shall be based on the Bid price per each for rehabilitation.

34. Bid Item 34 – MH #96 Rehabilitation
 - a. This Bid Item shall include all work associated with the rehabilitation of existing manhole structures as shown on the Drawings.
 - b. Measurement and payment for this Bid item shall be based on the Bid price per each for rehabilitation.

35. Bid Item 35 – MH #50 Rehabilitation
 - a. This Bid Item shall include all work associated with the rehabilitation of existing manhole structures as shown on the Drawings.
 - b. Measurement and payment for this Bid item shall be based on the Bid price per each for rehabilitation.

36. Bid Item 36 – MH #DOH Rehabilitation
 - a. This Bid Item shall include all work associated with the rehabilitation of existing manhole structures as shown on the Drawings.
 - b. Measurement and payment for this Bid item shall be based on the Bid price per each for rehabilitation.

37. Bid Item 37 – MH #88 Rehabilitation
 - a. This Bid Item shall include all work associated with the rehabilitation of existing manhole structures as shown on the Drawings.
 - b. Measurement and payment for this Bid item shall be based on the Bid price per each for rehabilitation.

38. Bid Item 38 – MH #B Rehabilitation
 - a. This Bid Item shall include all work associated with the rehabilitation of existing manhole structures as shown on the Drawings.
 - b. Measurement and payment for this Bid item shall be based on the Bid price per each for rehabilitation.

39. Bid Item 39 – MH #72 Rehabilitation
 - a. This Bid Item shall include all work associated with the rehabilitation of existing manhole structures as shown on the Drawings.
 - b. Measurement and payment for this Bid item shall be based on the Bid price per each for rehabilitation.

40. Bid Item 40 – MH #C Rehabilitation
 - a. This Bid Item shall include all work associated with the rehabilitation of existing manhole structures as shown on the Drawings.
 - b. Measurement and payment for this Bid item shall be based on the Bid price per each for rehabilitation.

41. Bid Item 41 – MH #D Rehabilitation
 - a. This Bid Item shall include all work associated with the rehabilitation of existing manhole structures as shown on the Drawings.
 - b. Measurement and payment for this Bid item shall be based on the Bid price per each for rehabilitation.

42. Bid Item 42 – MH #32 Rehabilitation
 - a. This Bid Item shall include all work associated with the rehabilitation of existing manhole structures as shown on the Drawings.
 - b. Measurement and payment for this Bid item shall be based on the Bid price per each for rehabilitation.

43. Bid Item 43 – MH #110 Rehabilitation
 - a. This Bid Item shall include all work associated with the rehabilitation of existing manhole structures as shown on the Drawings.
 - b. Measurement and payment for this Bid item shall be based on the Bid price per each for rehabilitation.

44. Bid Item 44– MH #109 Rehabilitation
 - a. This Bid Item shall include all work associated with the rehabilitation of existing manhole structures as shown on the Drawings.
 - b. Measurement and payment for this Bid item shall be based on the Bid price per each for rehabilitation.

45. Bid Item 45 – MH #89 Rehabilitation
 - a. This Bid Item shall include all work associated with the rehabilitation of existing manhole structures as shown on the Drawings.
 - b. Measurement and payment for this Bid item shall be based on the Bid price per each for rehabilitation.

46. Bid Item 46 – MH #E Rehabilitation
 - a. This Bid Item shall include all work associated with the rehabilitation of existing manhole structures as shown on the Drawings.
 - b. Measurement and payment for this Bid item shall be based on the Bid price per each for rehabilitation.

47. Bid Item 47 – MH #F Rehabilitation
 - a. This Bid Item shall include all work associated with the rehabilitation of existing manhole structures as shown on the Drawings.
 - b. Measurement and payment for this Bid item shall be based on the Bid price per each for rehabilitation.

48. Bid Item 48 – MH #G Rehabilitation
 - a. This Bid Item shall include all work associated with the rehabilitation of existing manhole structures as shown on the Drawings.
 - b. Measurement and payment for this Bid item shall be based on the Bid price per each for rehabilitation.

49. Bid Item 49 – MH #133 Rehabilitation
 - a. This Bid Item shall include all work associated with the rehabilitation of existing manhole structures as shown on the Drawings.
 - b. Measurement and payment for this Bid item shall be based on the Bid price per each for rehabilitation.

50. Bid Item 50 – MH #125 Rehabilitation
 - a. This Bid Item shall include all work associated with the rehabilitation of existing manhole structures as shown on the Drawings.
 - b. Measurement and payment for this Bid item shall be based on the Bid price per each for rehabilitation.

51. Bid Item 51 – MH #124 Rehabilitation
 - a. This Bid Item shall include all work associated with the rehabilitation of existing manhole structures as shown on the Drawings.
 - b. Measurement and payment for this Bid item shall be based on the Bid price per each for rehabilitation.

52. Bid Item 52 – MH #112 Rehabilitation
 - a. This Bid Item shall include all work associated with the rehabilitation of existing manhole structures as shown on the Drawings.

- b. Measurement and payment for this Bid item shall be based on the Bid price per each for rehabilitation.
53. Bid Item 53 – MH #17 Rehabilitation
- a. This Bid Item shall include all work associated with the rehabilitation of existing manhole structures as shown on the Drawings.
 - b. Measurement and payment for this Bid item shall be based on the Bid price per each for rehabilitation.
54. Bid Item 54 – MH #28 Rehabilitation
- a. This Bid Item shall include all work associated with the rehabilitation of existing manhole structures as shown on the Drawings.
 - b. Measurement and payment for this Bid item shall be based on the Bid price per each for rehabilitation.
55. Bid Item 55 – MH #119 Rehabilitation
- a. This Bid Item shall include all work associated with the rehabilitation of existing manhole structures as shown on the Drawings.
 - b. Measurement and payment for this Bid item shall be based on the Bid price per each for rehabilitation.
56. Bid Item 56 – Franklin Street Lift Station Improvements
- a. Measurement and payment for this bid item shall be based on the approved Schedule of Values, as provided by Contractor.
 - b. This Bid Item shall include all costs associated with furnishing a complete, in-place, working sewage pumping station, as detailed in the Drawings and Specifications, including, but not limited to, gravel surfacing, fencing, site lighting, control panel structure, pumps, motors, drives, controls, guide rails, lifting chains, anchors, level control system, piping, valves, fittings, wet well, valve vault, access hatches, hoist assembly, electrical conduit and wiring, and all other associated appurtenances.
 - c. This Bid Item shall also include all costs associated with the following Specification Sections relating to Work of this Bid Item:
 - 1) Section 333216 – Utility Wastewater Pumping Stations
 - 2) Section 017823 – Operation and Maintenance Data
 - 3) Section 019100 – Commissioning
57. Bid Item 57 – Little Kanawha Lift Station Improvements
- a. Measurement and payment for this bid item shall be based on the approved Schedule of Values, as provided by Contractor.

- b. This Bid Item shall include all costs associated with furnishing a complete, in-place, working sewage pumping station, as detailed in the Drawings and Specifications, including, but not limited to, gravel surfacing, fencing, site lighting, control panel structure, pumps, motors, drives, controls, guide rails, lifting chains, anchors, level control system, piping, valves, fittings, wet well, valve vault, access hatches, hoist assembly, electrical conduit and wiring, generator, and all other associated appurtenances.
- c. This Bid Item shall also include all costs associated with the following Specification Sections relating to Work of this Bid Item:
 - 1) Section 333216.10 – Utility Wastewater Pumping Stations
 - 2) Section 017823 – Operation and Maintenance Data
 - 3) Section 019100 – Commissioning

58. Bid Item 58 – WVDOH Inspection Fee Allowance

- a. This Bid Item is to include all cost associated with the inspection fee required by the West Virginia Division of Highways for the project. The inspection fee is \$17,220.70.
- b. The costs associated with this fee shall be in accordance with General Conditions Article 13. The \$17,220.70 fee shall be based on the per linear foot cost of the sewer line installed in the WVDOH right-of-way to cover all WVDOH inspection costs. This bid item specifically excludes any work shown on the contract documents. All work within the Contract Documents shall be included in previous bit items.

59. Bid Item 59 – This bid item is to include providing all labor, equipment, materials, and services to provide capital improvements required by the electric company to provide adequate electrical service to the project site including additional power poles, transformers, meters, cable and/or conduit and other electrical accessories for the allowance amount of Fifteen \$15,000.00.

- a. The costs associated with this allowance shall be in accordance with General Conditions Article 13. The \$15,000.00 allowance shall cover any additional requirements of the electric company during the coordination of this project. This bid item specifically excludes any work shown on the contract documents. All work within the Contract Documents shall be included in previous bid items.

PART 2 - PRODUCTS (Not Used)

PART 3 - EXECUTION (Not Used)

END OF SECTION 012000

STREET, ROAD, AND DRIVEWAY REPAIR NOT IN WVDOH RIGHTS OF WAY

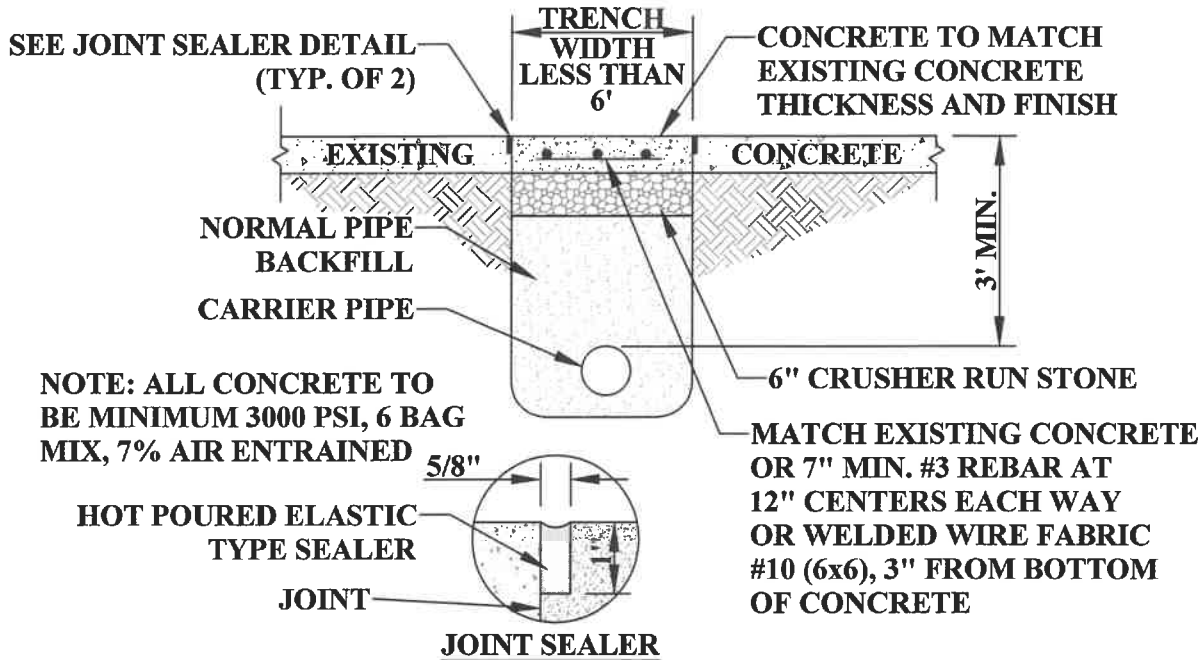

CONCRETE PAVEMENT NOT TO SCALE

STREET, ROAD, AND DRIVEWAY REPAIR NOT IN WVDOH RIGHTS OF WAY

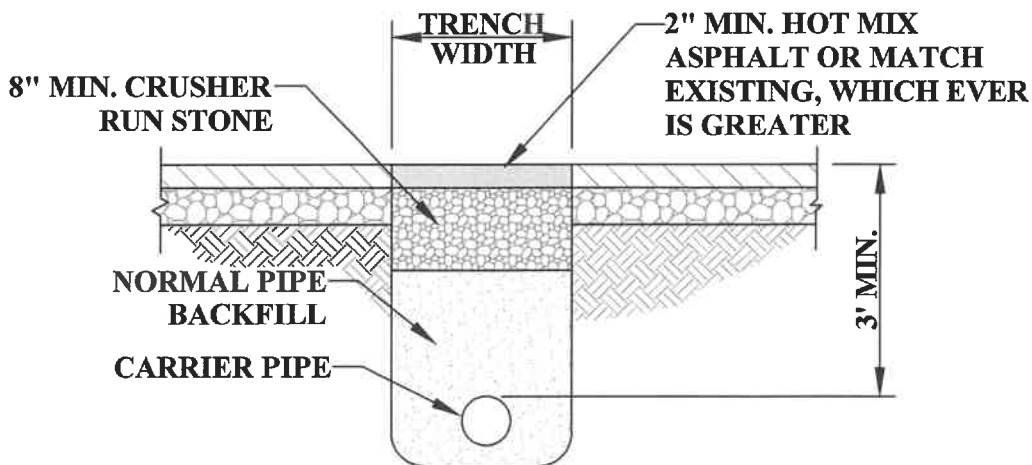

ASPHALT PAVEMENT NOT TO SCALE

ADDENDUM #2

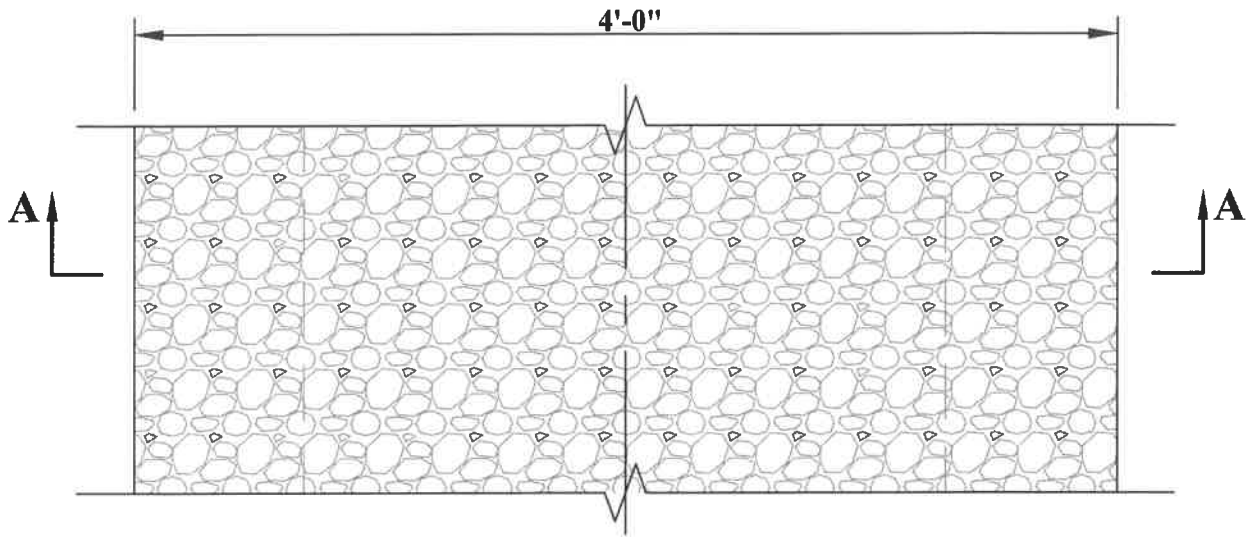

PLAN VIEW

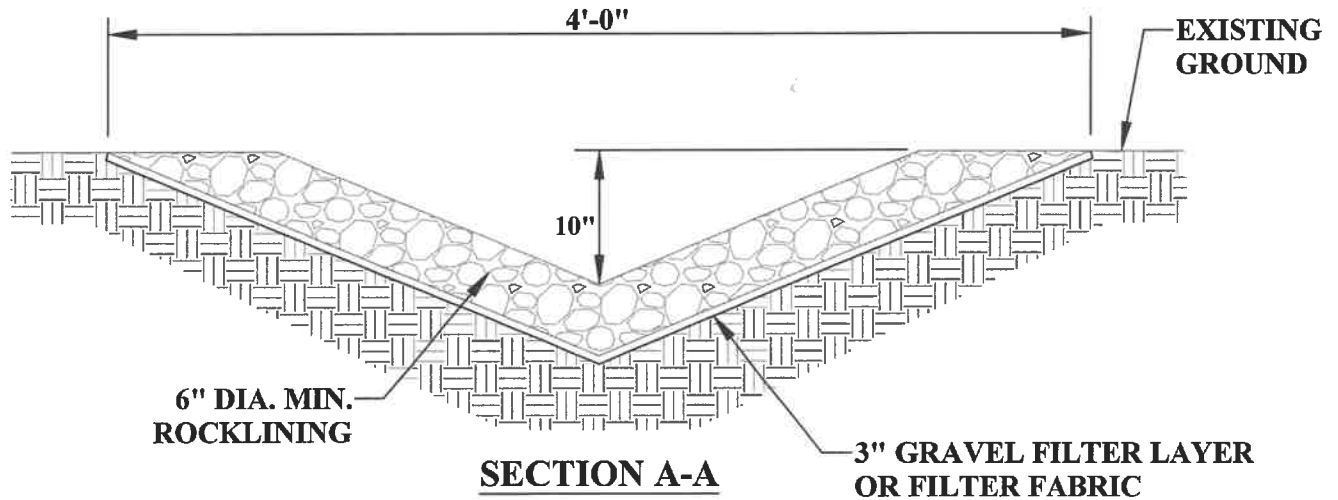

SECTION A-A

NOTES:

1. ROCKLINING TO BE INSTALLED TO FORM A STABLE STRUCTURE WITH A MINIMUM OF VOIDS, AND EACH PLACED IN CONTACT WITH ADJACENT ROCKS.
2. ROCKLINING SHALL BE SOUND, DENCE AND DURABLE ANGULAR ROCK WITH A MINIMUM SPECIFIC GRAVITY OF 2.6.
3. IF A GRAVEL FILTER LAYER IS SUBSTITUTED FOR FILTER FABRIC, MATERIAL SHALL BE A MIXTURE OF CLEAN, WASHED SAND AND GRAVEL, COMPRISED OF MATERIAL LESS THAN 1 1/2" DIA. IN SIZE.
4. CHECK DAMS MAY BE INSTALLED IN ROCK LINED SWALE DEPENDING UPON APPLICATION AND SITE CONDITIONS.

RIP-RAP LINED CHANNEL

NOT TO SCALE

ADDENDUM #2

**TOWN OF ELIZABETH
SUPPLEMENTAL DETAIL SHEET 2**

THRASHER

NOTE: 1) EXISTING LATERAL LINE LOCATIONS SHOWN ARE APPROXIMATE AND WERE DETERMINED FROM AS-BUILT DRAWINGS AND INFORMATION PROVIDED BY THE TOWN.
 2) STREETS AND SIDEWALKS DISTURBED BY THE INSTALLATION OF SERVICE LATERALS SHALL BE REPAIRED.

DISTRICT:
 ELIZABETH CORP.
 TAX MAP:
 02 & 03

USER: Jason Fisher
 LAYOUT: 2
 PLOT DATE/TIME: 10/31/2019 11:49 AM
 CAD FILE: R:\020-1550 PHASE II SEWER-TOWN OF ELIZABETH-V\Drawing\004-Sheet_02.dwg

GENERAL NOTES:

- CONTRACTOR SHALL MAINTAIN A TEMPORARY BYPASS PUMPING SYSTEM FOR THE DURATION OF THE REMOVAL AND REPLACEMENT PROJECT.
- ALL EXISTING CUSTOMERS SHALL BE RECONNECTED AS SHOWN, AND REQUIRED BY CUSTOMER SERVICE LATERAL DETAIL SHOWN ON SHEET DET-1.

LEGEND

 WVDOH TYPE "A" TRENCH REPAIR FOR LATERALS CROSSING ROAD, 2" FULL WIDTH HMA OVERLAY SHALL INCLUDE COMPLETE ROTOMILLING (2" DEEP) FOR ENTIRE OVERLAID AREA.

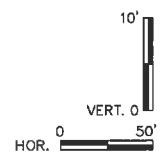
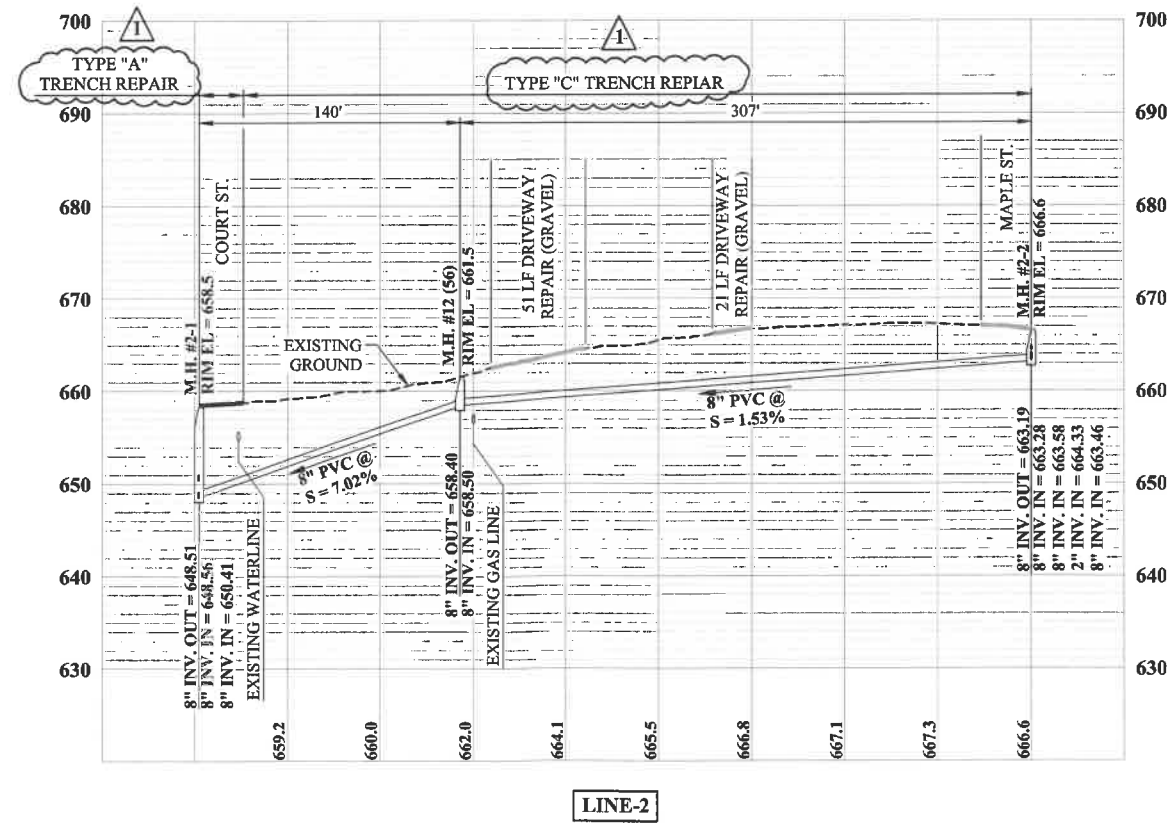
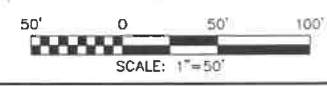
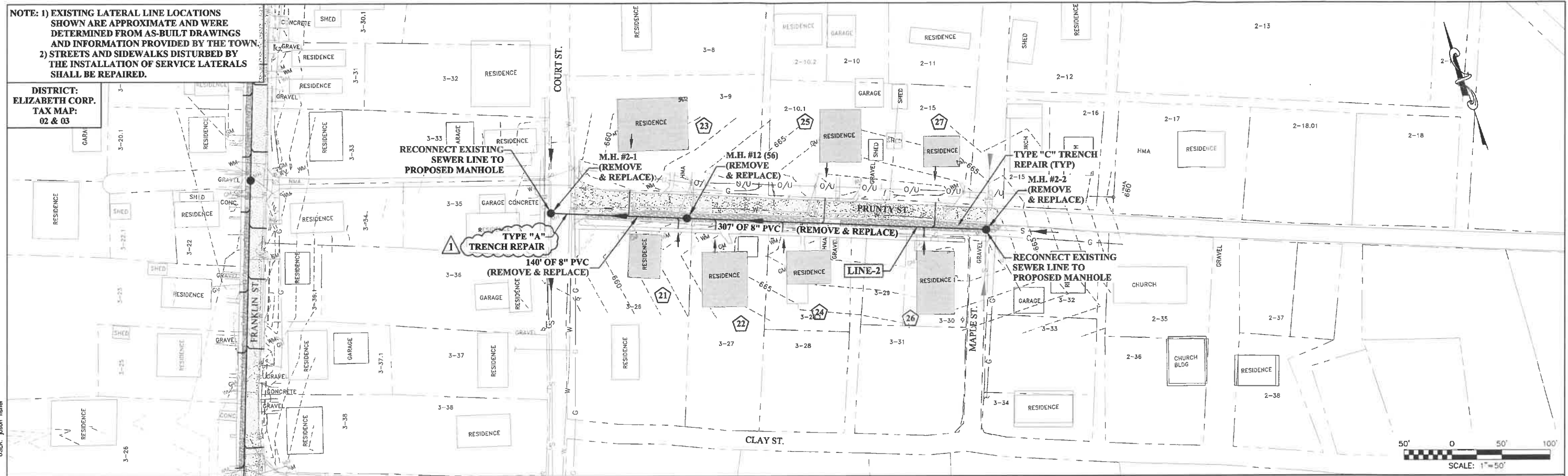

ADDENDUM #2

TOWN OF ELIZABETH
 WIRT COUNTY, WEST VIRGINIA
 SANITARY SEWER SYSTEM IMPROVEMENTS
 PLAN & PROFILE

SHEET No.

2

SCALE: 1" = 50'
 DRAWN: J. FISHER DATE: 5/2018
 CHECKED: R. BOUSTANY DATE: 5/2018
 APPROVED: J. ALDEN DATE: 5/2018
 SURVEY DATE:
 SURVEY BY:
 FIELD BOOK No.:

THRASHER
 300 ASSOCIATION DRIVE
 CHARLESTON, WV 25311
 www.thrashereng.com
 PHONE (304)-343-7601 FAX (304)-343-7604

PHASE No.	2
CONTRACT No.	1
PROJECT No.	020-1550

THE INFORMATION CONTAINED HEREIN IS THE SOLE PROPERTY OF THE THRASHER GROUP, INC. REPRODUCTION OF THESE DOCUMENTS IN WHOLE OR IN PART, FOR ANY REASON WITHOUT PRIOR WRITTEN PERMISSION, IS STRICTLY PROHIBITED. COPYRIGHT © 2019 THE THRASHER GROUP, INC.

NO.	BY	DATE	DESCRIPTION
1	JRF	11/01/19	ADDENDUM #2

KEY NOTES:

1. CONTRACTOR SHALL INSTALL DOGHOUSE MANHOLE PRIOR TO ALL OTHER CONSTRUCTION ACTIVITIES. ALL EXISTING PIPES AND INVERT ELEVATIONS SHALL BE FIELD VERIFIED PRIOR TO CONSTRUCTION. THIS INFORMATION SHALL BE PROVIDED TO THE ENGINEER ONCE NEW MANHOLE IS COMPLETE. SEE DETAIL SHEET DET-1 FOR MANHOLE DETAILS. PLUG EXISTING 8" PIPE IN THE EXISTING MANHOLE AND UTILIZE FOR TEMPORARY BYPASS PUMPING. CONTRACTOR SHALL FURNISH AND MAINTAIN A TEMPORARY BYPASS PUMPING SYSTEM FOR THE DURATION OF CONSTRUCTION. BYPASS PUMPING REQUIREMENTS SHALL MATCH PROPOSED EQUIPMENT.
2. CONTRACTOR SHALL REMOVE EXISTING LIFT STATION EQUIPMENT. SEE SHEET LS-3 FOR DETAILS.
3. CONTRACTOR SHALL REMOVE EXISTING ELECTRICAL CONTROLS. OWNER SHALL HAVE THE OPPORTUNITY TO SALVAGE SELECT COMPONENTS PRIOR TO ANY DISPOSAL. SEE ELECTRICAL SHEETS FOR ADDITIONAL INFORMATION.
4. CONTRACTOR SHALL REMOVE EXISTING WET WELL STRUCTURE. SEE SHEET LS-3 FOR DETAILS.
5. CONTRACTOR SHALL DEMOLISH EXISTING CHAIN LINK FENCE.
6. CONTRACTOR SHALL DEMOLISH AND REMOVE EXISTING CONCRETE PAD.
7. CONTRACTOR SHALL REMOVE UNDERGROUND ELECTRIC CONNECTION ONLY AFTER SUCCESSFUL START UP AND OPERATION OF NEW LIFT STATION.
8. CONTRACTOR SHALL REMOVE EXISTING METAL STAIRS, HAND RAILING, AND PLATFORM STRUCTURE.
9. CONTRACTOR SHALL INSTALL TEMPORARY SILT FENCING PRIOR TO ANY CONSTRUCTION.
10. CONTRACTOR SHALL INSTALL PROPOSED DOGHOUSE MANHOLE #F-1 AND ASSOCIATED PIPING FOLLOWING INSTALLATION OF PROPOSED LIFT STATION.

GENERAL NOTE:

1. ALL ITEMS SCHEDULED TO BE DISPOSED SHALL BE IN ACCORDANCE WITH ALL LOCAL, STATE AND FEDERAL REGULATIONS.
2. ALL CONSTRUCTION ACTIVITIES SHALL BE IN ACCORDANCE WITH THE CONSTRUCTION SEQUENCE OF EVENTS. SEE SPECIFICATION 011000.
3. CONTRACTOR SHALL ALLOW FOR POSITIVE DRAINAGE FROM PROPOSED LIFT STATION.
4. TEMPORARY BYPASS PUMPING ACTIVITIES SHALL BE IN ACCORDANCE WITH SECTION 333600.
5. CONTRACTOR SHALL FIELD VERIFY ALL DIMENSIONS REQUIRED FOR PRE-CAST STRUCTURES PRIOR TO ORDERING MATERIAL.
6. ALL PIPES ENTERING WET WELL SHALL HAVE INSIDE DROPS PER DROP BOWL AND BRACKET DETAILS INDICATED ON DETAIL SHEET.
7. THE CONSTRUCTION SURVEY STAKEOUT WILL BE PROVIDED BY THE ENGINEER AT THE BEGINNING OF THE PROJECT. IF ADDITIONAL SURVEY STAKEOUT IS REQUIRED, IT WILL BE PAID FOR BY THE CONTRACTOR.
8. ALL CONCRETE STRUCTURES TO BE DEMOLISHED SHALL HAVE WALL REMOVED 3" BELOW GRADE. CONTRACTOR SHALL CRACK EXISTING CONCRETE BOTTOM OF STRUCTURE AND BACKFILL 6" BELOW GRADE.

100 YEAR FLOOD ELEV. 623.0'

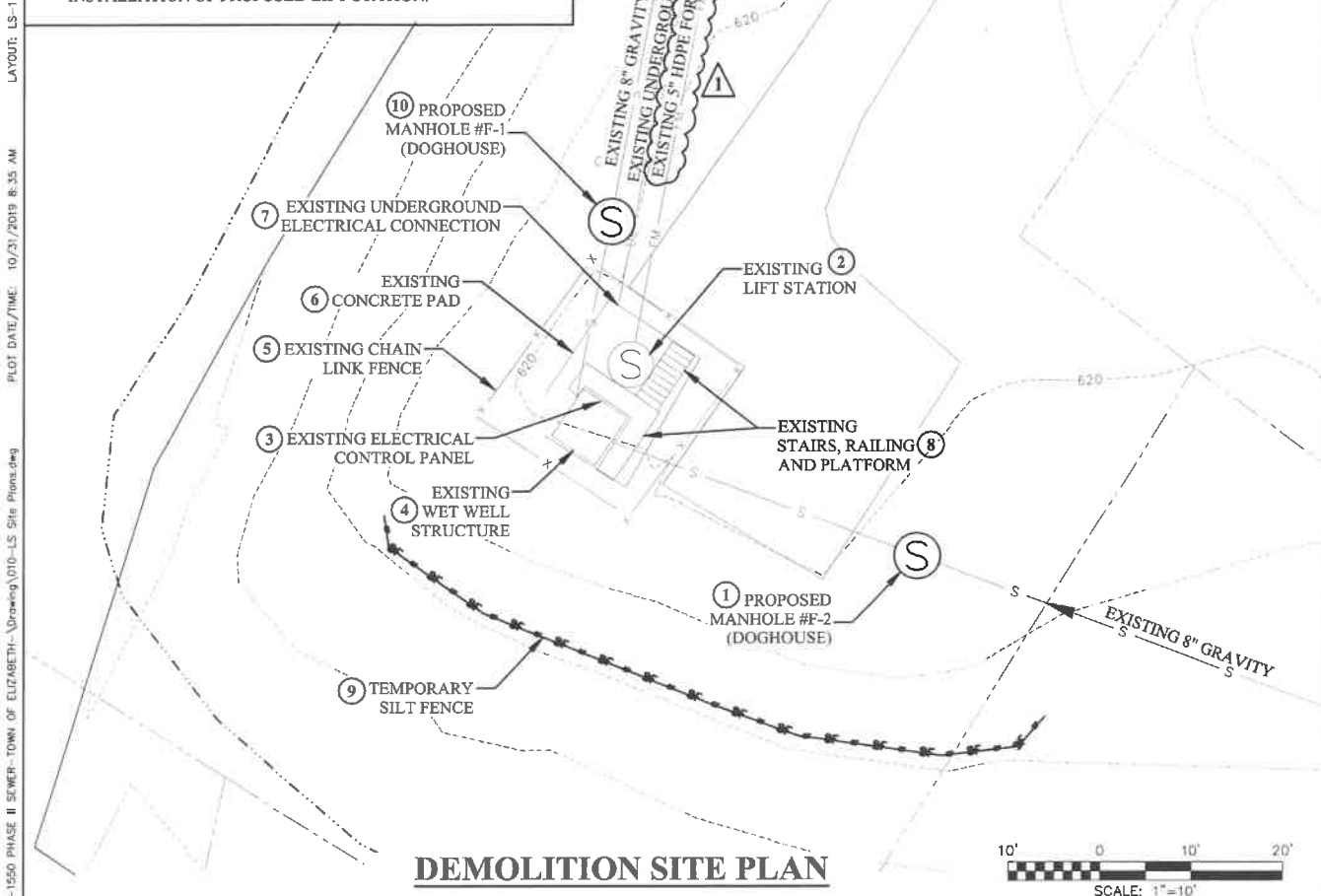

DEMOLITION SITE PLAN

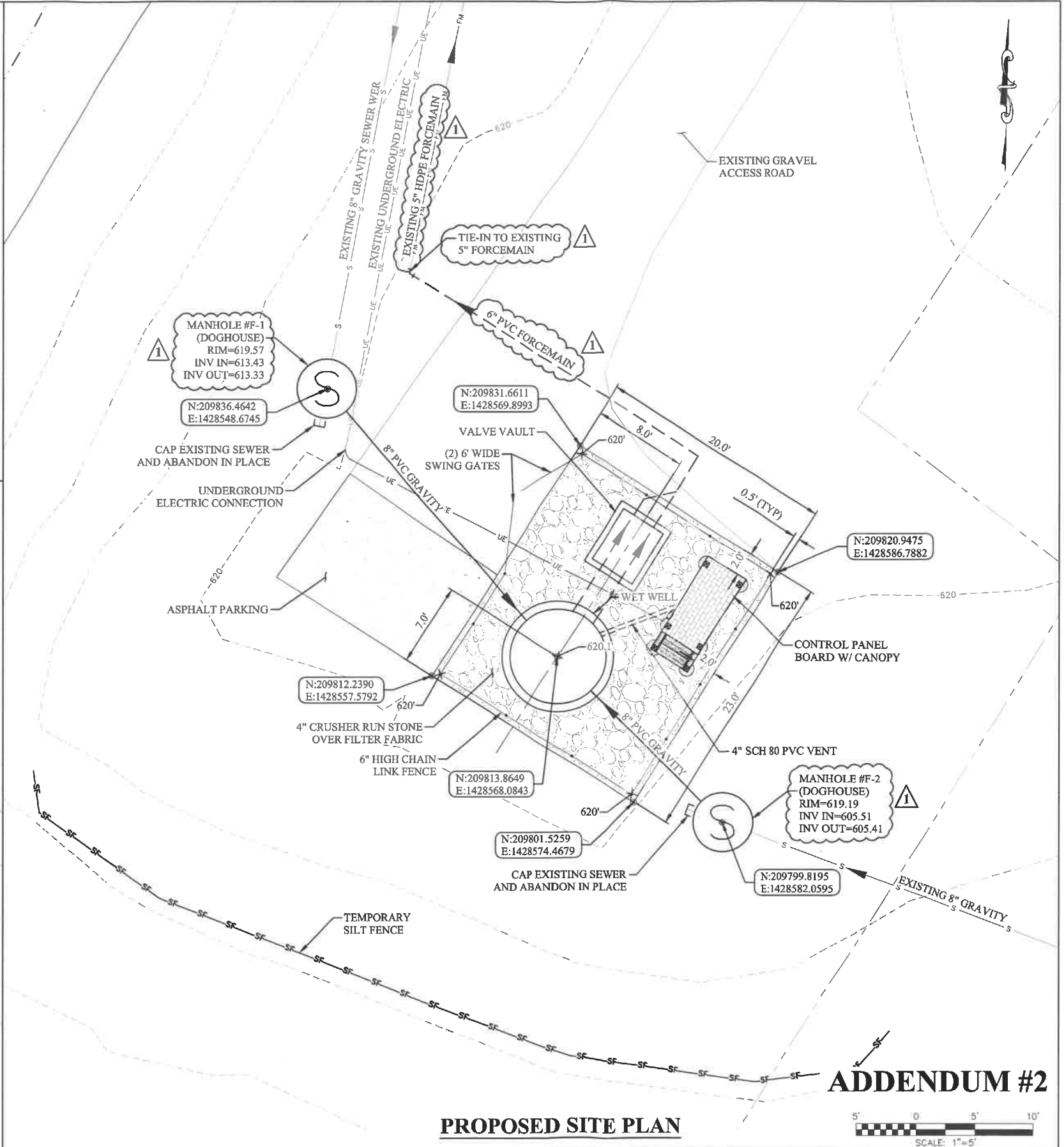

PROPOSED SITE PLAN

ADDENDUM #2

THE INFORMATION CONTAINED HEREIN IS THE SOLE PROPERTY OF THE THRASHER GROUP INC. REPRODUCTION OF THESE DOCUMENTS IN WHOLE OR IN PART, FOR ANY REASON WITHOUT PRIOR WRITTEN PERMISSION, IS STRICTLY PROHIBITED. COPYRIGHT © 2019 THE THRASHER GROUP INC.

NO.	BY	DATE	DESCRIPTION
1	JRF	11/01/19	ADDENDUM #2

SCALE: AS SHOWN
 DRAWN: J. FISHER DATE: 5/2016
 CHECKED: R. BOUSTANY DATE: 5/2016
 APPROVED: J. ALDEN DATE: 5/2016
 SURVEY DATE:
 SURVEY BY:
 FIELD BOOK No.:

THRASHER
 300 ASSOCIATION DRIVE
 CHARLESTON, WV 25311
 www.thrashereng.com
 PHONE (304)-343-7601
 FAX (304)-343-7604

PHASE No.	2
CONTRACT No.	1
PROJECT No.	020-1550

TOWN OF ELIZABETH
 WIRT COUNTY, WEST VIRGINIA
 SANITARY SEWER SYSTEM IMPROVEMENTS
 FRANKLIN STREET LIFT STATION
 SITE PLANS

SHEET No.
LS-1

USER: jason fibler
 PLOT DATE/TIME: 10/31/2019 8:35 AM
 LAYOUT: LS-1
 CADD FILE: R:\020-1550 PHASE II SEWER-TOWN OF ELIZABETH-Drawing\010-LS Site Plans.dwg

- KEY NOTES:**
- CONTRACTOR SHALL INSTALL PROPOSED DOGHOUSE MANHOLE #K-2 AND ASSOCIATED PIPING FOLLOWING INSTALLATION OF PROPOSED LIFT STATION.
 - CONTRACTOR SHALL REMOVE EXISTING LIFT STATION. SEE SHEET LS-5 FOR DETAILS.
 - CONTRACTOR SHALL REMOVE EXISTING ELECTRICAL CONTROL PANEL. OWNER SHALL HAVE THE OPPORTUNITY TO SALVAGE SELECT COMPONENTS PRIOR TO ANY DISPOSAL. SEE ELECTRICAL SHEETS FOR ADDITIONAL INFORMATION.
 - CONTRACTOR SHALL REMOVE EXISTING WET WELL STRUCTURE. SEE SHEET LS-5 FOR DETAILS.
 - CONTRACTOR SHALL REMOVE EXISTING CHAIN LINK FENCE.
 - CONTRACTOR SHALL DEMOLISH AND REMOVE EXISTING CONCRETE PAD.
 - CONTRACTOR SHALL REMOVE UNDERGROUND ELECTRIC CONNECTION ONLY AFTER SUCCESSFUL START UP AND OPERATION OF NEW LIFT STATION.
 - CONTRACTOR SHALL INSTALL TEMPORARY SILT FENCING PRIOR TO ANY CONSTRUCTION.
 - CONTRACTOR SHALL REMOVE BARB WIRE TOP ON EXISTING FENCE.
 - CONTRACTOR SHALL REMOVE EXISTING GENERATOR.
 - CONTRACTOR SHALL REMOVE EXISTING FUEL TANK.
 - CONTRACTOR SHALL INSTALL PROPOSED DOGHOUSE MANHOLE #K-1 AND ASSOCIATED PIPING FOLLOWING INSTALLATION OF PROPOSED LIFT STATION.

- GENERAL NOTE:**
- ALL ITEMS SCHEDULED TO BE DISPOSED SHALL BE IN ACCORDANCE WITH ALL LOCAL, STATE AND FEDERAL REGULATIONS.
 - ALL CONSTRUCTION ACTIVITIES SHALL BE IN ACCORDANCE WITH THE CONSTRUCTION SEQUENCE OF EVENTS. SEE SPECIFICATION 011000.
 - CONTRACTOR SHALL ALLOW FOR POSITIVE DRAINAGE FROM PROPOSED LIFT STATION.
 - TEMPORARY BYPASS PUMPING ACTIVITIES SHALL BE IN ACCORDANCE WITH SECTION 333600.
 - CONTRACTOR SHALL FIELD VERIFY ALL DIMENSIONS REQUIRED FOR PRE-CAST STRUCTURES PRIOR TO ORDERING.
 - ALL PIPES ENTERING WET WELL SHALL HAVE INSIDE DROPS PER DROP BOWL AND BRACKET DETAILS INDICATED ON DETAIL SHEET.
 - THE CONSTRUCTION SURVEY STAKEOUT WILL BE PROVIDED BY THE ENGINEER AT THE BEGINNING OF THE PROJECT. IF ADDITIONAL SURVEY STAKEOUT IS REQUIRED, IT WILL BE PAID FOR BY THE CONTRACTOR.
 - ALL CONCRETE STRUCTURES TO BE DEMOLISHED SHALL HAVE WALLS REMOVED 3' BELOW GRADE. CONTRACTOR SHALL CRACK EXISTING CONCRETE BOTTOM OF STRUCTURE AND BACKFILL W/ RUBBLE FILL.

100 YEAR FLOOD ELEV. 624.0'

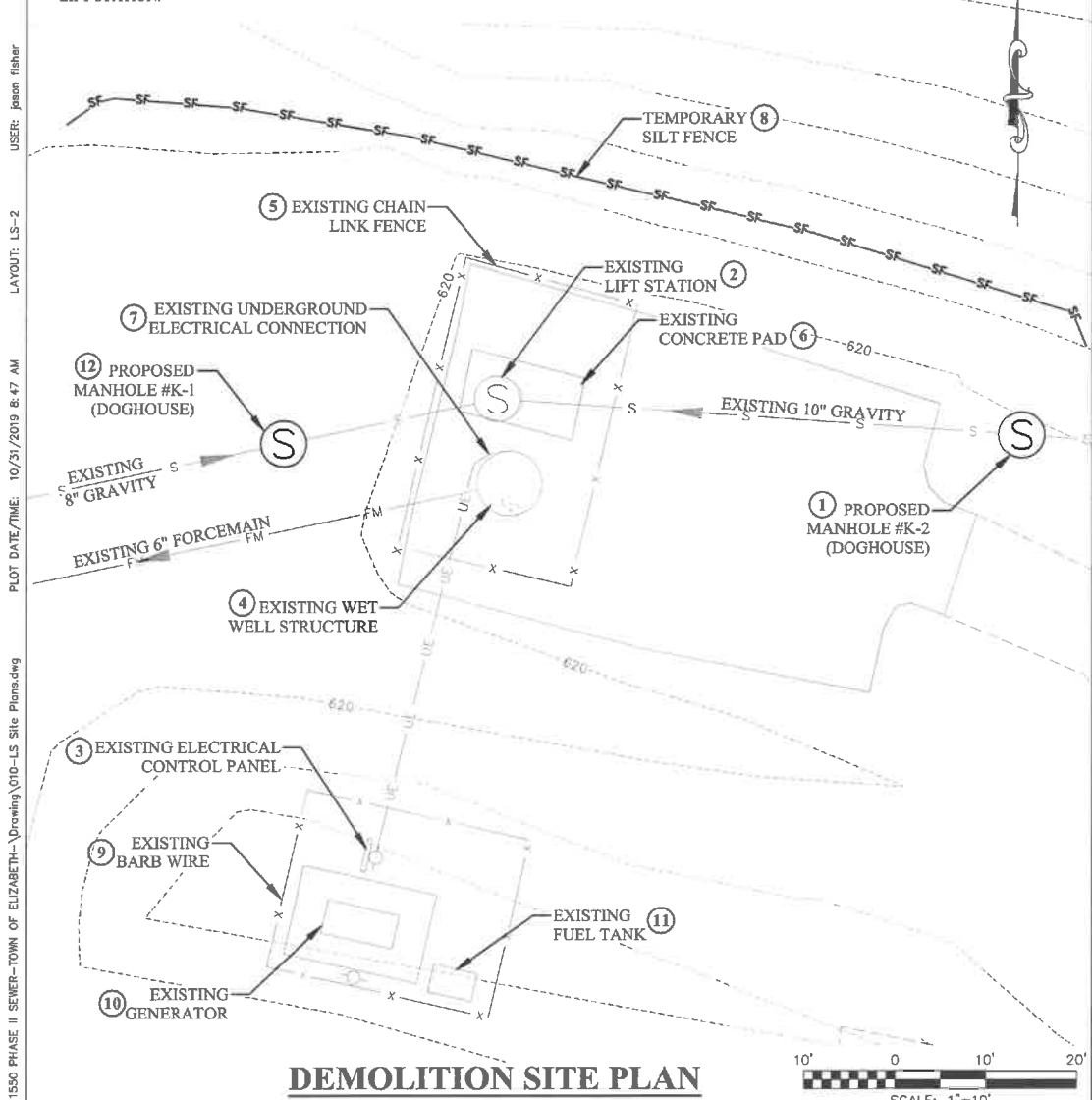

DEMOLITION SITE PLAN

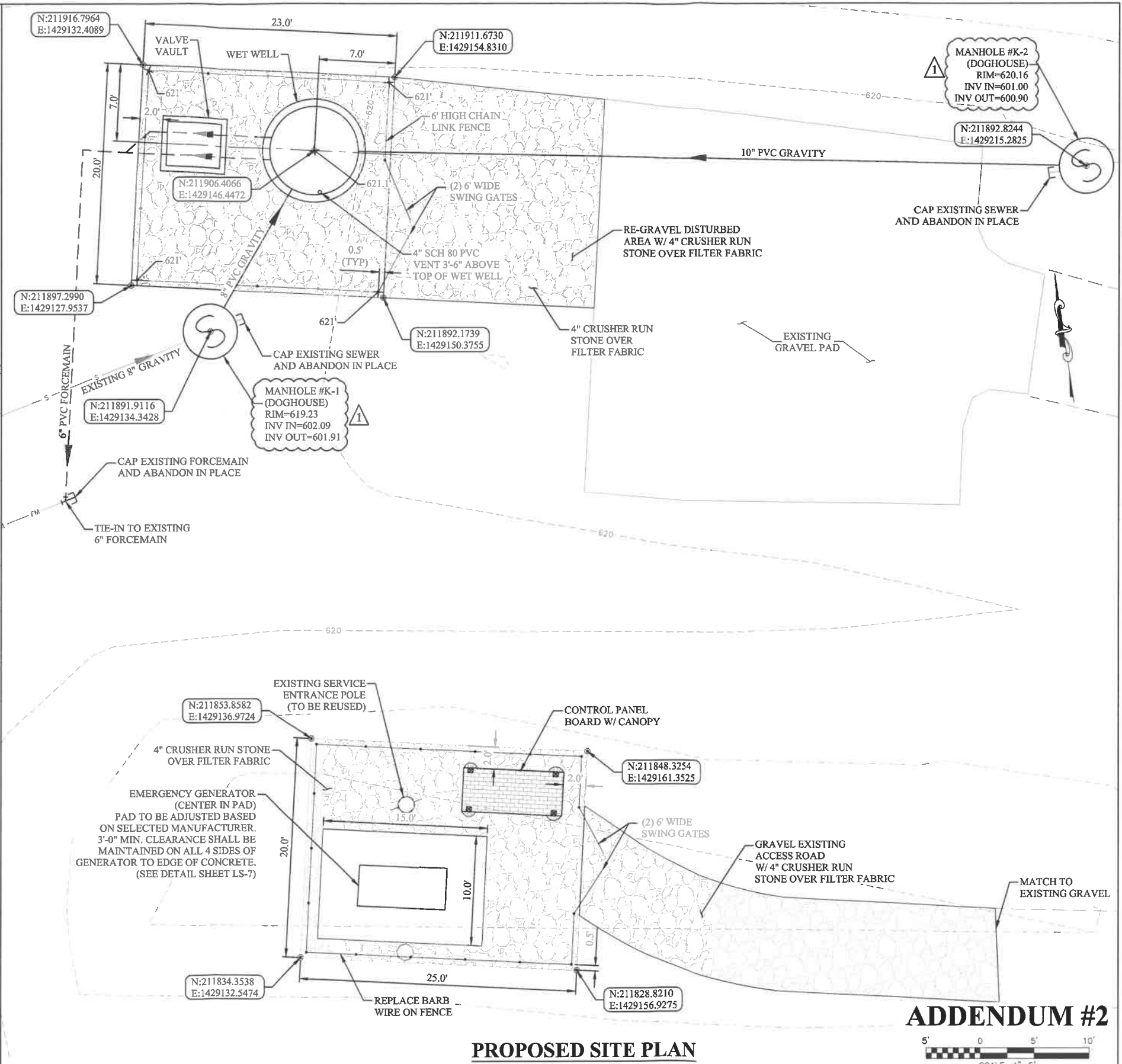

PROPOSED SITE PLAN



THE INFORMATION CONTAINED HEREIN IS THE SOLE PROPERTY OF THE THRASHER GROUP, INC. REPRODUCTION OF THESE DOCUMENTS IN WHOLE OR IN PART, FOR ANY REASON WITHOUT PRIOR WRITTEN PERMISSION, IS STRICTLY PROHIBITED. COPYRIGHT © 2019 THE THRASHER GROUP, INC.

NO.	BY	DATE	DESCRIPTION
1	JRF	11/01/19	ADDENDUM #2

SCALE:	AS SHOWN
DRAWN:	J. FISHER
DATE:	5/2018
CHECKED:	R. BOUSTANY
DATE:	5/2018
APPROVED:	J. ALDEN
DATE:	5/2018
SURVEY DATE:	
SURVEY BY:	
FIELD BOOK No.:	

THRASHER
 300 ASSOCIATION DRIVE
 CHARLESTON, WV 25311
 www.thrashereng.com
 PHONE (304)-343-7601 FAX (304)-343-7604

PHASE No.	2
CONTRACT No.	1
PROJECT No.	020-1550

TOWN OF ELIZABETH
 WIRT COUNTY, WEST VIRGINIA
 SANITARY SEWER SYSTEM IMPROVEMENTS
 LITTLE KANAWHA LIFT STATION
 SITE PLANS

SHEET No.
LS-2

ADDENDUM #2

USER: jman fisher LAYOUT: LS-2 PLOT DATE/TIME: 10/31/2019 8:47 AM CAD FILE: R:\020-1550 PHASE 1 SEWER-TOWN OF ELIZABETH-Drawing\010-LS Site Plans.dwg

"General Decision Number: WV20190051 10/11/2019

Superseded General Decision Number: WV20180051

State: West Virginia

Construction Type: Building

Counties: Wirt and Wood Counties in West Virginia.

Note: Under Executive Order (EO) 13658, an hourly minimum wage of \$10.60 for calendar year 2019 applies to all contracts subject to the Davis-Bacon Act for which the contract is awarded (and any solicitation was issued) on or after January 1, 2015. If this contract is covered by the EO, the contractor must pay all workers in any classification listed on this wage determination at least \$10.60 per hour (or the applicable wage rate listed on this wage determination, if it is higher) for all hours spent performing on the contract in calendar year 2019. If this contract is covered by the EO and a classification considered necessary for performance of work on the contract does not appear on this wage determination, the contractor must pay workers in that classification at least the wage rate determined through the conformance process set forth in 29 CFR 5.5(a)(1)(ii) (or the EO minimum wage rate, if it is higher than the conformed wage rate). The EO minimum wage rate will be adjusted annually. Please note that this EO applies to the above-mentioned types of contracts entered into by the federal government that are subject to the Davis-Bacon Act itself, but it does not apply to contracts subject only to the Davis-Bacon Related Acts, including those set forth at 29 CFR

5.1(a)(2)-(60). Additional information on contractor requirements and worker protections under the EO is available at www.dol.gov/whd/govcontracts.

Modification Number	Publication Date
0	01/04/2019
1	01/18/2019
2	01/25/2019
3	02/01/2019
4	02/22/2019
5	03/01/2019
6	06/14/2019
7	10/04/2019
8	10/11/2019

* ASBE0002-002 08/01/2019

	Rates	Fringes
ASBESTOS WORKER/HEAT & FROST INSULATOR.....	\$ 41.26	25.67

BOIL0667-005 03/01/2018

	Rates	Fringes
BOILERMAKER.....	\$ 39.38	23.77

BRWV0006-002 06/01/2018

	Rates	Fringes
BRICKLAYER.....	\$ 29.65	18.58

BRWV0009-007 12/01/2018

	Rates	Fringes
TILE SETTER.....	\$ 29.77	23.98

 BRWV0009-008 12/01/2018

	Rates	Fringes
MASON - STONE.....	\$ 29.77	23.98

 BRWV0015-014 06/01/2018

	Rates	Fringes
TILE FINISHER.....	\$ 23.59	19.95

 CARP0899-006 12/01/2017

	Rates	Fringes
CARPENTER (Including Drywall Hanging, Form Work and Floor Laying-Hardwood and Vinyl).....	\$ 28.15	20.21

 CARP1755-003 12/01/2016

	Rates	Fringes
MILLWRIGHT.....	\$ 33.95	21.75

 ELEC0968-008 06/01/2019

	Rates	Fringes
ELECTRICIAN.....	\$ 34.00	3%+17.20

 ENGI0132-011 12/01/2018

	Rates	Fringes
POWER EQUIPMENT OPERATOR:		
GROUP 1.....	\$ 39.56	19.20
GROUP 2.....	\$ 39.21	19.20
GROUP 3.....	\$ 38.21	19.20
GROUP 4.....	\$ 27.71	19.20

GROUP 1: All Friction Cranes, Tower Cranes and all Cranes with 180 ft. or more of boom including mast and jibs or lifting capacity of 100 tons or more and hoists with 30,000 pound line pull or more, Mechanics with tools with 3/4 inch drive and below

GROUP 2: Operating Cranes and Tower Cranes with a lifting capacity of 15 tons and over

GROUP 3: Backhoe, Bulldozer, Excavator, Forklift, Non-Farm Type Tractor, all other Cranes, all other Mechanics

GROUP 4: Bobcat/Skid Steer/Skid Loader, Farm Type Tractor, Loader

IRON0549-006 12/01/2018

	Rates	Fringes
IRONWORKER (Ornamental).....	\$ 33.34	20.81

IRON0787-006 12/01/2018

	Rates	Fringes
IRONWORKER (Reinforcing).....	\$ 33.14	21.55

LABO0379-019 12/01/2017

	Rates	Fringes
LABORER		
Wacker Roller Operator.....	\$ 26.17	16.50

LABO1085-005 06/01/2017

	Rates	Fringes
LABORER.....	\$ 22.76	16.85

LABORER CLASSIFICATIONS

Airtool Operator, Bobcat Operator (Clean up/Demolition),
 Carpenter Tender, Chipping Guns, Common or General,
 Concrete Saw (Hand Held/Walk Behind), Concrete Worker,
 Demolition, Fence Erection, Flagger, Grade Checker, Jack
 Hammer, Landscape, Mason Tender-Brick, Mason
 Tender-Cement/Concrete, Mortar Mixer, Power Tool Operator,
 Scaffold Builder (Brick and Masonry), Signal Man, Skytrak
 Forklift Operator, Tamper (Hand Held), Water Boy

PAIN0970-009 12/01/2018

	Rates	Fringes
PAINTER (Brush, Roller and Spray).....	\$ 27.82	18.50

PAIN1144-005 12/01/2018

	Rates	Fringes
PAINTER (Drywall		

Finishing/Taping).....\$ 26.83 17.55

PAIN1195-002 12/01/2018

Rates Fringes

GLAZIER.....\$ 30.75 12.24

PLAS0926-007 06/01/2018

Rates Fringes

CEMENT MASON/CONCRETE FINISHER...\$ 31.63 21.26

PLUM0565-002 07/01/2018

Rates Fringes

PIPEFITTER (Includes HVAC
Pipe Installation).....\$ 40.95 23.86

PLUM0565-004 07/01/2018

Rates Fringes

PLUMBER.....\$ 40.95 23.86

ROOF0034-003 05/01/2007

Rates Fringes

ROOFER.....\$ 19.35 7.75

SHEE0024-022 06/01/2015

Rates Fringes

SHEET METAL WORKER (Includes
 HVAC Duct Installation).....\$ 27.71 23.18

TEAM0175-005 10/01/2019

	Rates	Fringes
Truck drivers:		
GROUP 2.....	\$ 29.30	17.81
GROUP 3.....	\$ 29.45	17.81

TRUCK DRIVER CLASSIFICATIONS

GROUP 2 - Dump Truck (Up to 5 cu. yds.), Water Tank Truck
 (Straight)

GROUP 3 - Dump Truck (5 cu. yds. & over), Tractor Haul Truck,
 Water Tank Truck (Semi)

* UAVG-WV-0024 01/01/2019

	Rates	Fringes
LABORER (Chain Saw Operator).....	\$ 22.76	16.85
LABORER (Motorized Buggy Operator).....	\$ 22.76	16.85

SUWV2012-049 08/13/2012

	Rates	Fringes
IRONWORKER, STRUCTURAL.....	\$ 25.72	16.50

WELDERS - Receive rate prescribed for craft performing
 operation to which welding is incidental.

=====

Note: Executive Order (EO) 13706, Establishing Paid Sick Leave for Federal Contractors applies to all contracts subject to the Davis-Bacon Act for which the contract is awarded (and any solicitation was issued) on or after January 1, 2017. If this contract is covered by the EO, the contractor must provide employees with 1 hour of paid sick leave for every 30 hours they work, up to 56 hours of paid sick leave each year. Employees must be permitted to use paid sick leave for their own illness, injury or other health-related needs, including preventive care; to assist a family member (or person who is like family to the employee) who is ill, injured, or has other health-related needs, including preventive care; or for reasons resulting from, or to assist a family member (or person who is like family to the employee) who is a victim of, domestic violence, sexual assault, or stalking. Additional information on contractor requirements and worker protections under the EO is available at www.dol.gov/whd/govcontracts.

Unlisted classifications needed for work not included within the scope of the classifications listed may be added after award only as provided in the labor standards contract clauses (29CFR 5.5 (a) (1) (ii)).

The body of each wage determination lists the classification and wage rates that have been found to be prevailing for the cited type(s) of construction in the area covered by the wage determination. The classifications are listed in alphabetical order of ""identifiers"" that indicate whether the particular rate is a union rate (current union negotiated rate for local), a survey rate (weighted average rate) or a union average rate

(weighted union average rate).

Union Rate Identifiers

A four letter classification abbreviation identifier enclosed in dotted lines beginning with characters other than ""SU"" or ""UAVG"" denotes that the union classification and rate were prevailing for that classification in the survey. Example: PLUM0198-005 07/01/2014. PLUM is an abbreviation identifier of the union which prevailed in the survey for this classification, which in this example would be Plumbers. 0198 indicates the local union number or district council number where applicable, i.e., Plumbers Local 0198. The next number, 005 in the example, is an internal number used in processing the wage determination. 07/01/2014 is the effective date of the most current negotiated rate, which in this example is July 1, 2014.

Union prevailing wage rates are updated to reflect all rate changes in the collective bargaining agreement (CBA) governing this classification and rate.

Survey Rate Identifiers

Classifications listed under the ""SU"" identifier indicate that no one rate prevailed for this classification in the survey and the published rate is derived by computing a weighted average rate based on all the rates reported in the survey for that classification. As this weighted average rate includes all rates reported in the survey, it may include both union and non-union rates. Example: SULA2012-007 5/13/2014. SU indicates the rates are survey rates based on a weighted average calculation of rates and are not majority rates. LA indicates the State of Louisiana. 2012 is the year of survey on which these classifications and rates are based. The next number, 007 in the example, is an internal number used in producing the wage determination. 5/13/2014 indicates the survey completion

date for the classifications and rates under that identifier.

Survey wage rates are not updated and remain in effect until a new survey is conducted.

Union Average Rate Identifiers

Classification(s) listed under the UAVG identifier indicate that no single majority rate prevailed for those classifications; however, 100% of the data reported for the classifications was union data. EXAMPLE: UAVG-OH-0010 08/29/2014. UAVG indicates that the rate is a weighted union average rate. OH indicates the state. The next number, 0010 in the example, is an internal number used in producing the wage determination. 08/29/2014 indicates the survey completion date for the classifications and rates under that identifier.

A UAVG rate will be updated once a year, usually in January of each year, to reflect a weighted average of the current negotiated/CBA rate of the union locals from which the rate is based.

WAGE DETERMINATION APPEALS PROCESS

1.) Has there been an initial decision in the matter? This can be:

- * an existing published wage determination
- * a survey underlying a wage determination
- * a Wage and Hour Division letter setting forth a position on a wage determination matter
- * a conformance (additional classification and rate) ruling

On survey related matters, initial contact, including requests for summaries of surveys, should be with the Wage and Hour Regional Office for the area in which the survey was conducted because those Regional Offices have responsibility for the Davis-Bacon survey program. If the response from this initial contact is not satisfactory, then the process described in 2.) and 3.) should be followed.

With regard to any other matter not yet ripe for the formal process described here, initial contact should be with the Branch of Construction Wage Determinations. Write to:

Branch of Construction Wage Determinations
Wage and Hour Division
U.S. Department of Labor
200 Constitution Avenue, N.W.
Washington, DC 20210

2.) If the answer to the question in 1.) is yes, then an interested party (those affected by the action) can request review and reconsideration from the Wage and Hour Administrator (See 29 CFR Part 1.8 and 29 CFR Part 7). Write to:

Wage and Hour Administrator
U.S. Department of Labor
200 Constitution Avenue, N.W.
Washington, DC 20210

The request should be accompanied by a full statement of the interested party's position and by any information (wage payment data, project description, area practice material, etc.) that the requestor considers relevant to the issue.

3.) If the decision of the Administrator is not favorable, an interested party may appeal directly to the Administrative Review Board (formerly the Wage Appeals Board). Write to:

Administrative Review Board
U.S. Department of Labor
200 Constitution Avenue, N.W.
Washington, DC 20210

4.) All decisions by the Administrative Review Board are final.

=====

END OF GENERAL DECISION"

"General Decision Number: WV20190079 02/22/2019

Superseded General Decision Number: WV20180079

State: West Virginia

Construction Type: Heavy

Counties: Pleasants, Wirt and Wood Counties in West Virginia.

Note: Under Executive Order (EO) 13658, an hourly minimum wage of \$10.60 for calendar year 2019 applies to all contracts subject to the Davis-Bacon Act for which the contract is awarded (and any solicitation was issued) on or after January 1, 2015. If this contract is covered by the EO, the contractor must pay all workers in any classification listed on this wage determination at least \$10.60 per hour (or the applicable wage rate listed on this wage determination, if it is higher) for all hours spent performing on the contract in calendar year 2019. If this contract is covered by the EO and a classification considered necessary for performance of work on the contract does not appear on this wage determination, the contractor must pay workers in that classification at least the wage rate determined through the conformance process set forth in 29 CFR 5.5(a)(1)(ii) (or the EO minimum wage rate, if it is higher than the conformed wage rate). The EO minimum wage rate will be adjusted annually. Please note that this EO applies to the above-mentioned types of contracts entered into by the federal government that are subject to the Davis-Bacon Act itself, but it does not apply to contracts subject only to the

Davis-Bacon Related Acts, including those set forth at 29 CFR 5.1(a)(2)-(60). Additional information on contractor requirements and worker protections under the EO is available at www.dol.gov/whd/govcontracts.

Modification Number	Publication Date
0	01/04/2019
1	01/25/2019
2	02/01/2019
3	02/22/2019

ENGI0132-026 12/01/2018

	Rates	Fringes
POWER EQUIPMENT OPERATOR:		
GROUP 1.....	\$ 35.95	18.60
GROUP 2.....	\$ 33.19	18.60

POWER EQUIPMENT OPERATOR CLASSIFICATIONS

GROUP 1: Crane (Tower), Loaders of six (6) cubic yard capacity and over, Excavators and shovels with an operating weight of one hundred ten thousand (110,000) pounds and over.

GROUP 2: Loaders up to six (6) cubic yard capacity, Backhoe, Bulldozers, Compactor, Forklift, Grader/Blade, Mechanic, Excavators and shovels with an operating weight of up to one hundred ten thousand (110,000) pounds, Tractor, Trencher.

IRON0549-011 12/01/2015

Rates	Fringes
-------	---------

IRONWORKER, ORNAMENTAL.....\$ 35.40 23.24

* IRON0787-007 12/01/2018

Rates Fringes

IRONWORKER, REINFORCING.....\$ 30.48 21.55

LABO0379-038 12/01/2017

Rates Fringes

LABORER:

GROUP 1.....\$ 26.17 16.50

GROUP 2.....\$ 25.11 16.50

GROUP 1: Air Tool Operator, Asphalt Raker, Bobcat Operator (Clean up/Demolition), Bushhammer, Chain Saw, Concrete Saw (Hand Held/Walk Behind), Concrete Worker, Hand Held Drill, Grade Checker, Guardrail Installation, Mason Tender-Cement/Concrete, Pipelayer, Skytrak Forklift Operator

GROUP 2: Carpenter Tender, Common or General, Flagger, Landscape, Water Boy

* PAIN1144-006 12/01/2018

Rates Fringes

PAINTER: Spray.....\$ 29.84 17.55

PLAS0926-001 06/01/2018

Rates Fringes

CEMENT MASON/CONCRETE FINISHER...\$ 31.63 21.26

TEAM0175-006 12/07/2015

	Rates	Fringes
TRUCK DRIVER		
Flatbed Truck.....	\$ 30.98	15.98
Off the Road Truck.....	\$ 31.77	15.98
Tractor Haul Truck.....	\$ 31.77	15.98

* UAVG-WV-0021 01/01/2019

	Rates	Fringes
LABORER (Mason Tender - Brick)...	\$ 26.17	16.50
LABORER (Mortar Mixer).....	\$ 26.17	16.50

* UAVG-WV-0022 01/01/2019

	Rates	Fringes
POWER EQUIPMENT OPERATOR		
(Drill).....	\$ 32.19	18.30

SUWV2012-077 08/13/2012

	Rates	Fringes
CARPENTER, Includes Form Work....	\$ 31.13	3.00
ELECTRICIAN.....	\$ 28.70	17.12
IRONWORKER, STRUCTURAL.....	\$ 37.02	3.00
OPERATOR: Bobcat/Skid		
Steer/Skid Loader.....	\$ 21.49	13.15

OPERATOR: Boom.....	\$ 28.91	10.49
OPERATOR: Concrete Pump.....	\$ 26.79	9.35
OPERATOR: Crane.....	\$ 26.85	13.52
OPERATOR: Oiler.....	\$ 21.44	14.42
OPERATOR: Paver (Asphalt, Aggregate, and Concrete).....	\$ 24.39	15.50
OPERATOR: Roller.....	\$ 23.49	14.88
Truck Driver, Dump (Excluding Off the Road Trucks).....	\$ 22.34	13.31

WELDERS - Receive rate prescribed for craft performing operation to which welding is incidental.

=====

Note: Executive Order (EO) 13706, Establishing Paid Sick Leave for Federal Contractors applies to all contracts subject to the Davis-Bacon Act for which the contract is awarded (and any solicitation was issued) on or after January 1, 2017. If this contract is covered by the EO, the contractor must provide employees with 1 hour of paid sick leave for every 30 hours they work, up to 56 hours of paid sick leave each year. Employees must be permitted to use paid sick leave for their own illness, injury or other health-related needs, including preventive care; to assist a family member (or person who is like family to the employee) who is ill, injured, or has other health-related needs, including preventive care; or for reasons resulting from, or to assist a family member (or person who is like family to the employee) who is a victim of, domestic

violence, sexual assault, or stalking. Additional information on contractor requirements and worker protections under the EO is available at www.dol.gov/whd/govcontracts.

Unlisted classifications needed for work not included within the scope of the classifications listed may be added after award only as provided in the labor standards contract clauses (29CFR 5.5 (a) (1) (ii)).

The body of each wage determination lists the classification and wage rates that have been found to be prevailing for the cited type(s) of construction in the area covered by the wage determination. The classifications are listed in alphabetical order of ""identifiers"" that indicate whether the particular rate is a union rate (current union negotiated rate for local), a survey rate (weighted average rate) or a union average rate (weighted union average rate).

Union Rate Identifiers

A four letter classification abbreviation identifier enclosed in dotted lines beginning with characters other than ""SU"" or ""UAVG"" denotes that the union classification and rate were prevailing for that classification in the survey. Example: PLUM0198-005 07/01/2014. PLUM is an abbreviation identifier of the union which prevailed in the survey for this classification, which in this example would be Plumbers. 0198 indicates the local union number or district council number where applicable, i.e., Plumbers Local 0198. The next number, 005 in the example, is an internal number used in processing the wage determination. 07/01/2014 is the effective date of the most current negotiated rate, which in this example is July 1, 2014.

Union prevailing wage rates are updated to reflect all rate changes in the collective bargaining agreement (CBA) governing this classification and rate.

Survey Rate Identifiers

Classifications listed under the ""SU"" identifier indicate that no one rate prevailed for this classification in the survey and the published rate is derived by computing a weighted average rate based on all the rates reported in the survey for that classification. As this weighted average rate includes all rates reported in the survey, it may include both union and non-union rates. Example: SULA2012-007 5/13/2014. SU indicates the rates are survey rates based on a weighted average calculation of rates and are not majority rates. LA indicates the State of Louisiana. 2012 is the year of survey on which these classifications and rates are based. The next number, 007 in the example, is an internal number used in producing the wage determination. 5/13/2014 indicates the survey completion date for the classifications and rates under that identifier.

Survey wage rates are not updated and remain in effect until a new survey is conducted.

Union Average Rate Identifiers

Classification(s) listed under the UAVG identifier indicate that no single majority rate prevailed for those classifications; however, 100% of the data reported for the classifications was union data. EXAMPLE: UAVG-OH-0010 08/29/2014. UAVG indicates that the rate is a weighted union average rate. OH indicates the state. The next number, 0010 in the example, is an internal number used in producing the wage determination. 08/29/2014 indicates the survey completion date for the classifications and rates under that identifier.

A UAVG rate will be updated once a year, usually in January of each year, to reflect a weighted average of the current negotiated/CBA rate of the union locals from which the rate is based.

WAGE DETERMINATION APPEALS PROCESS

1.) Has there been an initial decision in the matter? This can be:

- * an existing published wage determination
- * a survey underlying a wage determination
- * a Wage and Hour Division letter setting forth a position on a wage determination matter
- * a conformance (additional classification and rate) ruling

On survey related matters, initial contact, including requests for summaries of surveys, should be with the Wage and Hour Regional Office for the area in which the survey was conducted because those Regional Offices have responsibility for the Davis-Bacon survey program. If the response from this initial contact is not satisfactory, then the process described in 2.) and 3.) should be followed.

With regard to any other matter not yet ripe for the formal process described here, initial contact should be with the Branch of Construction Wage Determinations. Write to:

Branch of Construction Wage Determinations
Wage and Hour Division
U.S. Department of Labor
200 Constitution Avenue, N.W.
Washington, DC 20210

2.) If the answer to the question in 1.) is yes, then an interested party (those affected by the action) can request review and reconsideration from the Wage and Hour Administrator (See 29 CFR Part 1.8 and 29 CFR Part 7). Write to:

Wage and Hour Administrator
U.S. Department of Labor
200 Constitution Avenue, N.W.
Washington, DC 20210

The request should be accompanied by a full statement of the interested party's position and by any information (wage payment data, project description, area practice material, etc.) that the requestor considers relevant to the issue.

3.) If the decision of the Administrator is not favorable, an interested party may appeal directly to the Administrative Review Board (formerly the Wage Appeals Board). Write to:

Administrative Review Board
U.S. Department of Labor
200 Constitution Avenue, N.W.
Washington, DC 20210

4.) All decisions by the Administrative Review Board are final.

=====

END OF GENERAL DECISION"

"General Decision Number: WV20190080 01/04/2019

Superseded General Decision Number: WV20180080

State: West Virginia

Construction Type: Highway

Counties: West Virginia Statewide.

HIGHWAY CONSTRUCTION PROJECTS (excluding tunnels, building structures in rest area projects & railroad construction; bascule, suspension & spandrel arch bridges designed for commercial navigation, bridges involving marine construction; and other major bridges).HIGHWAY CONSTRUCTION PROJECTS

Note: Under Executive Order (EO) 13658, an hourly minimum wage of \$10.60 for calendar year 2019 applies to all contracts subject to the Davis-Bacon Act for which the contract is awarded (and any solicitation was issued) on or after January 1, 2015. If this contract is covered by the EO, the contractor must pay all workers in any classification listed on this wage determination at least \$10.60 per hour (or the applicable wage rate listed on this wage determination, if it is higher) for all hours spent performing on the contract in calendar year 2019. If this contract is covered by the EO and a classification considered necessary for performance of work on the contract does not appear on this wage determination, the contractor must pay workers in that classification at least the wage rate determined through the conformance process set

forth in 29 CFR 5.5(a)(1)(ii) (or the EO minimum wage rate, if it is higher than the conformed wage rate). The EO minimum wage rate will be adjusted annually. Please note that this EO applies to the above-mentioned types of contracts entered into by the federal government that are subject to the Davis-Bacon Act itself, but it does not apply to contracts subject only to the Davis-Bacon Related Acts, including those set forth at 29 CFR 5.1(a)(2)-(60). Additional information on contractor requirements and worker protections under the EO is available at www.dol.gov/whd/govcontracts.

Modification Number	Publication Date
0	01/04/2019

SUWV2015-001 01/01/2014

Rates	Fringes
-------	---------

BRICKLAYER

Barbour, Berkeley,		
Doddridge, Gilmer, Grant,		
Hampshire, Hardy,		
Harrison, Jefferson,		
Lewis, Marion, Mineral,		
Monongalia, Morgan,		
Pendleton, Pocahontas,		
Preston, Randolph, Taylor,		
Tucker, Upshur, Webster.....\$	30.74	18.21
Boone, Braxton, Clay,		
Fayette, Greenbrier,		
Kanawha, Logan, McDowell,		
Mercer, Monroe, Nicholas,		
Putnam, Raleigh, Summers,		
Wyoming.....\$	29.66	20.20

Brooke, Hancock.....	\$ 29.94	16.22
Cabell, Lincoln, Mason,		
Mingo, Wayne.....	\$ 30.61	20.88
Calhoun, Jackson,		
Pleasants, Ritchie, Roane,		
Wirt, Wood.....	\$ 30.33	15.27
Marshall, Ohio, Tyler,		
Wetzel.....	\$ 30.01	16.26

CARPENTER

Berkeley, Grant,		
Hampshire, Hardy,		
Jefferson, Mineral,		
Morgan, Pendleton.....	\$ 31.26	15.90
Brooke, Hancock, Marshall,		
Ohio.....	\$ 27.86	19.30
Remaining Counties.....	\$ 27.72	19.44

CEMENT MASON/CONCRETE FINISHER

All Counties.....	\$ 28.67	18.85
-------------------	----------	-------

DIVER

Berkeley, Grant,		
Hampshire, Hardy,		
Jefferson, Mineral,		
Morgan, Pendleton		
Diver Tender.....	\$ 31.26	15.90
Diver.....	\$ 32.25	15.90
Brooke, Hancock, Marshall,		
Monongalia, Ohio, Wetzel		
Diver Tender.....	\$ 32.01	16.76
Diver.....	\$ 48.02	16.76
Remaining Counties		
Diver Tender.....	\$ 27.72	19.44
Diver.....	\$ 28.27	19.44

ELECTRICIAN (SIGNAL &

LIGHTING)

Equipment Operator.....	\$ 23.30	17.99
Flagger.....	\$ 17.00	7.39
Groundman/Truck Driver.....	\$ 20.79	17.89
Installer.....	\$ 26.21	18.11
Technician.....	\$ 29.12	18.22

ELECTRICIAN

Barbour, Doddridge, Harrison, Lewis, Marion, Monongalia, Pendleton, Pocahontas, Preston, Randolph, Taylor, Tucker, Upshur.....	\$ 30.14	21.14
Berkeley, Grant, Hampshire, Hardy, Jefferson, Mineral, Morgan..	\$ 30.50	15.78
Boone, Braxton, Calhoun, Clay, Fayette, Gilmer, Kanawha, Nicholas, Putnam, Raleigh, Roane, Summers, Webster, Wyoming.....	\$ 35.34	16.62
Brooke, Marshall, Ohio, Wetzel.....	\$ 28.35	22.74
Cabell, Lincoln, Logan, Mason, Mingo, Wayne.....	\$ 32.62	21.70
Greenbrier, McDowell, Mercer, Monroe.....	\$ 25.05	16.32
Hancock.....	\$ 34.00	29.10
Jackson, Pleasants, Ritchie, Tyler, Wirt, Wood..	\$ 31.56	21.43

IRONWORKER

Barbour, Brooke, Hancock, Harrison, Marion, Marshall, Monongalia, Ohio, Taylor, Tyler, Wetzel.	\$ 35.74	22.84
---	----------	-------

Berkeley, Grant,		
Hampshire, Hardy,		
Jefferson, Mineral,		
Morgan, Pendleton,		
Preston, Tucker.....	\$ 33.29	17.39
Boone, Braxton, Clay,		
Fayette, Kanawha, Lincoln,		
Logan, McDowell, Mingo,		
Nicholas, Putnam, Raleigh,		
Randolph, Webster, Wyoming..	\$ 34.87	19.50
Cabell, Wayne.....	\$ 33.89	21.98
Calhoun, Doddridge,		
Gilmer, Jackson, Lewis,		
Mason, Pleasants, Ritchie,		
Roane, Upshur, Wirt, Wood...\$	33.02	20.10
Greenbrier, Mercer,		
Monroe, Pocahontas, Summers.\$	35.43	16.13

LABORER

Class 1.....	\$ 26.95	16.30
Class 2.....	\$ 25.92	16.30
Class 3.....	\$ 24.86	16.30

LABORER CLASSIFICATIONS:

GROUP 1: Powderman, Laser Screed Operator, and GPS Operator.

GROUP 2: Pipelayer (Including Laser Beam Set Up), Form Setter (Road), Drill Operator, Air Tool Operator, Grade Checker and Asphalt Raker, Vibrator Man, Whacker, Chainsaw Operator, Mortarman, Brick Mason Tender, Cement Finisher Tender, Drill Tender, Powderman Tender, Water Proofer, Sheeter & Shorer, Placement of Lagging, Pipelayer Tender, Bull-Float Man, Pavement Reinforcing Placer, Handyman, Signal Man, Greencutter, Georgia Power Buggie, Burner, Cement Blower Man, Bituminous Hand Sprayer, Bork 250 Remote Control Ditch Witch and Walk Behind Concrete Saw, Mulcher and Seeder (hand and machine), Installation of Ground Mounted Beams and Signs

including Concrete Footers, Installation of Overhead Sign Supports and Signs including Concrete Footers, Installation of Guardrail and Anchors Assemblies, Tree Trimmer, Caisson Bottom Man, Bush Hammering, Core Drilling, Placement and Mixing of Grout and Bridge Demolition Specialist.**

GROUP 3: Flag Person, Traffic Control Maintenance Person, Carpenter's Tender, and General Laborer.

PAINTER

Barbour, Berkeley,		
Doddridge, Gilmer, Grant,		
Hampshire, Hardy,		
Harrison, Jefferson,		
Lewis, Marion, Mineral,		
Monongalia, Morgan,		
Pendleton, Preston,		
Randolph, Taylor, Tucker,		
Upshur, Webster.....\$ 31.87		14.20
Boone, Braxton, Cabell,		
Calhoun, Clay, Fayette,		
Greenbrier, Kanawha,		
Lincoln, Logan, Mason,		
McDowell, Mercer, Mingo,		
Monroe, Nicholas,		
Pocahontas, Putnam,		
Raleigh, Summers, Wayne,		
Wyoming.....\$ 32.05		14.30
Brooke, Hancock, Marshall,		
Ohio, Wetzel.....\$ 30.95		14.36
Jackson, Pleasants,		
Ritchie, Roane, Tyler,		
Wirt, Wood.....\$ 30.84		14.30

PILEDRIVERMAN

Berkeley, Grant,
Hampshire, Hardy,

Jefferson, Mineral,		
Morgan, Pendleton.....	\$ 32.25	15.90
Brooke, Hancock, Marshall,		
Monongalia, Ohio, Wetzel....	\$ 32.01	16.76
Remaining Counties.....	\$ 28.27	19.44

POWER EQUIPMENT OPERATOR:

Class 1.....	\$ 33.25	18.60
Class 2.....	\$ 30.49	18.60
Class 3.....	\$ 29.38	18.60
Class 4.....	\$ 25.92	18.60
Class 5A.....	\$ 26.04	18.60
Class 5B.....	\$ 28.64	18.60
Class 5C.....	\$ 26.94	18.60

POWER EQUIPMENT OPERATOR CLASSIFICATIONS:

GROUP 1: Cranes, tower cranes, derricks, derrick boats, draglines, clamshells, cableways, boom truck, loaders of 6 cubic yard capacity and over, excavators and shovels with an operating weight of 110,000 pounds and over.

GROUP 2: Loaders up to 6 cubic yard capacity, gradall, hoist 2 drums or more, mixer plant (2 or more mixers including batch control), pile driver operator, core drill, trencher, backhoe, asphalt paver, cement paver, rotary drill, bulldozers, concrete pump, controlled fine grade machine, slip form paver, log loader, log skidder, motor grader, rubber tired scraper, tractor pan, Roto Miller, tow or work boat, mobile conveyor, transloader, articulating equipment, material hauler, carry deck, compactor with blade, skidsteer including attachments, fork lift, self-propelled concrete spreader, concrete finishing machine, derrick (single drum), hoist (single drum), single drum paver, air tugger, Ross Carrier, multiple concrete saw, hydraulic post driver, horizontal road-boring machine, tie distributor, track lining machine, ballast tamper, anchor application machine, ribbon rail puller, ballast regulator, auto sled, turn table, pavement breaker, asphalt batch plant,

concrete batch plant, crushing plant, compactor with blade, power broom, vac-all truck, self-propelled concrete spreader and concrete finishing machine, mechanics with tools and greasers, excavators, and shovels with an operating weight of up to 110,000 pounds.

GROUP 3: Asphalt roller

GROUP 4: Air compressor, concrete mixer (under 1 cubic yard), light plant, mechanic's tender, assistant engineer, screedman, spreader box man, joint sealer and pump, steam jenny, stationary conveyor (belt or bucket), A-frame, tire man, screening and washing plant, form sub-grader, power form handling equipment, burlap and curing machine, form grader, bull float, bar and joint installing machine, roller and compactor, hydroblaster, concrete mixer (single drum, 1 cu. yd. or over), portable concrete saw and highway striping operator. Utility operators shall be paid Group 2 rate when operating 1 to 5 air compressors, pumps, stationary conveyors (belt or bucket), light plants, and gasoline or diesel powered welders and all farm type tractors.

GROUP 5A: Those operating off-road trucks in the following counties: Barbour, Braxton, Boone, Calhoun, Clay, Doddridge, Fayette, Gilmer, Greenbrier, Harrison, Jackson, Kanawha, Lewis, Marion, Mercer, McDowell, Monongalia, Monroe, Nicholas, Pleasants, Pocohontas, Preston, Putnam, Raleigh, Randolph, Roane, Ritchie, Summers, Taylor, Tucker, Tyler, Upshur, Webster, Wirt, Wood, and Wyoming.

GROUP 5B: Those operating off-road trucks in the following counties: Cabell, Lincoln, Logan, Mason, Mingo, and Wayne.

GROUP 5C: Those operating off-road trucks in the following counties: Berkeley, Grant, Hampshire, Hardy, Jefferson, Mineral, Morgan and Pendleton.

FOOTNOTE: \$2.00 per hour shall be added to the Group 1 rate for individuals operating a lattice boom crane with a fixed boom of 150 feet or more. \$0.25 per hour shall be added to all of the above schedules for underground work.

TRUCK DRIVER

Berkeley, Grant,		
Hampshire, Hardy,		
Jefferson, Mineral,		
Morgan, Pendleton		
Class 1.....	\$ 25.72	18.11
Class 2.....	\$ 26.61	18.11
Class 3.....	\$ 27.38	18.11
Brooke, Hancock		
Class 1.....	\$ 29.17	13.86
Class 2.....	\$ 30.92	13.86
Class 3.....	\$ 31.71	13.86
Cabell, Lincoln, Logan,		
Mason, Mingo, Wayne		
Class 1.....	\$ 29.79	15.60
Class 2.....	\$ 30.76	15.60
Class 3.....	\$ 31.55	15.60
Marshall, Ohio, Wetzel		
Class 1.....	\$ 26.26	16.81
Class 2.....	\$ 27.16	16.81
Class 3.....	\$ 27.76	16.81
Remaining Counties		
Class 1.....	\$ 26.97	16.15
Class 2.....	\$ 27.76	16.15
Class 3.....	\$ 28.44	16.15

TRUCK DRIVER CLASSIFICATIONS:

GROUP 1: Single Axle Trucks used as Dumps, Supply, Fuel, Water, Van, Flatbody, Monorail, Distributor (other than Bituminous Distributors) including Towed Single Units, Material Checkers and Receivers, Greasers, Tireman and Mechanic Tenders (Trucks), Warehouse, Yardmen and Pick-up

trucks.

GROUP 2: Tandem and Tri-Axle Trucks used as Dumps, Supply, Fuel, Water, Van, Flatbody, Monorail and including Towed Single Units, Truck Tractors used in combination with Dump, Van, Tank, Flatbed, Low platform or Pole Trailers, Bituminous Distributors, Agitator or Mixer Trucks (up to 20 cubic-yards), Rubber-tired tractors (towing and pushing), Drag and Tag-alongs.

GROUP 3: Mobile Metered Mixer, Agitator or Mixer Trucks (over 20 cubic yards), & Mechanic Truck.

A. Double Hitch equipment operated by 1 driver shall pay 50% more than the wages set out above.

B. \$0.25 per hour shall be added for tunneling and all other underground work.

WELDERS - Receive rate prescribed for craft performing operation to which welding is incidental.

=====

Note: Executive Order (EO) 13706, Establishing Paid Sick Leave for Federal Contractors applies to all contracts subject to the Davis-Bacon Act for which the contract is awarded (and any solicitation was issued) on or after January 1, 2017. If this contract is covered by the EO, the contractor must provide employees with 1 hour of paid sick leave for every 30 hours they work, up to 56 hours of paid sick leave each year. Employees must be permitted to use paid sick leave for their own illness, injury or other health-related needs, including preventive care; to assist a family member (or person who is like family to the employee) who is ill, injured, or has other health-related needs, including preventive care; or for reasons

resulting from, or to assist a family member (or person who is like family to the employee) who is a victim of, domestic violence, sexual assault, or stalking. Additional information on contractor requirements and worker protections under the EO is available at www.dol.gov/whd/govcontracts.

Unlisted classifications needed for work not included within the scope of the classifications listed may be added after award only as provided in the labor standards contract clauses (29CFR 5.5 (a) (1) (ii)).

The body of each wage determination lists the classification and wage rates that have been found to be prevailing for the cited type(s) of construction in the area covered by the wage determination. The classifications are listed in alphabetical order of ""identifiers"" that indicate whether the particular rate is a union rate (current union negotiated rate for local), a survey rate (weighted average rate) or a union average rate (weighted union average rate).

Union Rate Identifiers

A four letter classification abbreviation identifier enclosed in dotted lines beginning with characters other than ""SU"" or ""UAVG"" denotes that the union classification and rate were prevailing for that classification in the survey. Example: PLUM0198-005 07/01/2014. PLUM is an abbreviation identifier of the union which prevailed in the survey for this classification, which in this example would be Plumbers. 0198 indicates the local union number or district council number where applicable, i.e., Plumbers Local 0198. The next number, 005 in the example, is an internal number used in processing the wage determination. 07/01/2014 is the effective date of the

most current negotiated rate, which in this example is July 1, 2014.

Union prevailing wage rates are updated to reflect all rate changes in the collective bargaining agreement (CBA) governing this classification and rate.

Survey Rate Identifiers

Classifications listed under the ""SU"" identifier indicate that no one rate prevailed for this classification in the survey and the published rate is derived by computing a weighted average rate based on all the rates reported in the survey for that classification. As this weighted average rate includes all rates reported in the survey, it may include both union and non-union rates. Example: SULA2012-007 5/13/2014. SU indicates the rates are survey rates based on a weighted average calculation of rates and are not majority rates. LA indicates the State of Louisiana. 2012 is the year of survey on which these classifications and rates are based. The next number, 007 in the example, is an internal number used in producing the wage determination. 5/13/2014 indicates the survey completion date for the classifications and rates under that identifier.

Survey wage rates are not updated and remain in effect until a new survey is conducted.

Union Average Rate Identifiers

Classification(s) listed under the UAVG identifier indicate that no single majority rate prevailed for those classifications; however, 100% of the data reported for the classifications was union data. EXAMPLE: UAVG-OH-0010 08/29/2014. UAVG indicates that the rate is a weighted union average rate. OH indicates the state. The next number, 0010 in the example, is an internal number used in producing the wage determination. 08/29/2014 indicates the survey completion date

for the classifications and rates under that identifier.

A UAVG rate will be updated once a year, usually in January of each year, to reflect a weighted average of the current negotiated/CBA rate of the union locals from which the rate is based.

WAGE DETERMINATION APPEALS PROCESS

1.) Has there been an initial decision in the matter? This can be:

- * an existing published wage determination
- * a survey underlying a wage determination
- * a Wage and Hour Division letter setting forth a position on a wage determination matter
- * a conformance (additional classification and rate) ruling

On survey related matters, initial contact, including requests for summaries of surveys, should be with the Wage and Hour Regional Office for the area in which the survey was conducted because those Regional Offices have responsibility for the Davis-Bacon survey program. If the response from this initial contact is not satisfactory, then the process described in 2.) and 3.) should be followed.

With regard to any other matter not yet ripe for the formal process described here, initial contact should be with the Branch of Construction Wage Determinations. Write to:

Branch of Construction Wage Determinations
Wage and Hour Division
U.S. Department of Labor

200 Constitution Avenue, N.W.
Washington, DC 20210

2.) If the answer to the question in 1.) is yes, then an interested party (those affected by the action) can request review and reconsideration from the Wage and Hour Administrator (See 29 CFR Part 1.8 and 29 CFR Part 7). Write to:

Wage and Hour Administrator
U.S. Department of Labor
200 Constitution Avenue, N.W.
Washington, DC 20210

The request should be accompanied by a full statement of the interested party's position and by any information (wage payment data, project description, area practice material, etc.) that the requestor considers relevant to the issue.

3.) If the decision of the Administrator is not favorable, an interested party may appeal directly to the Administrative Review Board (formerly the Wage Appeals Board). Write to:

Administrative Review Board
U.S. Department of Labor
200 Constitution Avenue, N.W.
Washington, DC 20210

4.) All decisions by the Administrative Review Board are final.

=====

END OF GENERAL DECISION

"